

WWI MILITARY MINIATURES SERIES

# BRITISH B-TYPE ARMOURED LORRY

39006



## GENERAL INSTRUCTION

HIGHLY DETAILED MODEL

ACCURATE ENGINE

CLEAR PARTS INCLUDED

PHOTO-ETCHED PARTS  
INCLUDED

DECAL SHEET  
INCLUDED

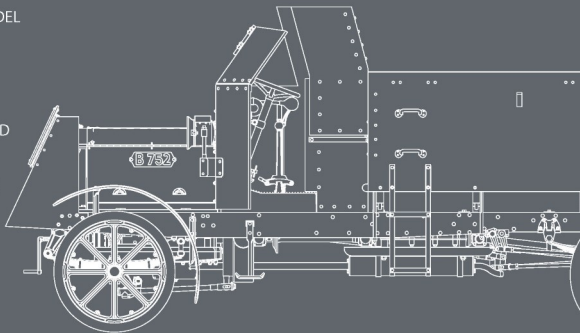

SCALE  
**1:35**

MiniArt

**UWAGA**

Przy stosowaniu kleju i farb wszystkie prace należy wykonywać w przewiewnym miejscu z dala od źródeł ognia.  
Odzież części od wiewłoków nożami lub innym ciętym narzędziem. Oczyścić lampę błyskową i wyznaczyć punkty przerwaniem igłowym i papier ścierny. Złóż modele zgodnie z schemat montażu.  
Dla ułatwienia montażu każda część jest oznaczona numerem. Po złożeniu zestawu mogą pozostać niewykorzystane części.

**CAUTION**

When you use glue or paint, do not use near open flame, and use in well ventilated room. When you take parts off from the runner frame, use modeling scissors or cutter.  
See the bottom of this column for the meaning of symbols.  
Extra details can remain after assembling of the kit.

**УВАГА**

При використанні клею та фарб всі роботи проводити надалі від джерел вогню у ввієтрянні, що добре провітрянні.  
Деталі відкривати від отриманих ножами або іншими різними інструментами. Завчасно обробити і зачистити зорю за допомогою наждаку та наждачного паперу. Збирати моделі виконувати згідно зі схемою. Для зручності побудови кожного деталі позначена номером.  
Після складання можуть залишитися невикористані деталі.

**ATTENZIONE**

Non usare colla e vernice vicino a fiamme scoposte, e aprire le finestre al tanto in tempo per cambiare l'aria. Quando si staccano parti del carrello, usare forbici da modellismo e eliminare la plastica in eccesso con un coltello o una lima. Vedere in fondo a questa colonna per il signifi. Dopo l'assemblaggio possono rimanere parti inutilizzate.

**ATTENTION**

Ne pas utiliser de colle ou de peinture a proximité d'une flamme nue, et aérer la pièce de temps en temps.  
Pour retirer les pièces hors du cadre, utiliser des ciseaux spéciaux pour maquette la plastique en excès avec un cutter ou une lime.  
Vor la fin de cette colonne pour la signification des symboles.  
Après l'assemblage peut rester des pièces inutilisées.

**ZUR BEACHTUNG**

Kleber und Farbe nicht nahe von offenem Feuer verwenden und das Fenster von Zeit zu Zeit zur Belüftung öffnen.  
Zum Abschneiden der Teile vom Verbundstück eine Modellierschere verwenden und die Überstehenden Plastikteile mit einem Messer oder einer Feile beseitigen.  
Die Bedeutung der Symbole finden Sie unten in dieser Nach dem Zusammenbau des Modells, können einzelne Teile übrig bleiben

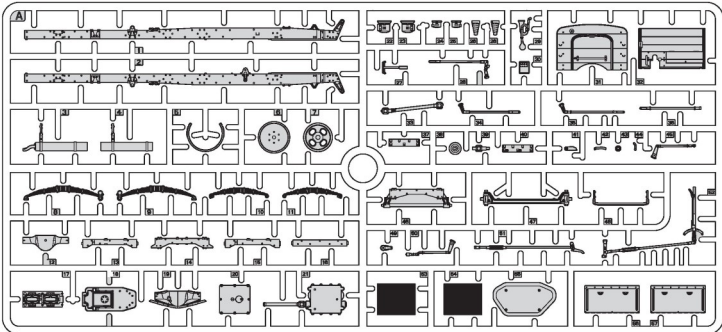
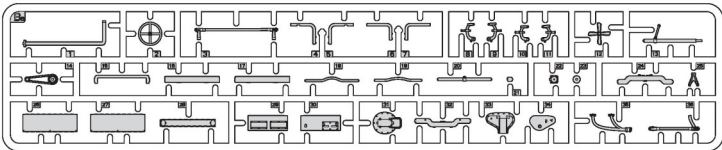
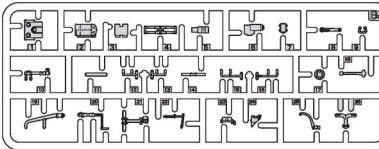
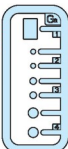
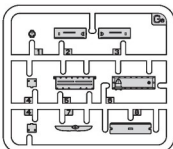
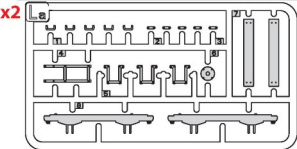
**PARTS****A****Ba****Bc****Ga (Clear parts)****Ge****La x2****Decal**

**MiniArt** 39006 B-Type Armoured Lorry  
SCALE 1:35 B 752 2 B 752 B 752 3 B 752  
1 **RN RN RN RN RN**

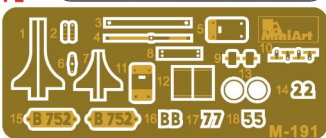
**PE****COLOR CHART**

No	Color	Vallejo	Mr. Color	AK RC	RC	Mission Models	AMMO MIG	Tamiya	Color name
01		71.062	C-090	AK-020	RC-020	MMM-008	A.MIG-0104	XF-16	Aluminum
02		71.073	C-078	RC-015	RC-015	MMM-001	A.MIG-0045	XF-84	Gun Metal
03		71.057	C-023	RC-001	RC-001	MMP-047	A.MIG-0046	XF-01	Black
04		71.001	C-062	RC-004	RC-004	MMP-001	A.MIG-0050	XF-02	White
05		71.068	C-010	RC-016	RC-016	MMM-004	A.MIG-0199	XF-06	Copper
06		71.069	C-131	AK-709	RC-015	MMW-001	A.MIG-0041	XF-10	Rust
07		71.041	C-310	RC-035	RC-035	MMP-033	A.MIG-0076	XF-10	Brown
08		71.051	C-013	RC-249	RC-249	MMP-072	A.MIG-0059	XF-75	Grey
09		71.251	C-137	RC-022	RC-022	MMP-040	A.MIG-0033	XF-85	Tire Black



POWTOREĆ DWA RAZY  
MAKE 2x  
2 TÖÖL: PÄÄTÄÄ  
EFFECTUËL 2 PICES  
FAIRE 2x LE PIÈCE  
TEL 2 XPL  
DWA TÖÖ  
КРАТКАСТЬ РАЗВ  
НЕ КРЕПТИ

НЕ ЛІСТАТИ КІСЛІ  
DO NOT CLIMB  
NICHY KI SEBEN  
NE PAS COLLER  
NON MOUILLER  
ELIMAA  
LIMAAKI  
НЕ КРЕПТИ

ОПИС  
OPTICAL  
NACH BELIEBEN  
FACILITATIF  
FACILITATIF  
VALINNANVARANNEN  
VALINN  
SARJAN-TILA

ЗВЕРНІТЬ УВАГУ  
OPEN HOLE  
OFNEN  
PANE UN TROU  
FOND APERTO  
ALMA REIRA  
OFNEN VALLET  
SPROBITI OTVER

PODSAC  
PŁASZCZYŃ  
ENTWEIFEN  
NETZMADE  
BEWAHRE  
POBIEZ  
ALJASNA  
VDRZATI

ZANÉY SÉKTÖRÖV  
ANNAI, THE PART  
GÖZÖRÖSSÉGI  
PARTIE DE RECUIF  
PARTIE RECOSSA  
HÍSHÜTTÄ OSA  
VÄDRÄTTA DETALJ

ZONAC  
BITE  
BITE BISSEN  
PLUSER 3xL VOUS PLAIT  
PREARE  
TAIJA  
KOSKA  
VIRTÖTÄ

ZON TO BAK  
SONACHBUILD  
AM MISTEN ZU MACHEN  
FAIRE LE PLUS  
RENCHIT  
TIE IT SE  
GÖR DIE WÄLL  
SPROBITI SAMÖV

## PARTS

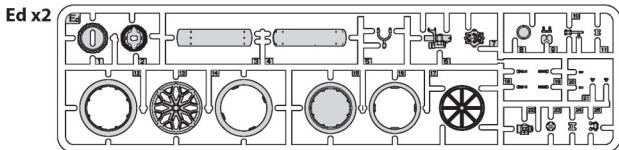
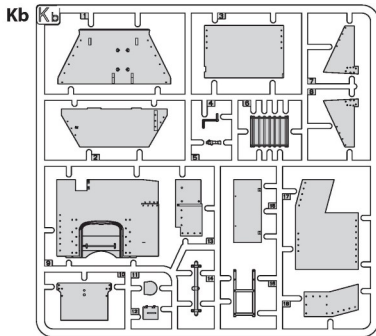
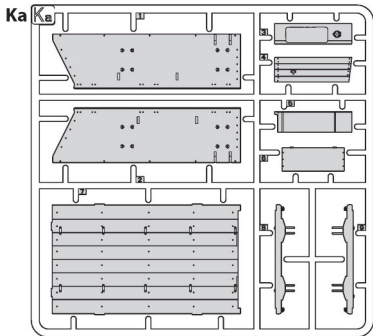

## INSTRUCTION

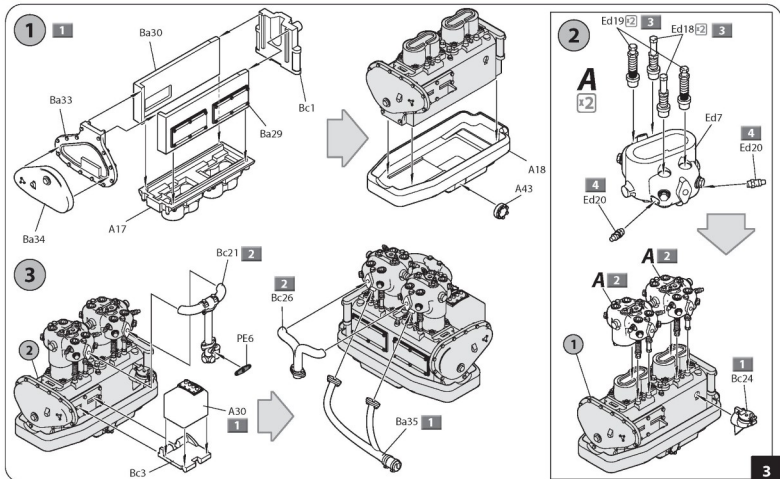

4

PE10  
For advanced modelers

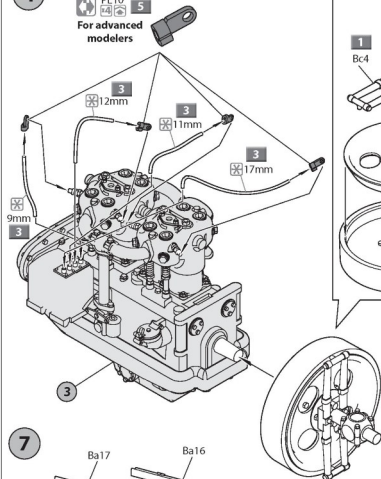

5

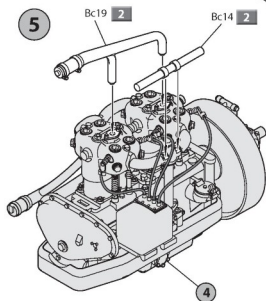

7

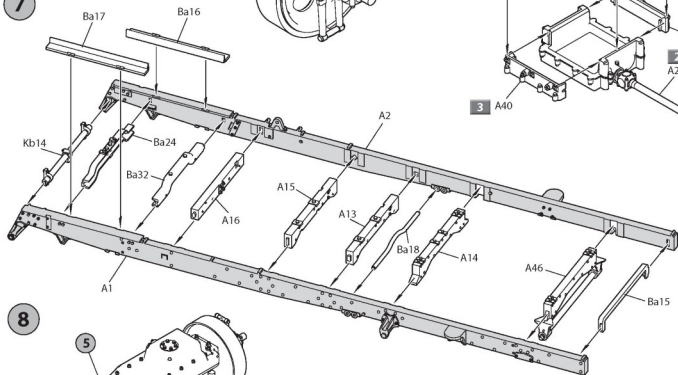

8

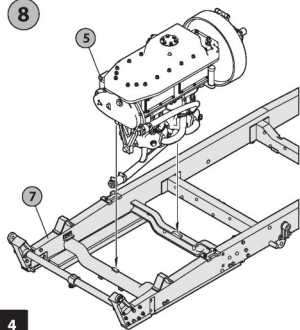

9

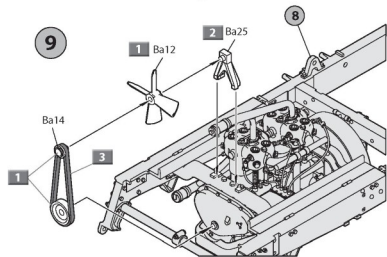

4

10 x2

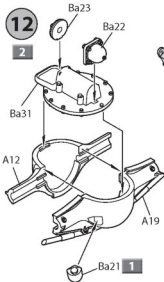
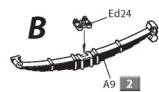
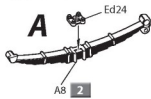

11

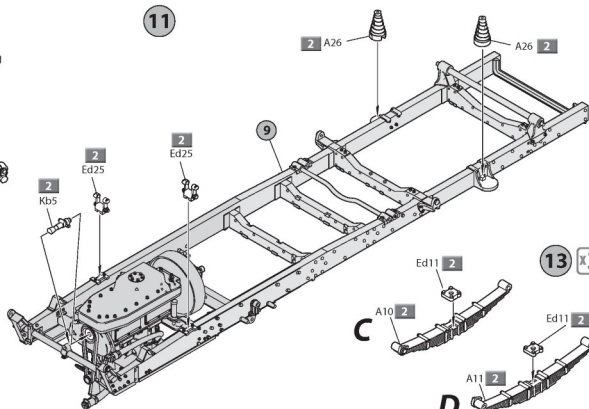

13 x2

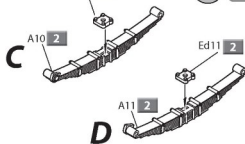

14

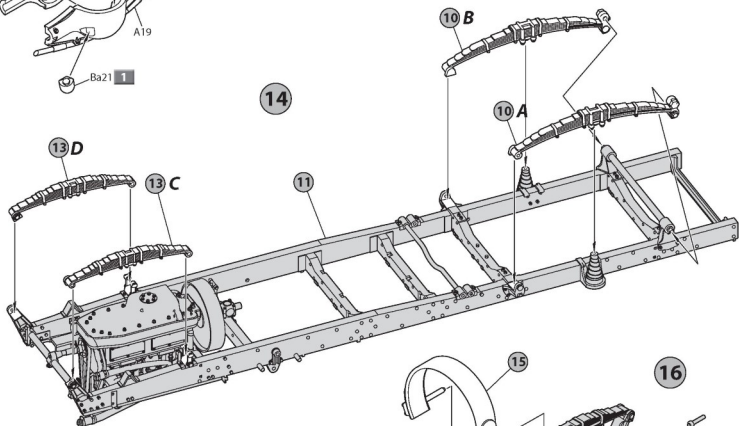

15

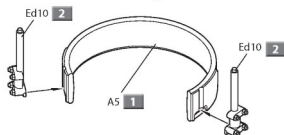

16

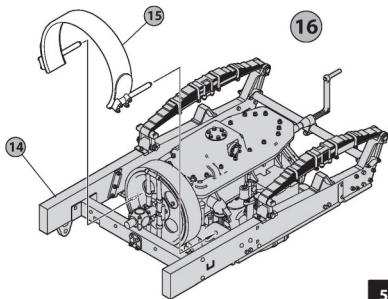

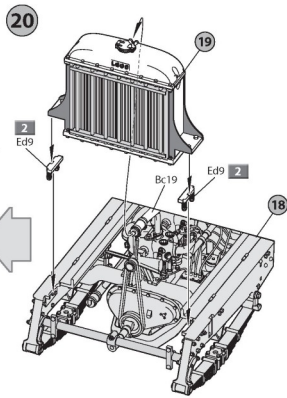
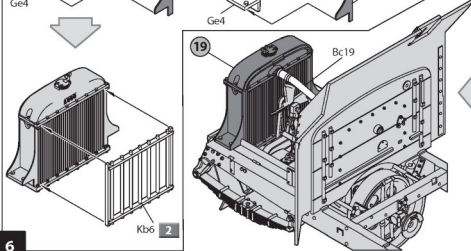
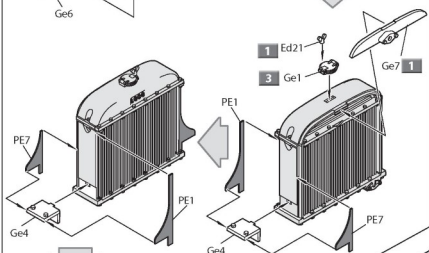
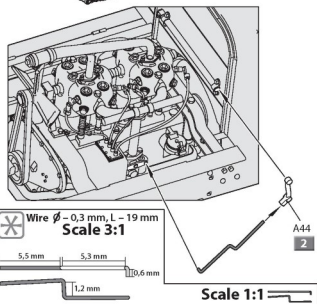
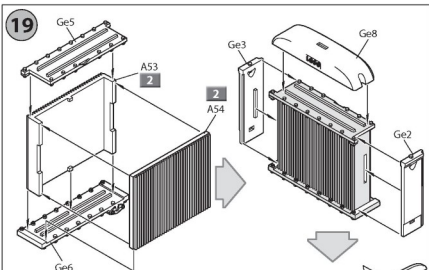
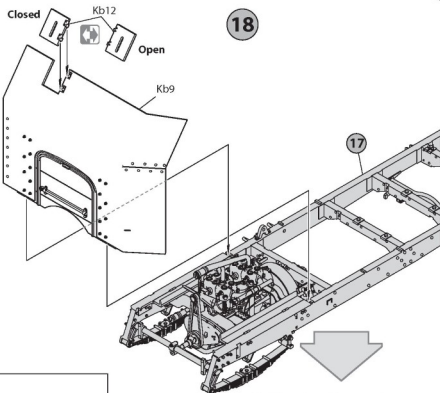
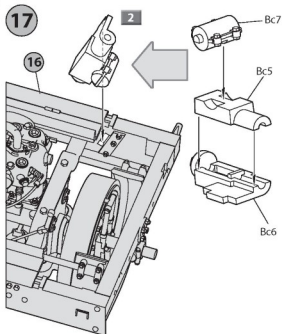



21

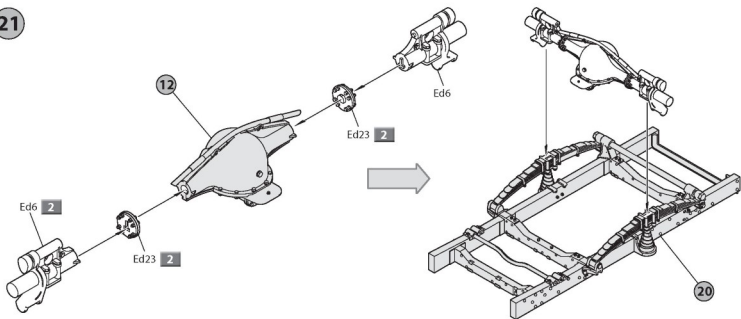

22

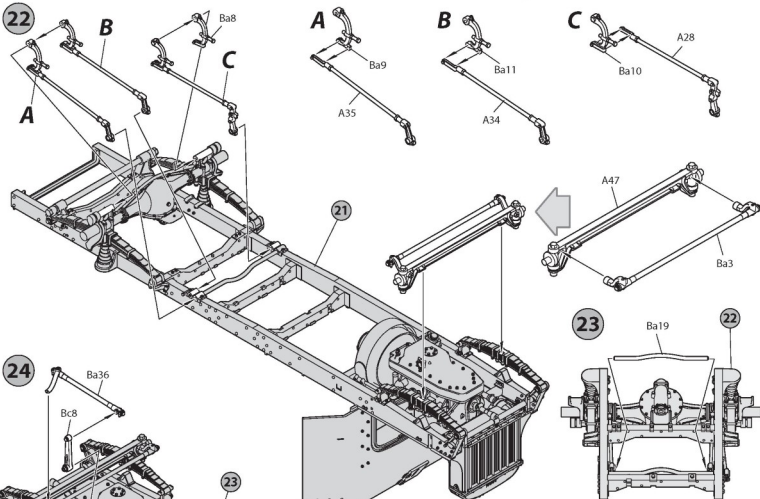

24

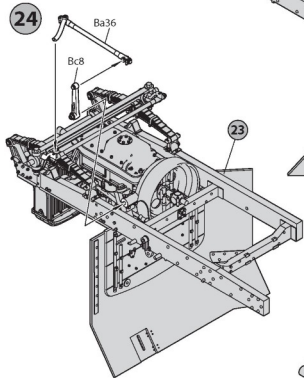

25

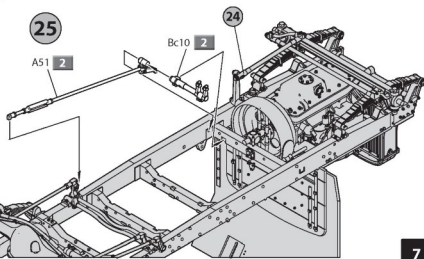

26

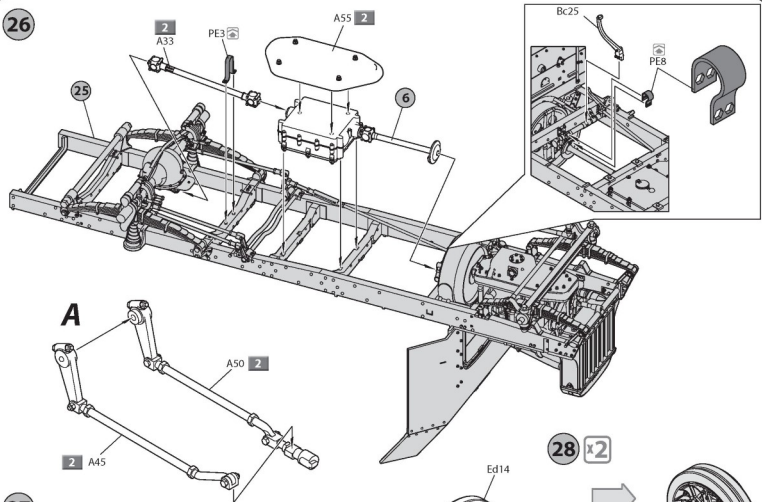

27

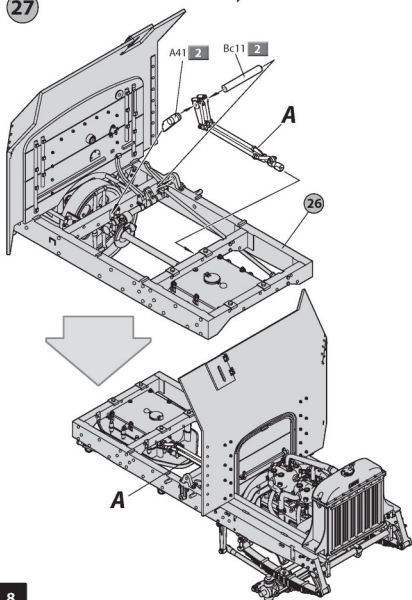

28 x2

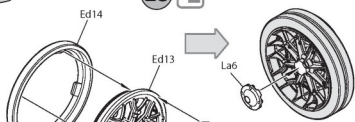

29 x2

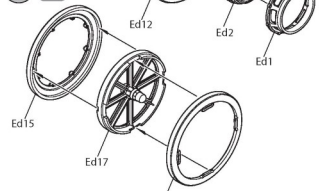

30

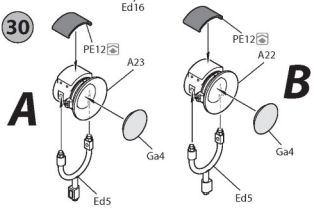



31

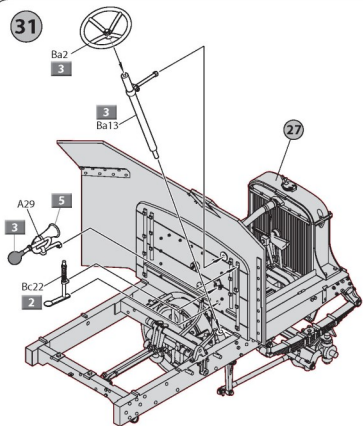

32

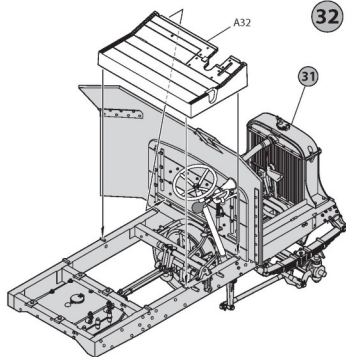

33

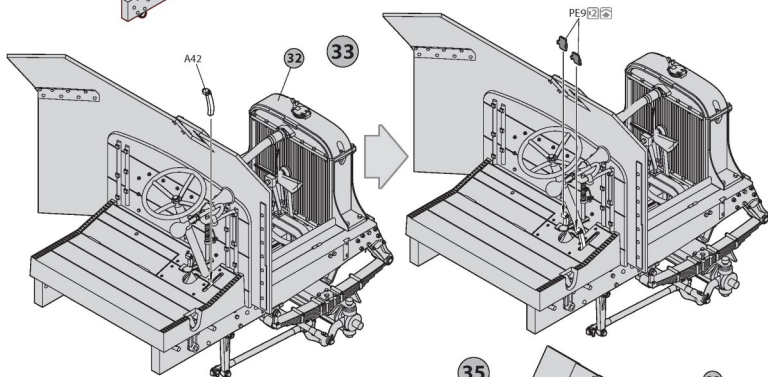

34 x2

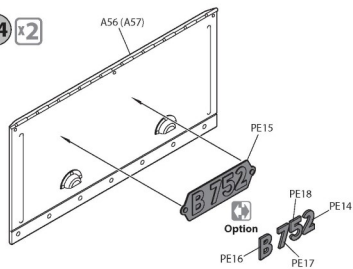

35

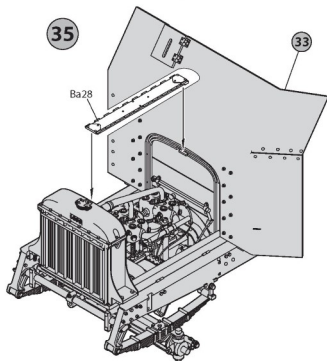

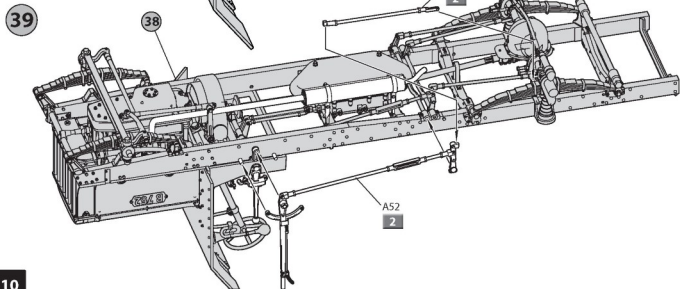
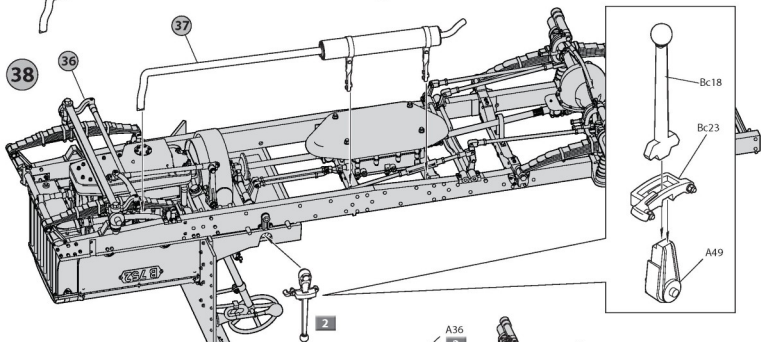
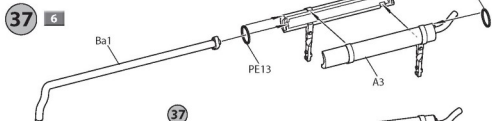
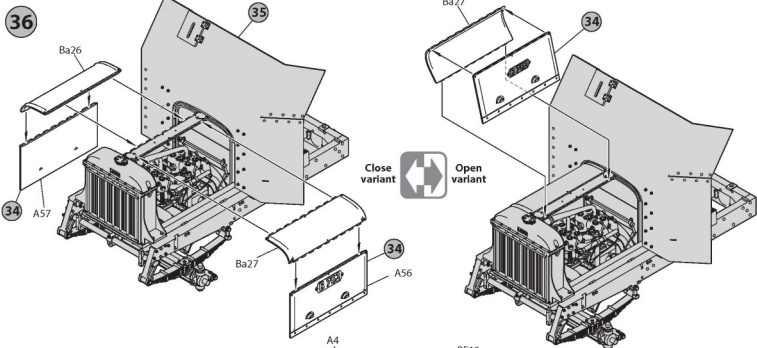

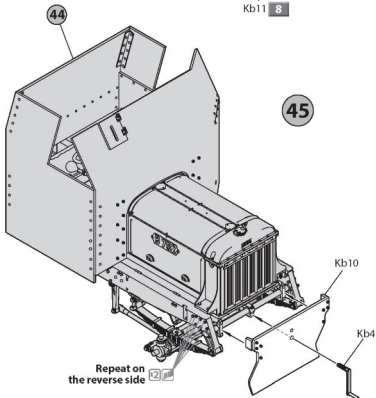
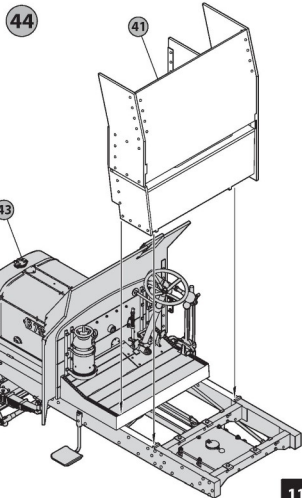
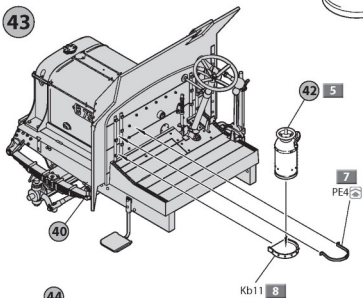
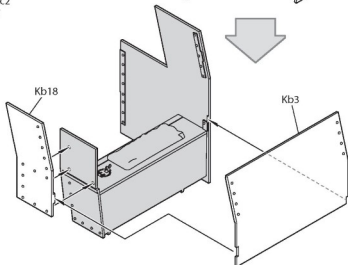
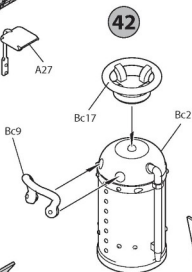
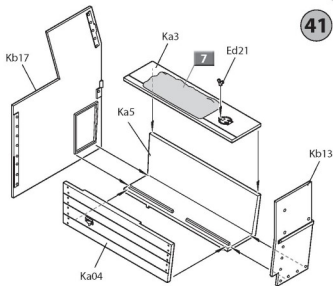
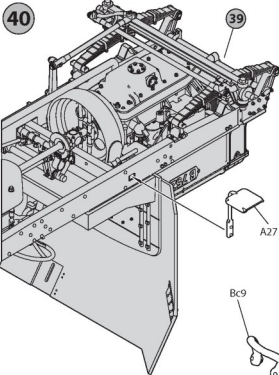

Repeat on the reverse side

46

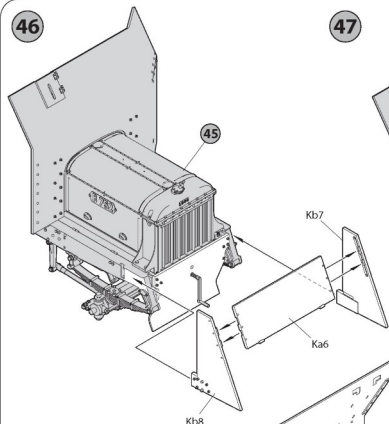

47

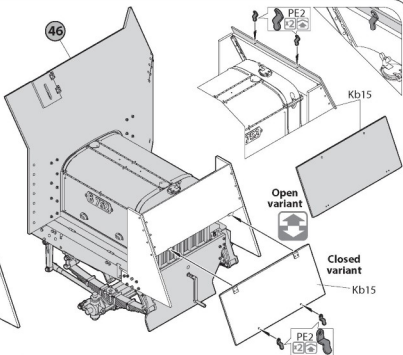

48

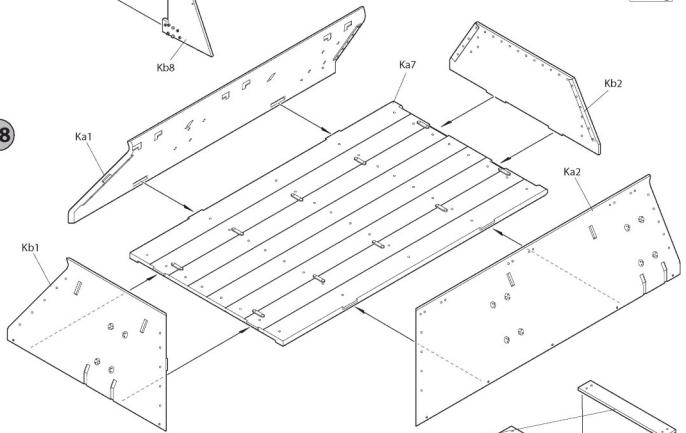

49

x2 Repeat on the reverse side

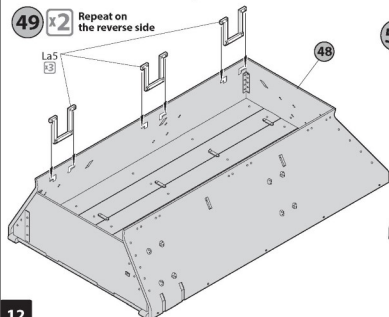

50

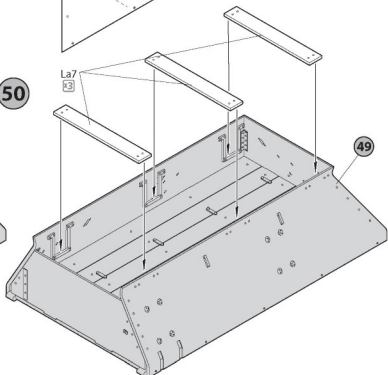

51

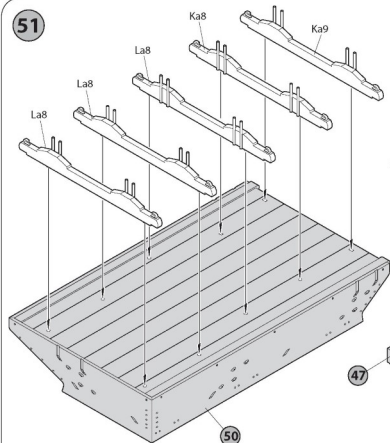

52

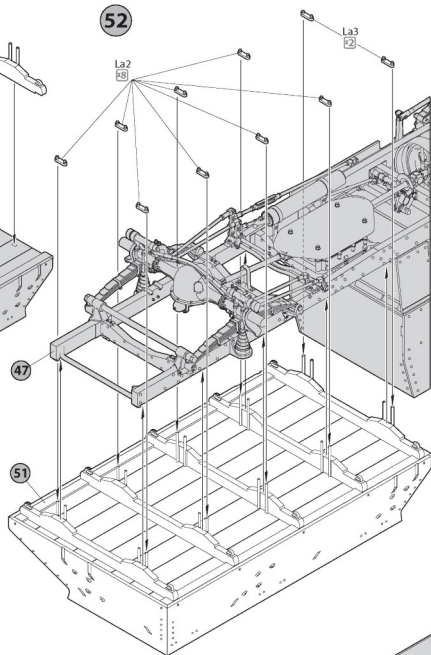

53

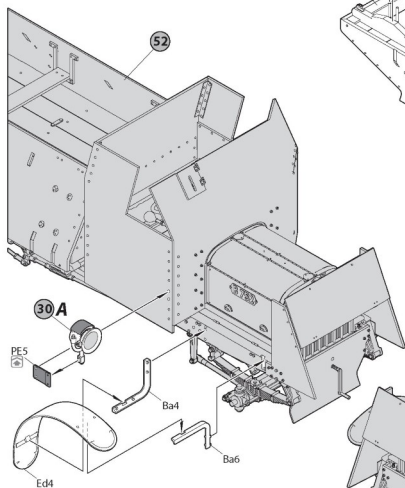

54

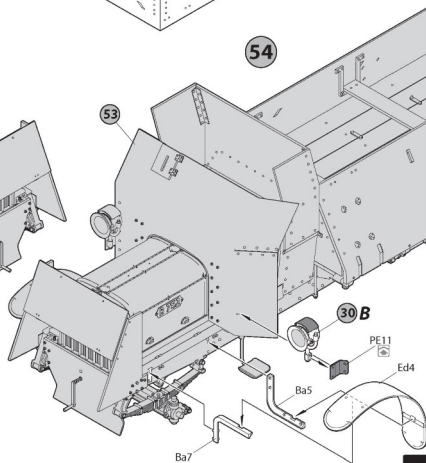

55

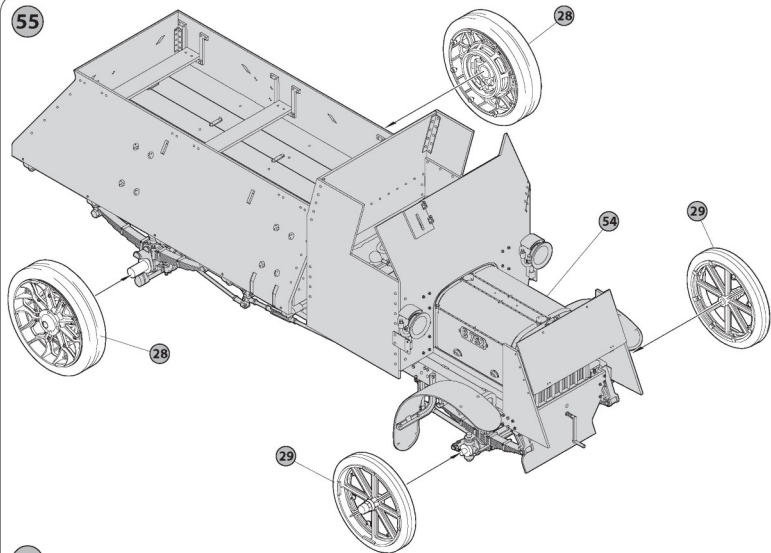

56

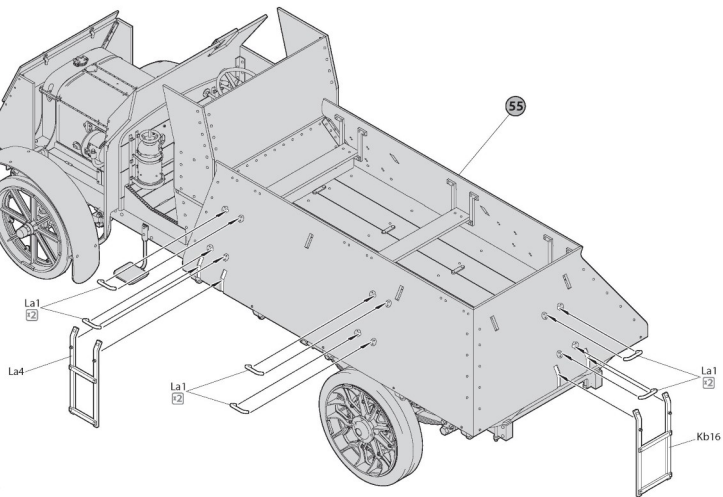



57

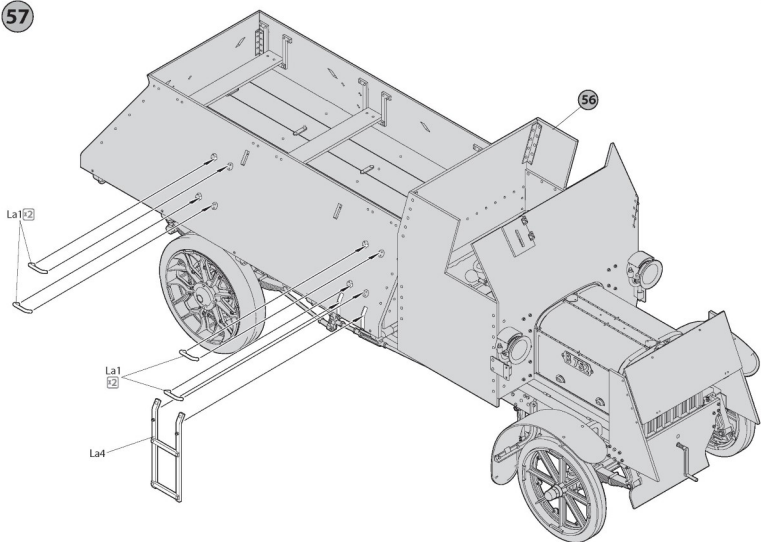

# BRITISH MILITARY LORRY B-TYPE

WW I MILITARY MINIATURES SERIES

UNASSEMBLED PLASTIC MODEL KIT  
KIT CONTAINS MODEL OF TRUCK  
PE PARTS INCLUDED  
THIS IS NOT A TOY



Booth2019

**MiniArt**

39003

1:35

**PAINTING GUIDE 1** The Motor Bandits, Royal Naval Air Service.  
Dunkirk-Antwerp, Autumn 1914.

