

MINIATURES SERIES

# SOVIET TRAM X -SERIES

## EARLY TYPE

38020



## GENERAL INSTRUCTION

SCALE  
1:35

- HIGHLY DETAILED MODEL
- USING CUTTING EDGE  
MOULDING TECHNIQUES
- INCLUDED CLEAR PARTS
- ALL DOORS CAN BE POSED  
OPENED OR CLOSED
- DECAL SHEET FOR 9 OPTIONS
- STAND WITH RAILS  
AND POLES INCLUDED

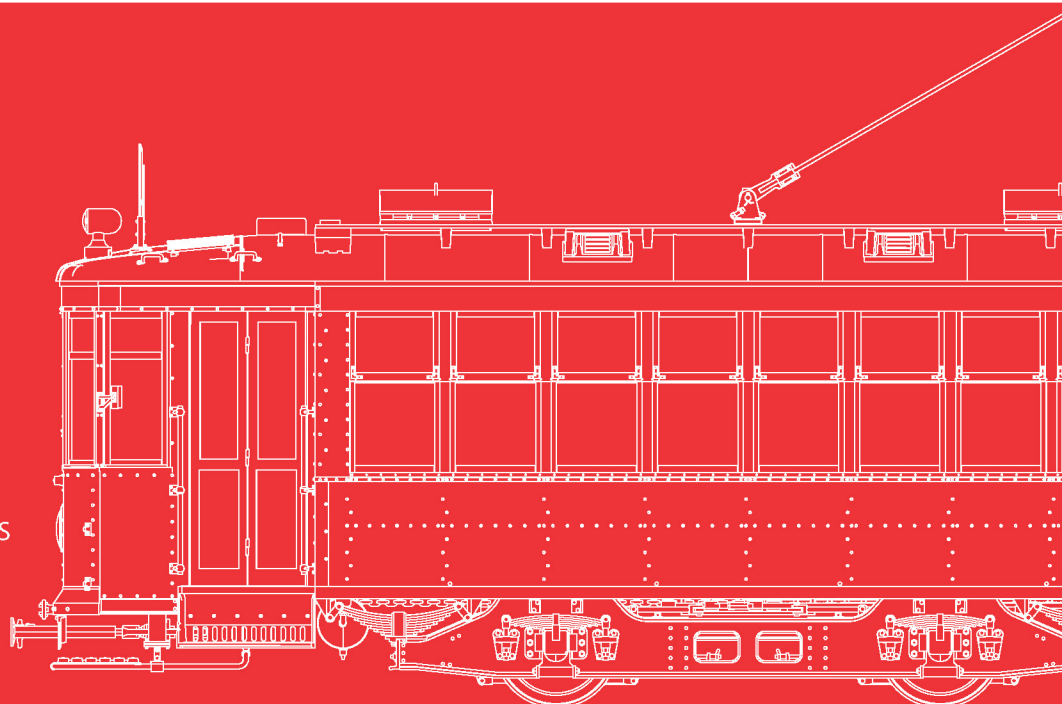

#### PAINTING GUIDE

#### ОКРАСКА

**1** Kyiv, 30-40s.  
Киев, 30-40-е годы.

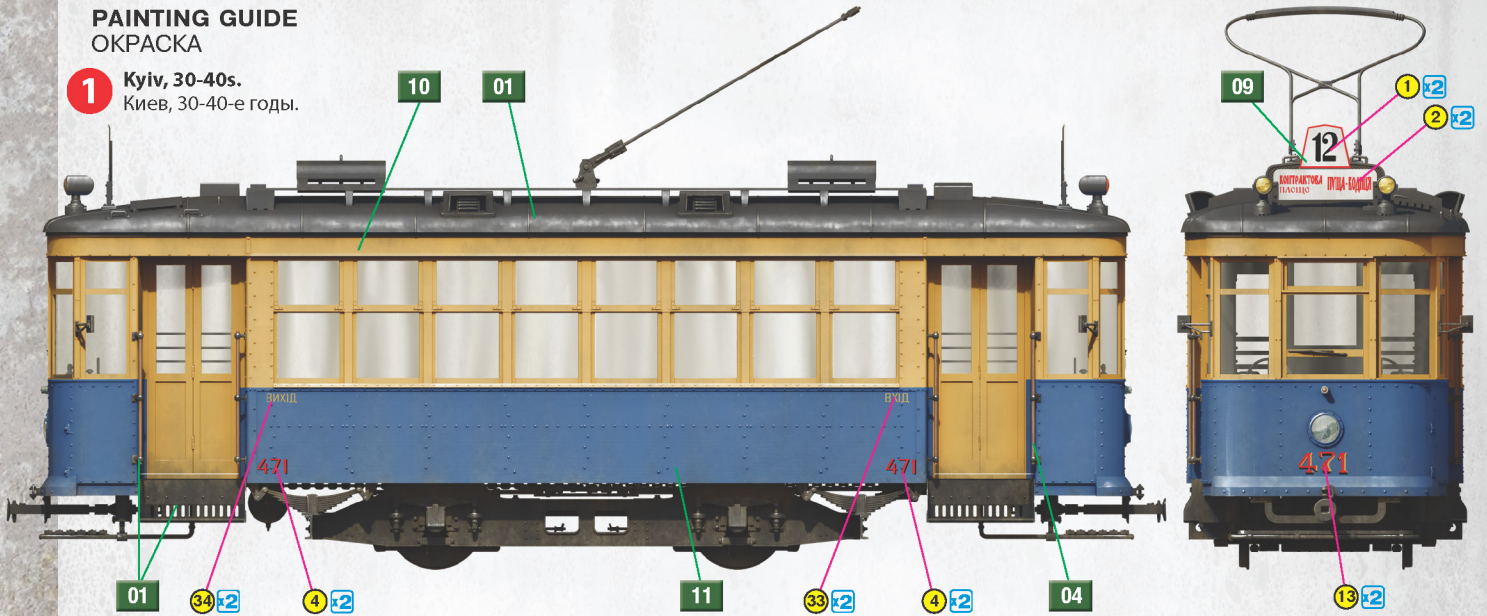

**2** Dnipropetrovsk (Dnipro now), 30-40s.  
Днепропетровск (Днепр сейчас), 30-40-е годы.

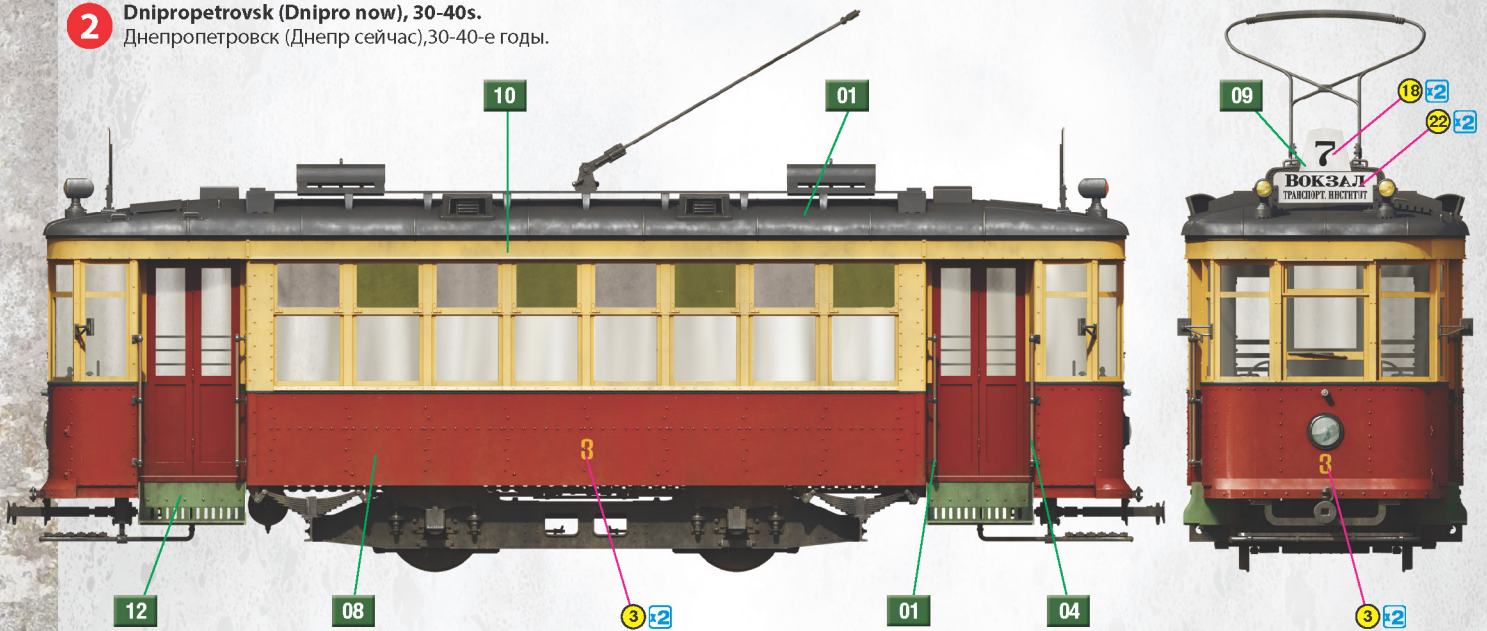

**3** Stalino (Yuzivka) (Donetsk now), 1943.  
Сталино (Юзовка) (Донецк сейчас), 1943 год.

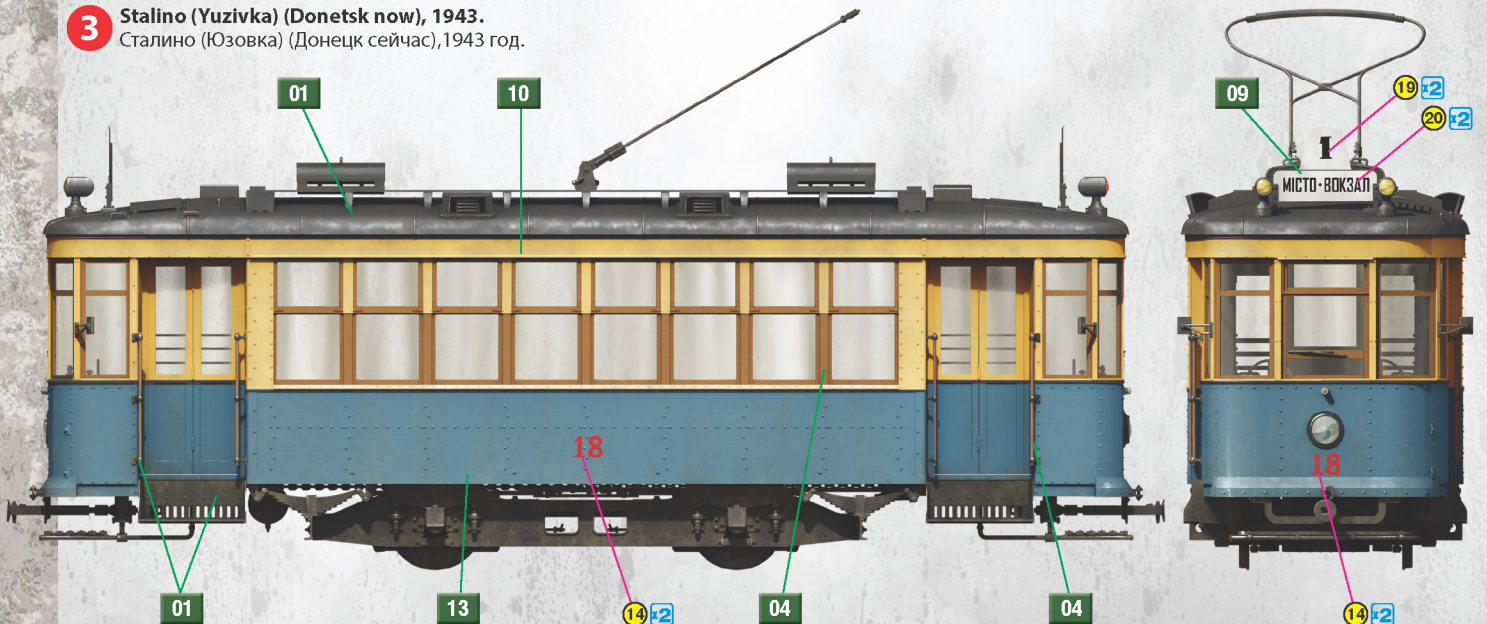

# The «X» series tram (Tramway «Kh» – series) – is a Soviet serial standard two-axle double-sided tram.

**Project year** – 1925

**Manufacturing plants:**

Mytishchi Machine-Building Plant, Moscow, USSR

Ust-Katavsk Carriage Works, Ust-Katav, USSR

**Year of release:** 1927 - 1941

**Year of operation:** 1928-early 1970's

**First city of operation:** Kharkiv, 1928

**Cities where the tram operated:**

**Ukraine:** Dnipro, Donetsk, Gorlovka, Kamianske, Kerch, Kharkiv, Konotop,

Kostiantynivka, Kryvyi Rih, Kyiv, Lugansk, Makiivka, Mariupol, Mykolaiv, Odesa,

Sevastopol, Simferopol, Zaporizhia

**Belarus:** Minsk, Viciebsk

**Russian Federation:** Arkhangelsk, Astrakhan, Barnaul, Chelyabinsk, Dzerzhinsk, Ivanovo, Kazan, Kemerovo, Krasnodar, Kursk, Lipetsk, Magnitogorsk, Moscow, Nizhniy Novgorod, Nizhniy Tagil, Noginsk, Novokuznetsk, Novorossiysk, Novosibirsk, Omsk, Orsk, Oryol, Perm, Prokopyevsk, Pskov, Pyatigorsk, Rostov-na-Donu, Saint-Petersburg, Salavat, Samara, Saratov, Shakhty, Smolensk, Taganrog, Tula, Tver, Ufa, Vladikavkaz, Vladivostok, Volgograd, Voronezh, Yaroslavl, Yekaterinburg, Zlatoust.

**Kazakhstan:** Almaty

**Armenia:** Yerevan

**Azerbaijan:** Baku

**Uzbekistan:** Tashkent

**Georgia:** Tbilisi

## PARTS

**A x2**

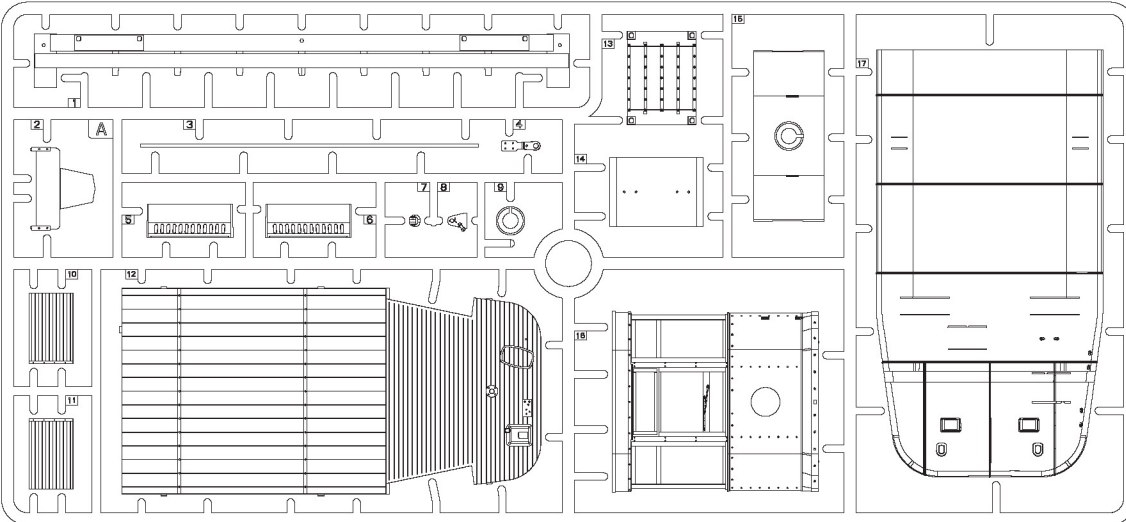

**Ea x2 (Clear parts)**

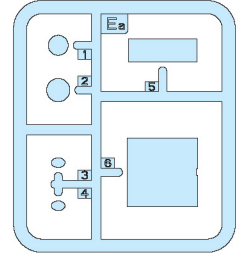

**B x2**

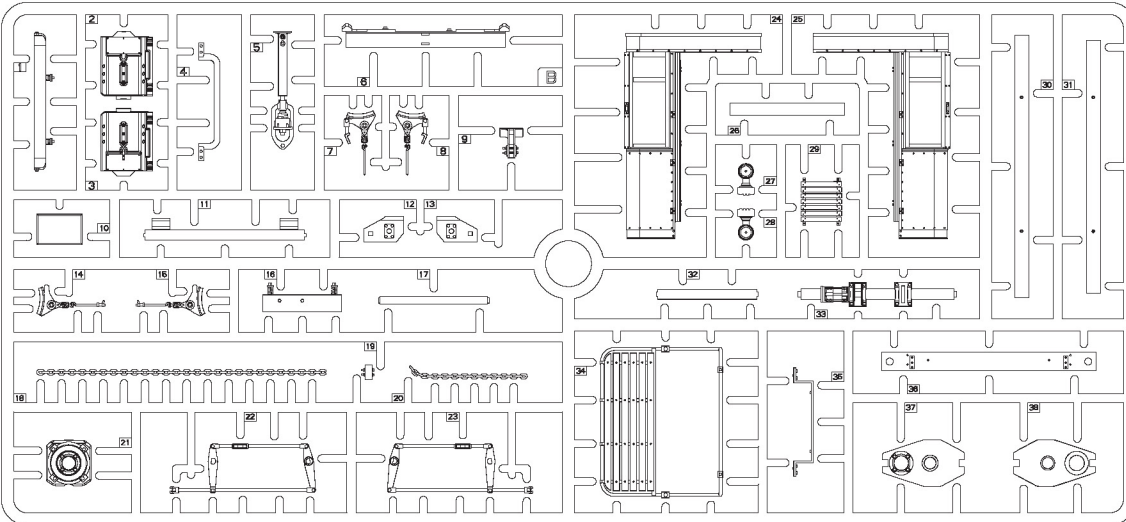

**Ec x3 (Clear parts)**

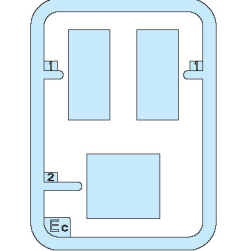

**Ed x4 (Clear parts)**

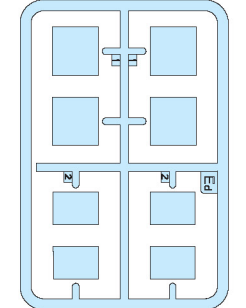

**Decal**

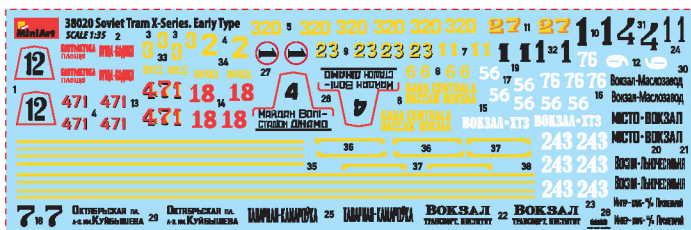

**Eg x2**

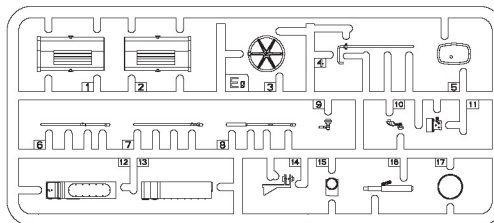

**Ef x4 (Clear parts)**

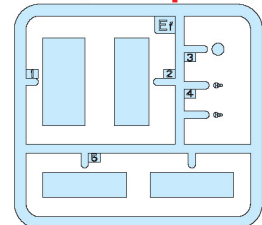

**Da x2**

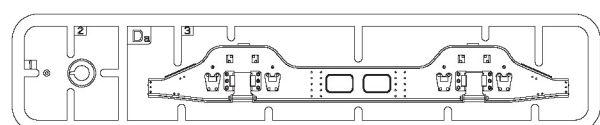

### ATTENTION

Ne pas utiliser de colle ou de peinture a proximite d'une flamme nue, et aiter la piece de temps en temps.  
Pour retirer les pieces hors du cadre, utiliser des ciseaux spaciaux pour maquette le plastique en excus avec un cutter ou une lime.  
Voir la fin de cette colonne pour la signification des symboles.  
Apris l'assemblage peut rester des pieces inutilisees.

### ZUR BEACHTUNG

Kleber und Farbe nicht nahe von offenem Feuer verwenden und das Fenster von Zeit zu Zeit zur Beluftung offnen.  
Zum Abschneiden der Teile vom Verbundstuck eine Modellierschere verwenden und die iberstehenden Plastikteile mit einem Messer oder einer Feile beseitigen.  
Die Bedeutung der Symbols finden Sie unten in dieser Nach dem Zusammenbau des Modells, konnen einzelne Teile ubrig bleiben

### УВАГА

При використанні клею та фарб всі роботи проводити подалі від джерел вогню у приміщенні, що добре провітрюється.  
Деталі відокремлювати від літників ножем або іншим ріжучим інструментом. Зачистити облой і місця зрізу за допомогою надфайлу та наждачного паперу. Будівництво моделі виконувати згідно зі схемою. Для зручності побудови кожна деталь позначена номером.  
Після складання можуть залишитися невикористані деталі.

### ATTENZIONE

Non usare colla e vernice vicino a fiamme esposte, e aprire le finestre di tanto in tanto per cambiare l'aria. Quando si staccano parti del carrello, usare forbici da modellismo e eliminare la plastica in eccesso con un coltello o una lima. Vedere in fondo a questa colonna per il signifi. Dopo l'assemblaggio possono rimanere parti inutilizzate.

### ВНИМАНИЕ

При использовании клея и красок все работы производить в проветриваемом помещении вдали от источников огня.  
Детали отделять от литников ножом или другим режущим инструментом. Зачистить облой и места среза при помощи надфайла и наждачной бумаги. Сборку моделей производить согласно схеме сборки.  
Для удобства сборки каждая деталь обозначена номером.  
После сборки набора могут остаться неиспользованные детали.

### CAUTION

When you use glue or paint, do not use near open flame, and use in well ventilated room. When you take parts off from the runner frame, use modeling scissors or cutter.  
See the bottom of this column for the meaning of symbols.  
Extra details can remain after assembling of the kit.



MAKE 2PCS  
2 TEILE FERTIGEN  
EFFECTUER 2 PIECES  
FARE DUE PEZZI  
TEE 2 KPL  
GÖR 2 ST  
ПОВТОРИТЬ ДВА РАЗА  
КЛІКІСТЬ РАЗІВ



DO NOT CEMENT  
NICHT KLEBEN  
NE PAS COLLER  
NON INCOLLARE  
EILIMÄÄ  
LIMÄEJ  
НЕ ИСПОЛЬЗОВАТЬ КЛЕЙ  
НЕ КЛЄТИ



OPTIONAL  
NACH BELIEBEN  
FACULTATIF  
FACOLTATIVO  
VALINNAVARAINEN  
VALBAR  
ВАРИАНТЫ  
ВАРІАНТИ



OPEN HOLE  
OFFNEN  
FAIRE UN TROU  
FORO APERTO  
AVAA REIKÄ  
OPPIÄ HALET  
СДЕЛАТЬ ОТВЕРСТИЕ  
ЗРОБИТИ ОТВІР



REMOVE  
ENTFERNEN  
RETRIER  
SEPARARE  
POISTA  
AVLÄGSNA  
OTREZATI  
ВІДРІЗАТИ



BEND  
BITTE BIEGEN  
PLIER S'IL VOUS PLAÎT  
PIEGARE  
TAITA  
BOCKA  
ВІГНУТЬ  
ВІГНУТИ



SCRATCHBUILD  
AM MEISTEN ZU MACHEN  
FAIRE LE PLUS  
RENDITI  
TEE ITSE  
GÖR DIG SJÄLV  
СДЕЛАТЬ САМОМУ  
ЗРОБИТИ САМОМУ

## PARTS

### Ca x4

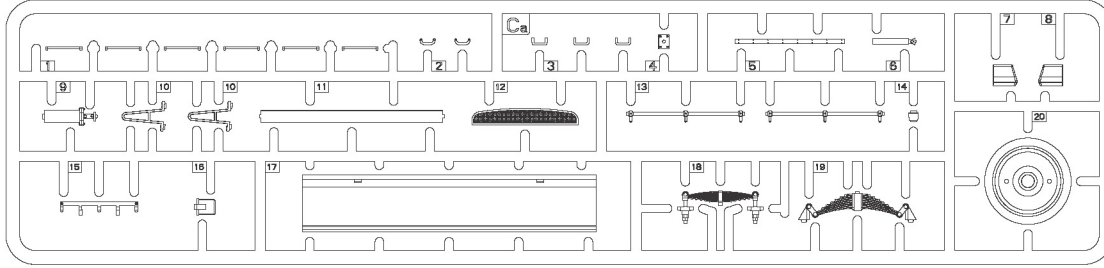

### Ce x4

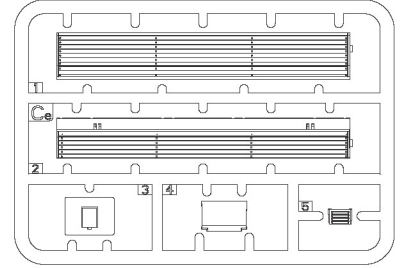

### Fa x2

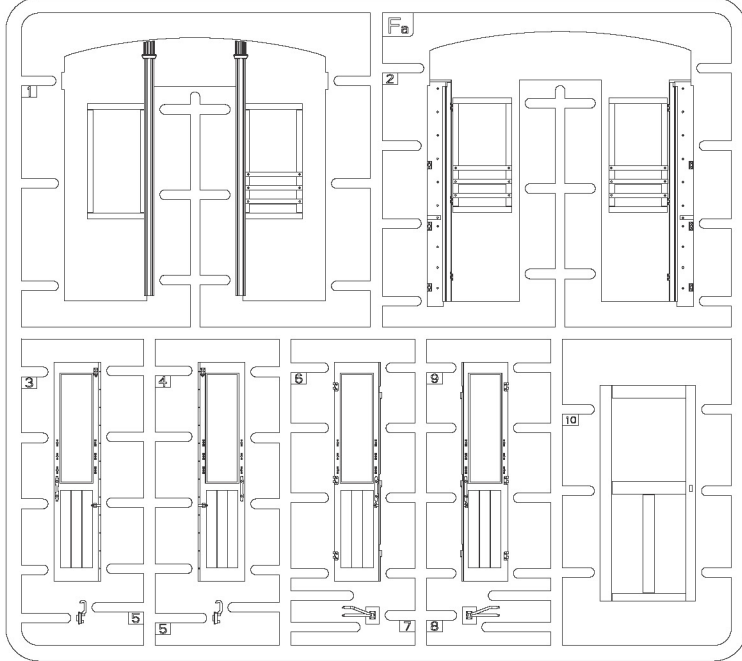

### Fb

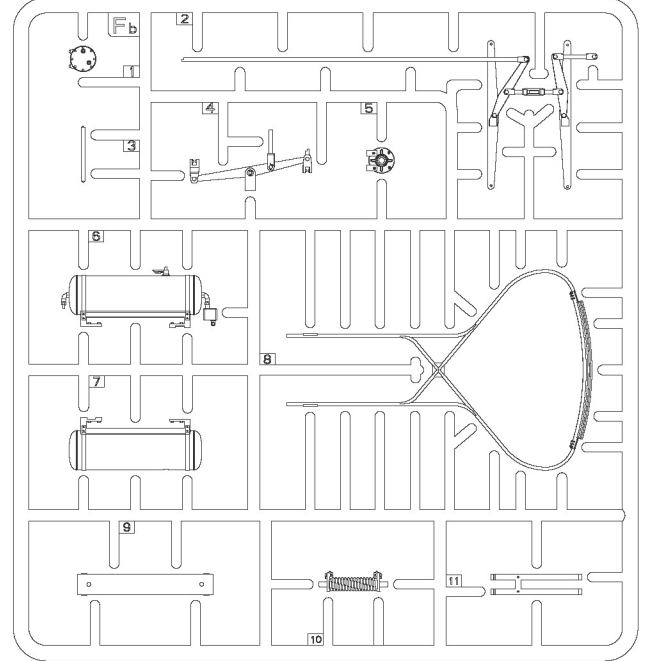

### Df x2

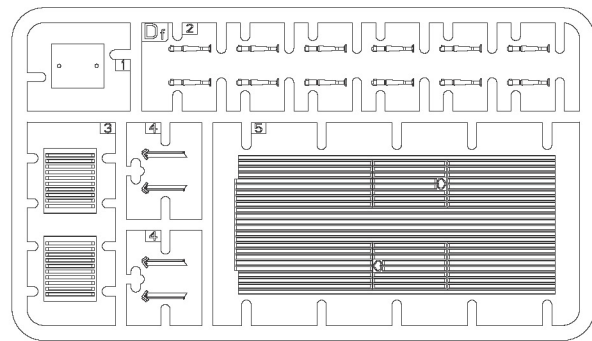

### Dc x2

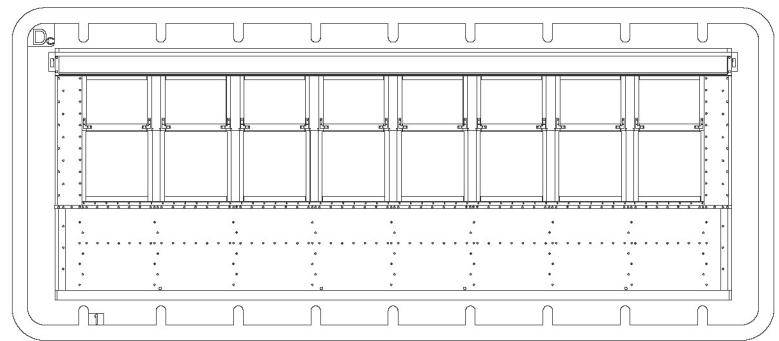

### A x2

## PARTS FOR BASE ASSEMBLY

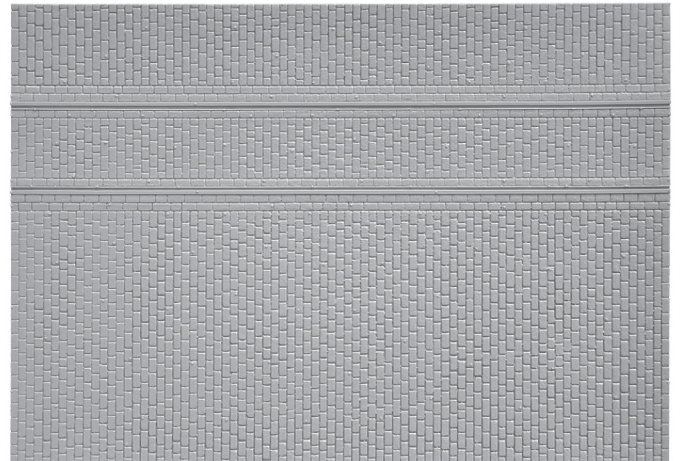
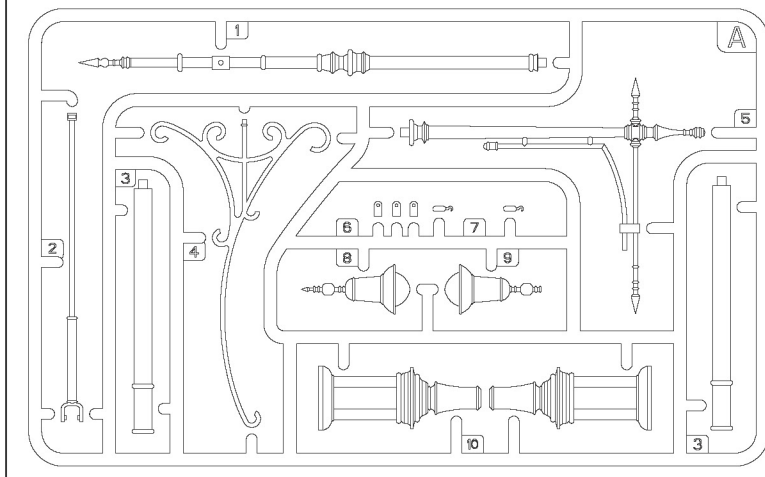

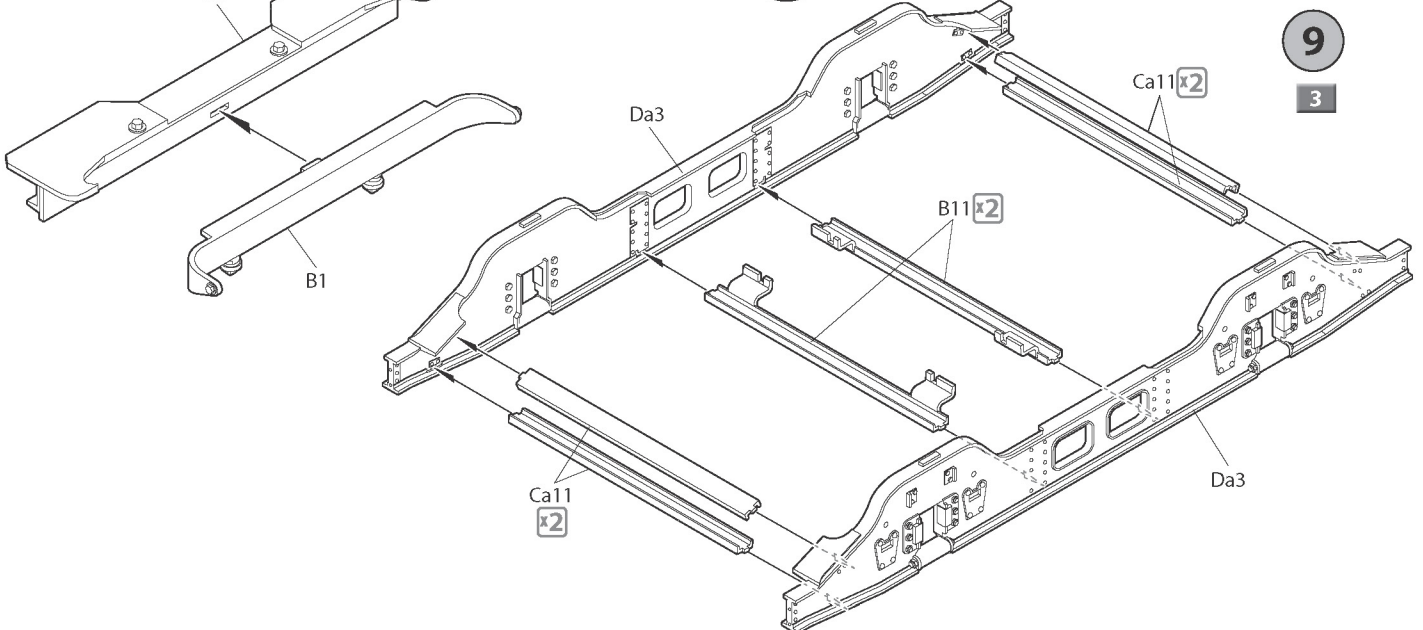
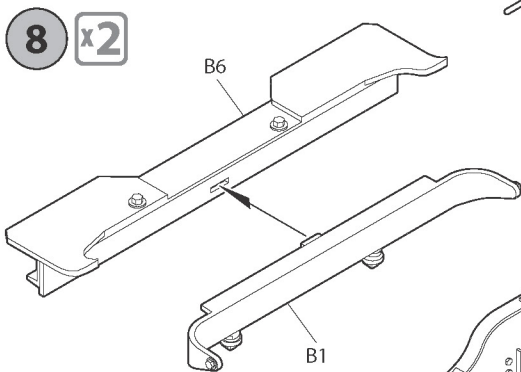
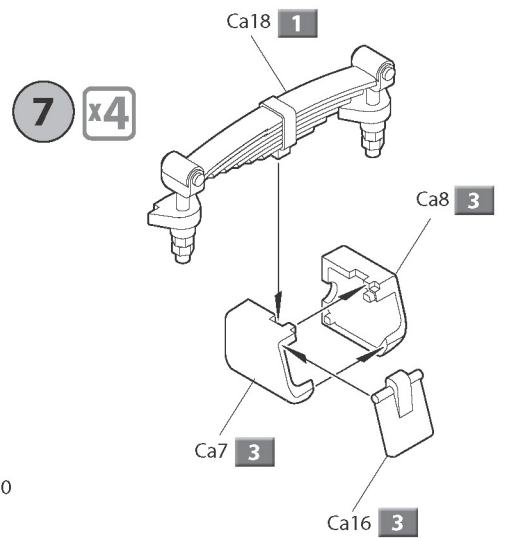
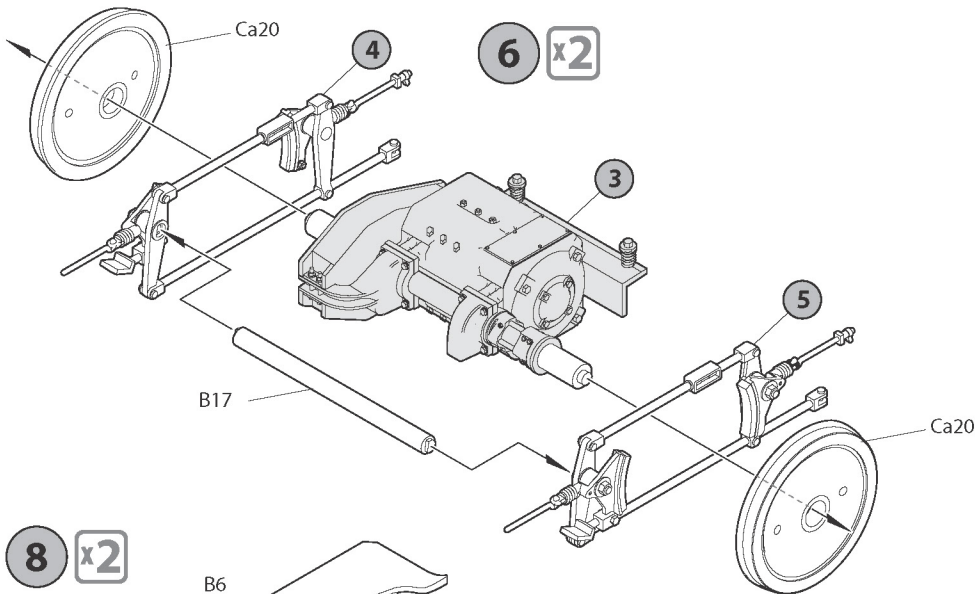
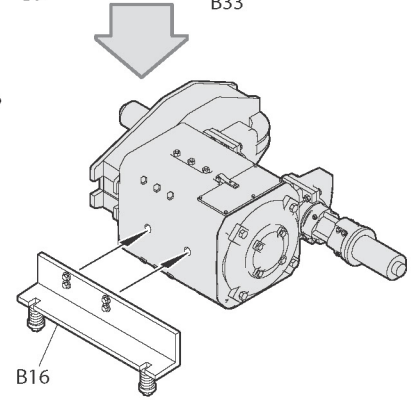
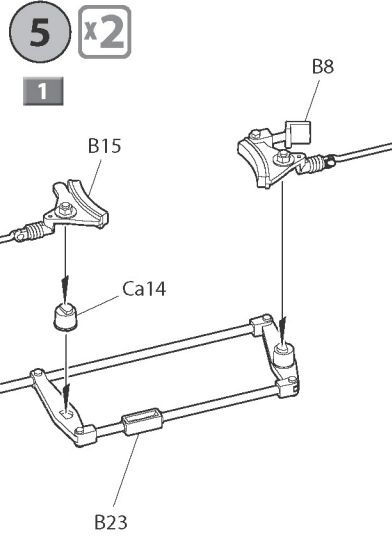
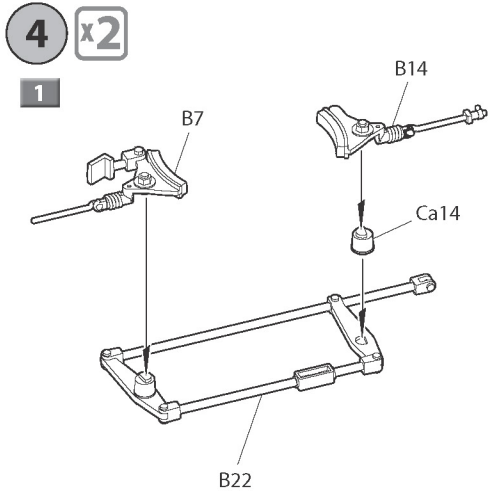
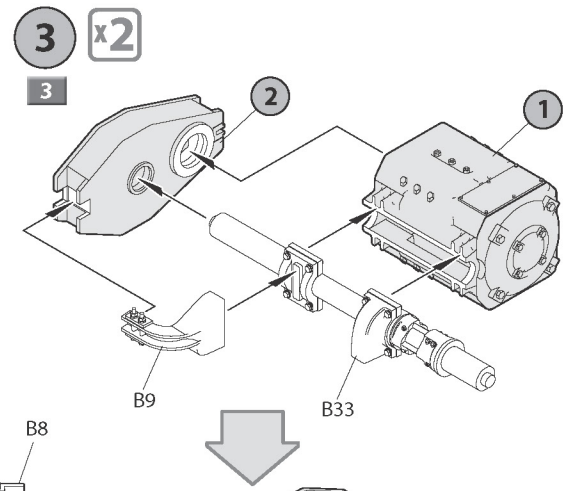
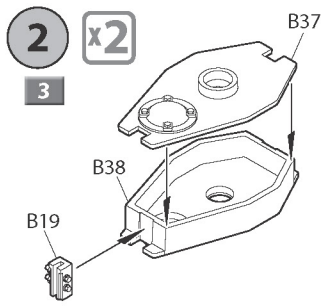
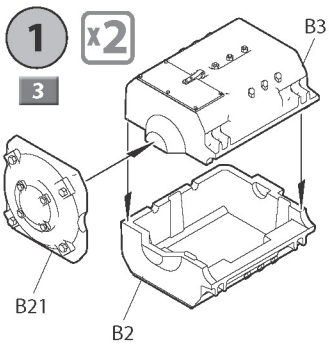

10

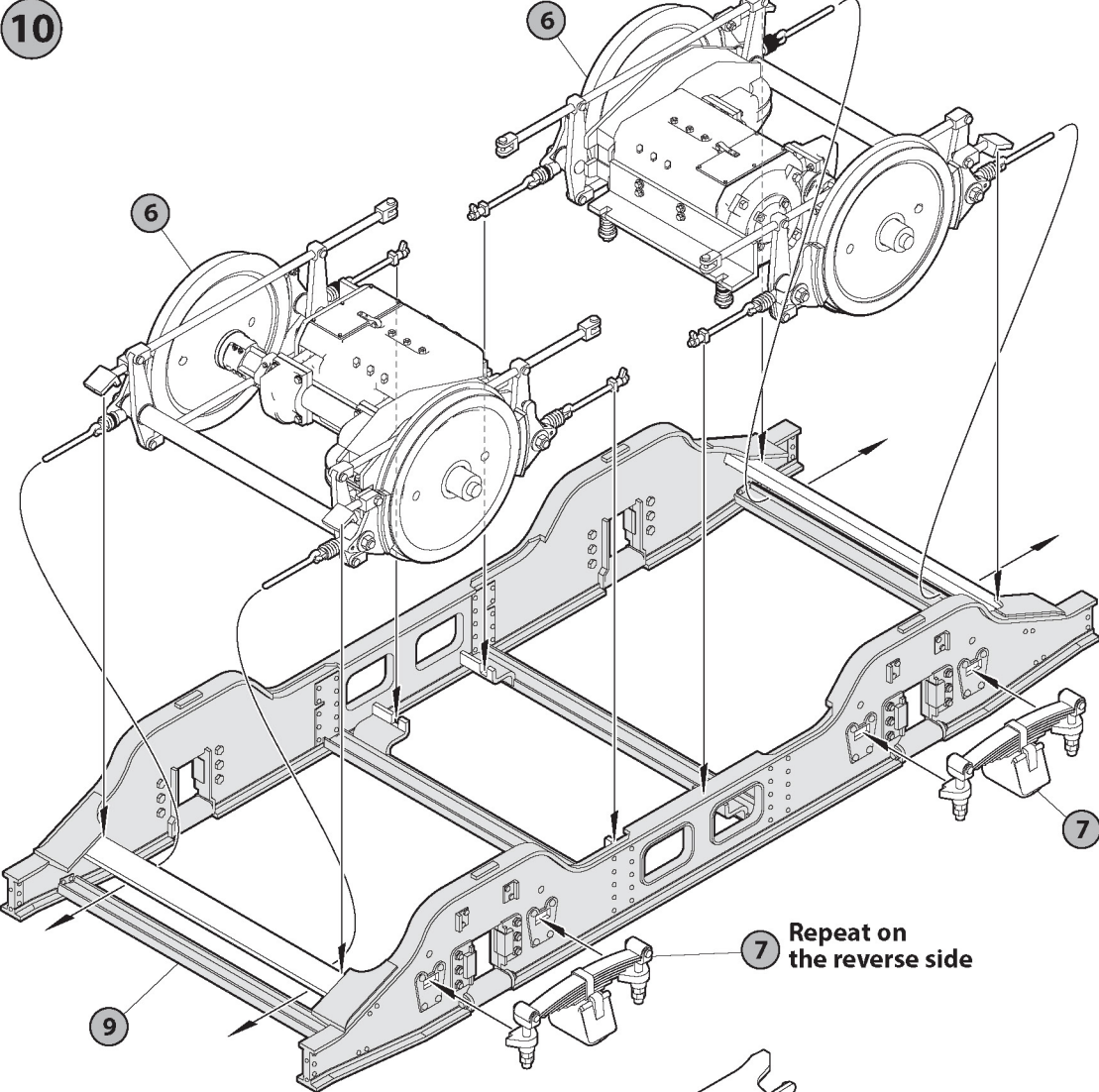

11

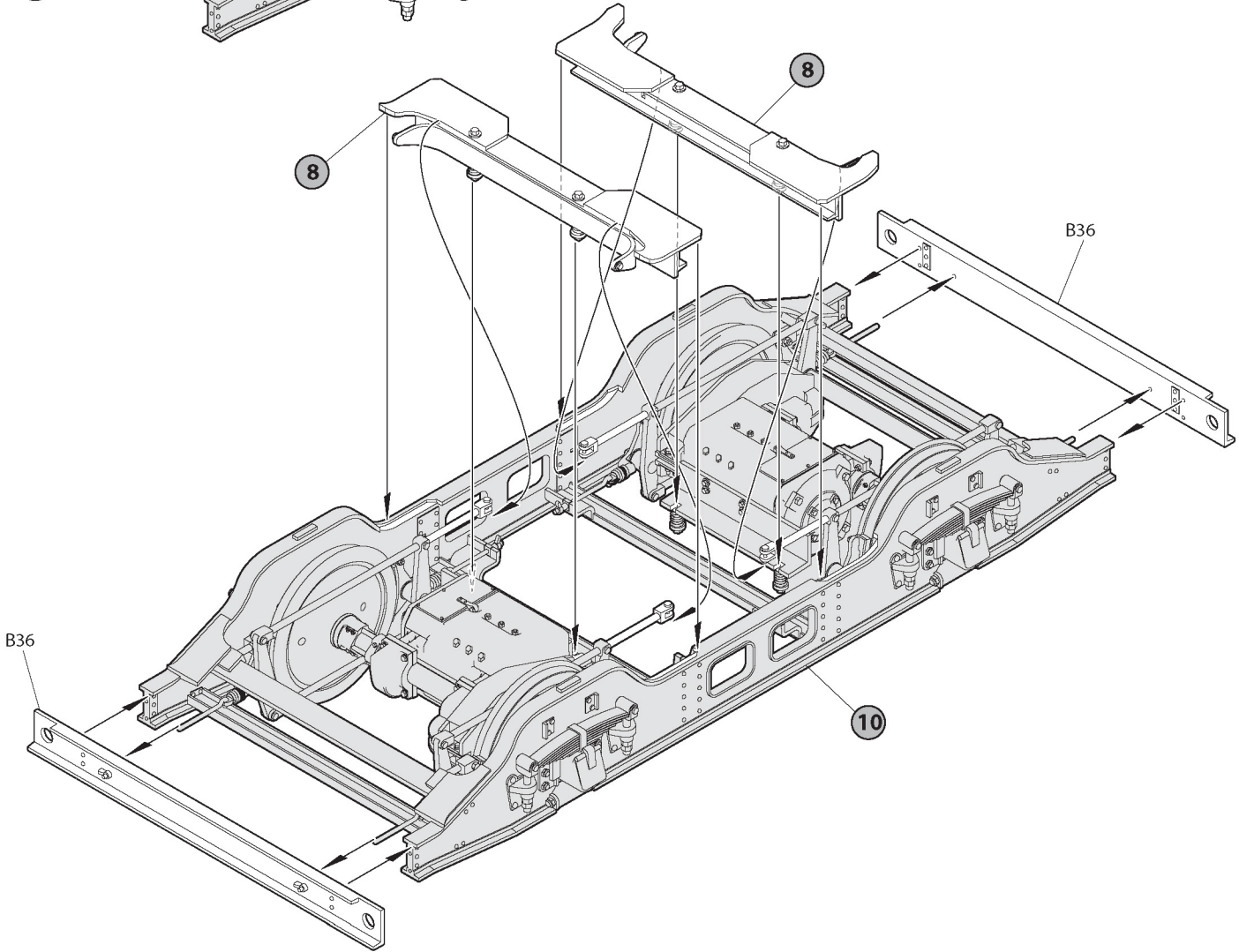

12

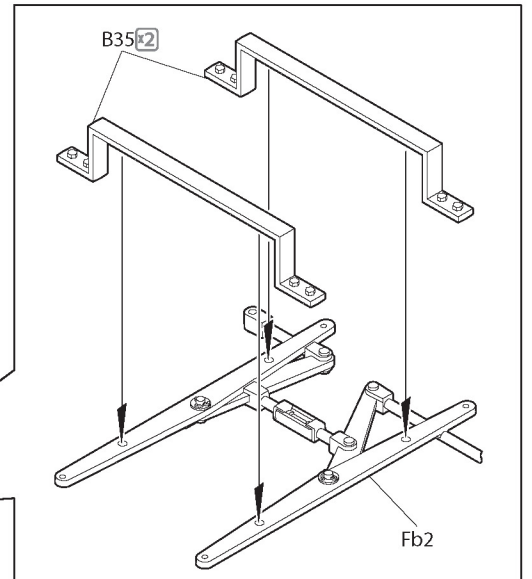
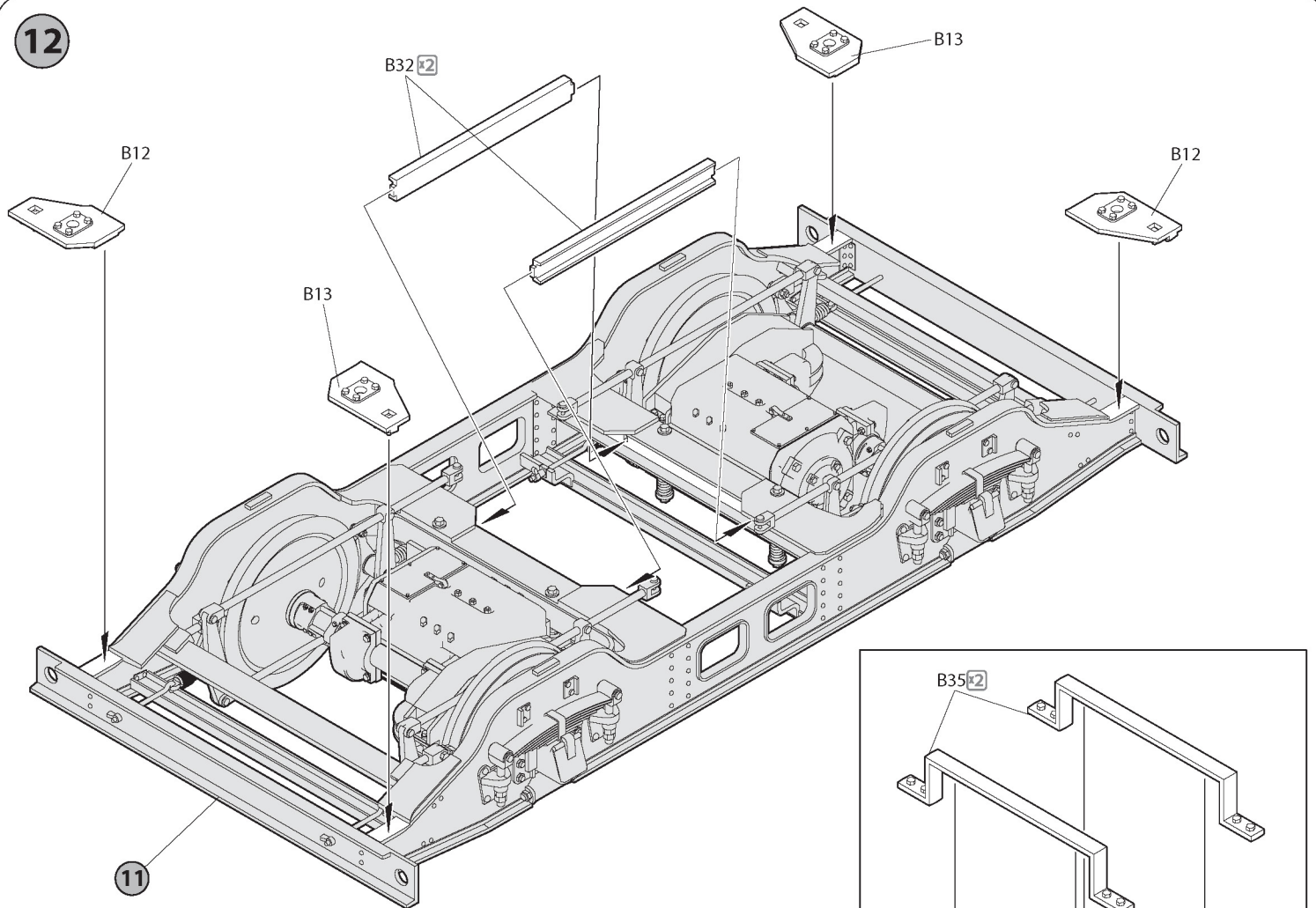

13

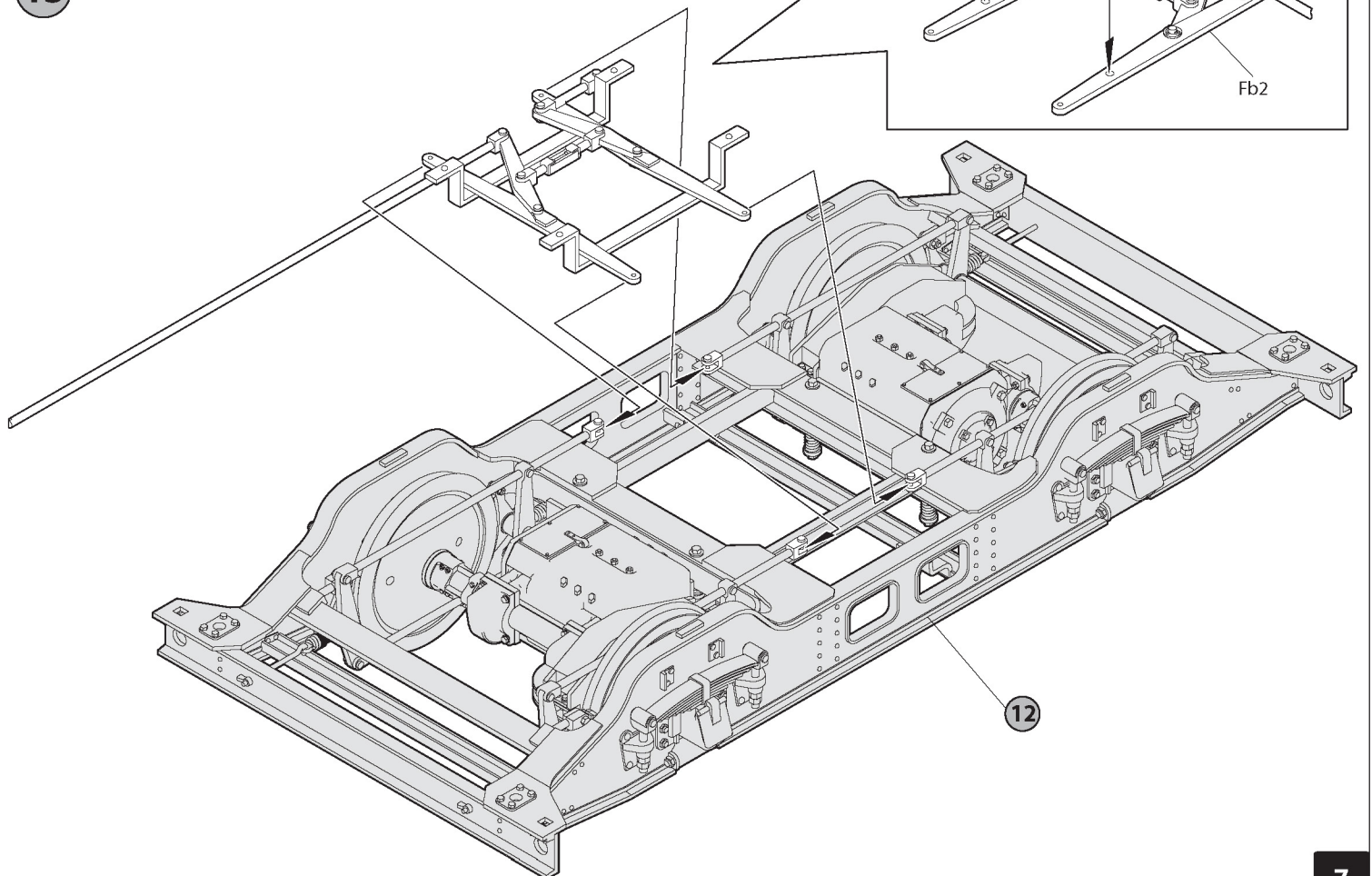

**14** x2 Repeat on the reverse side

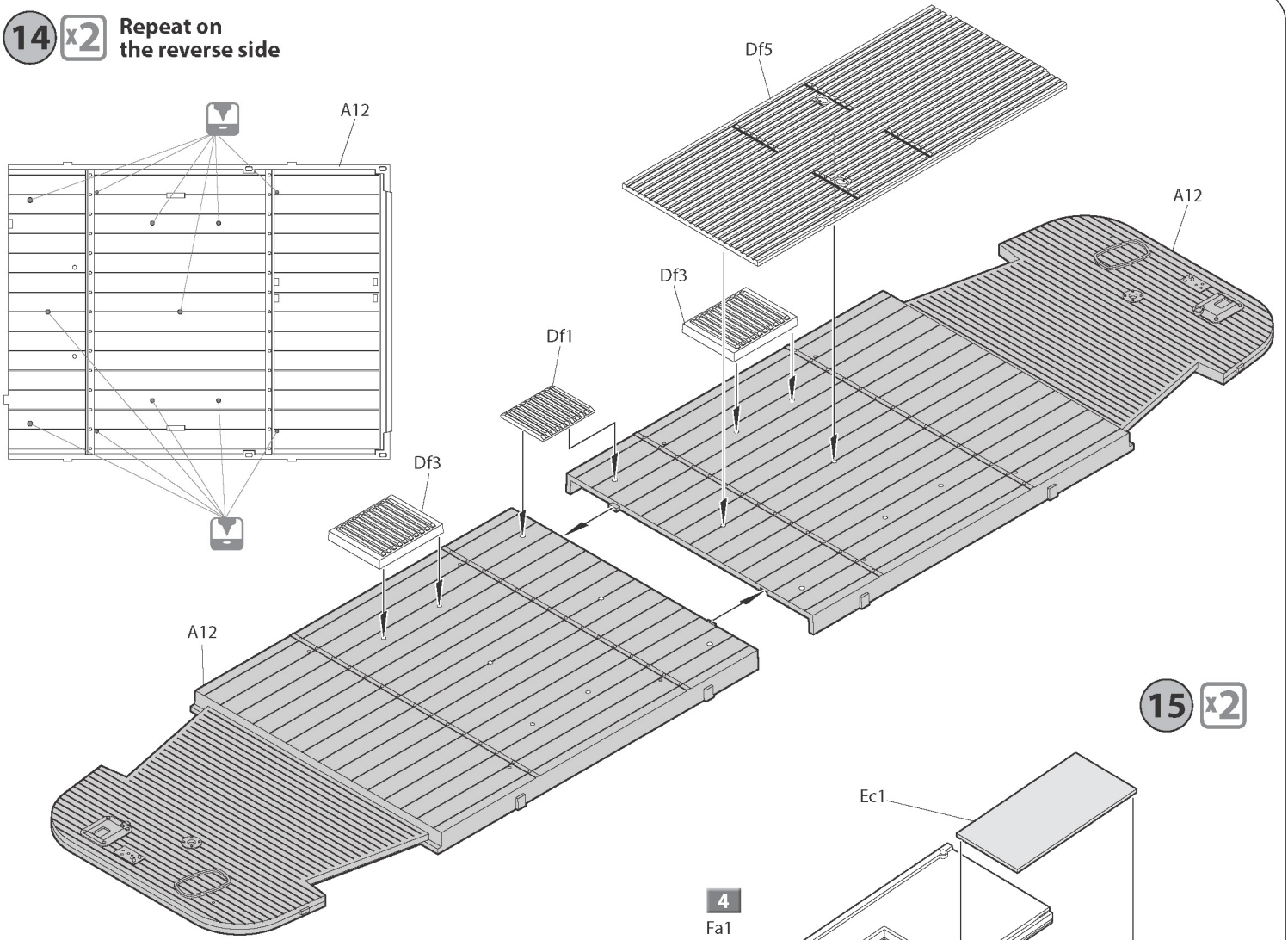

**15** x2

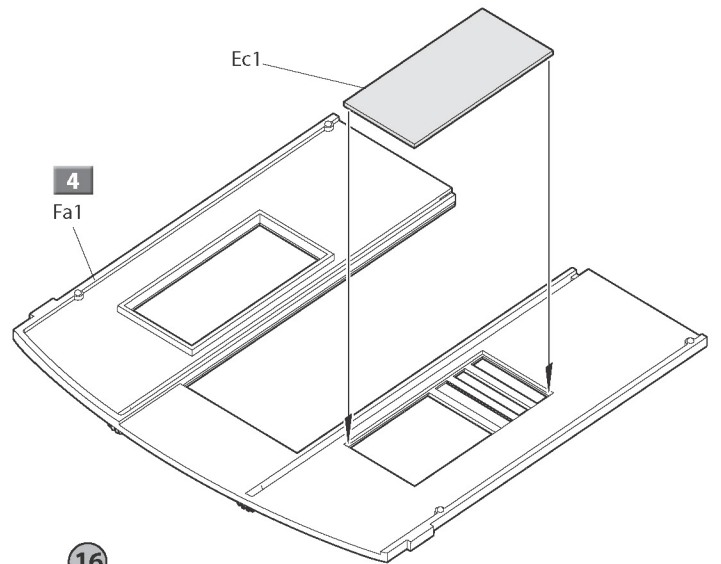

**16** x2

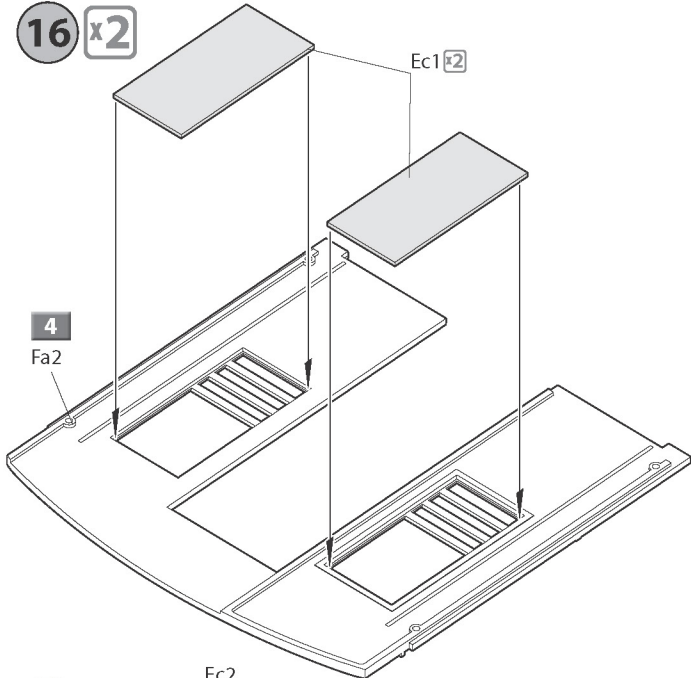

**18** x2

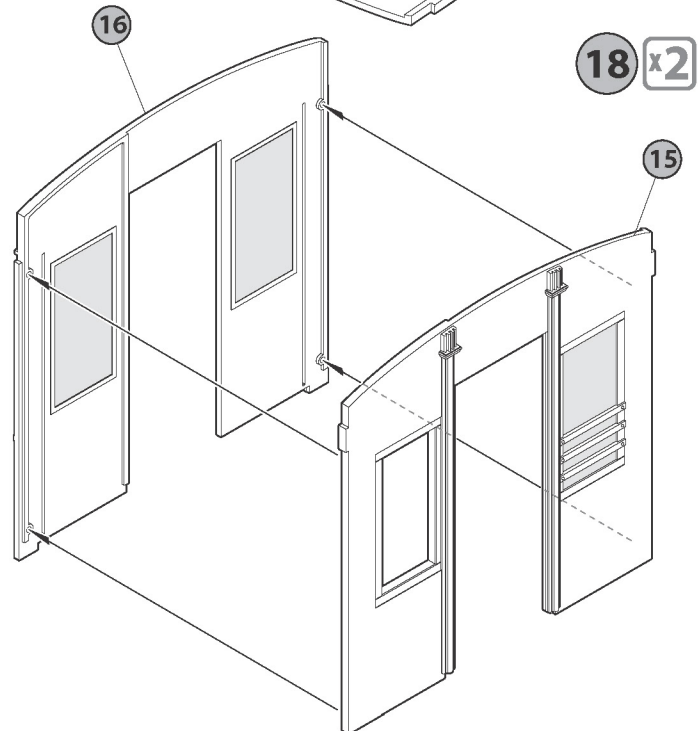

**17** x2

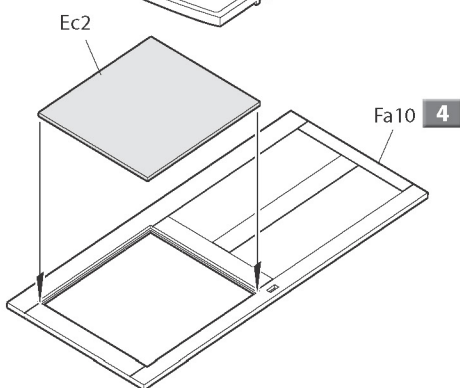



19 x2

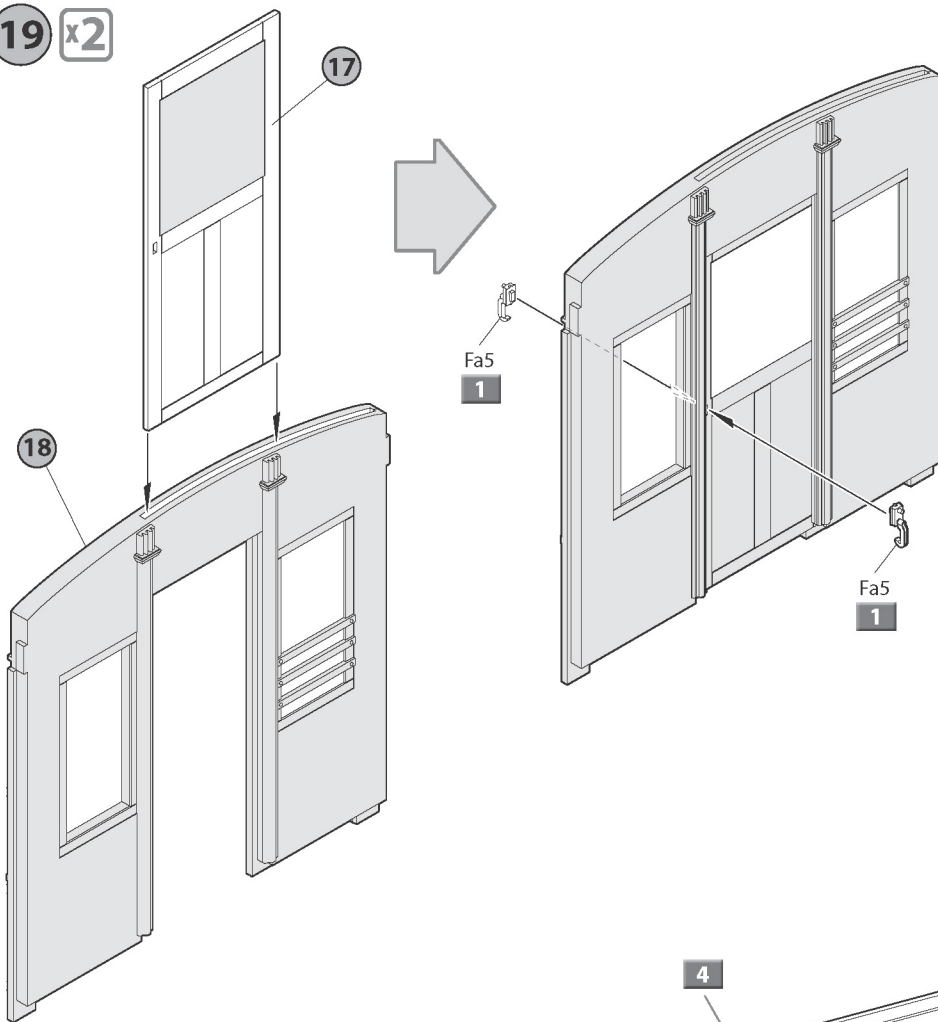

20 x2

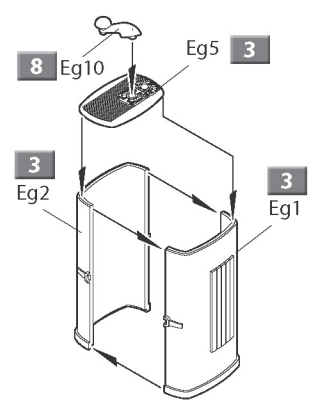

21 x2

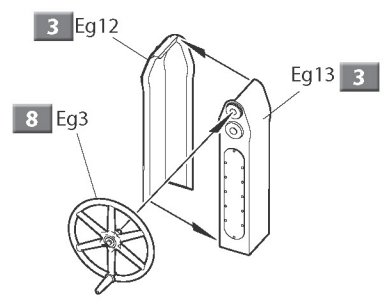

22 x2

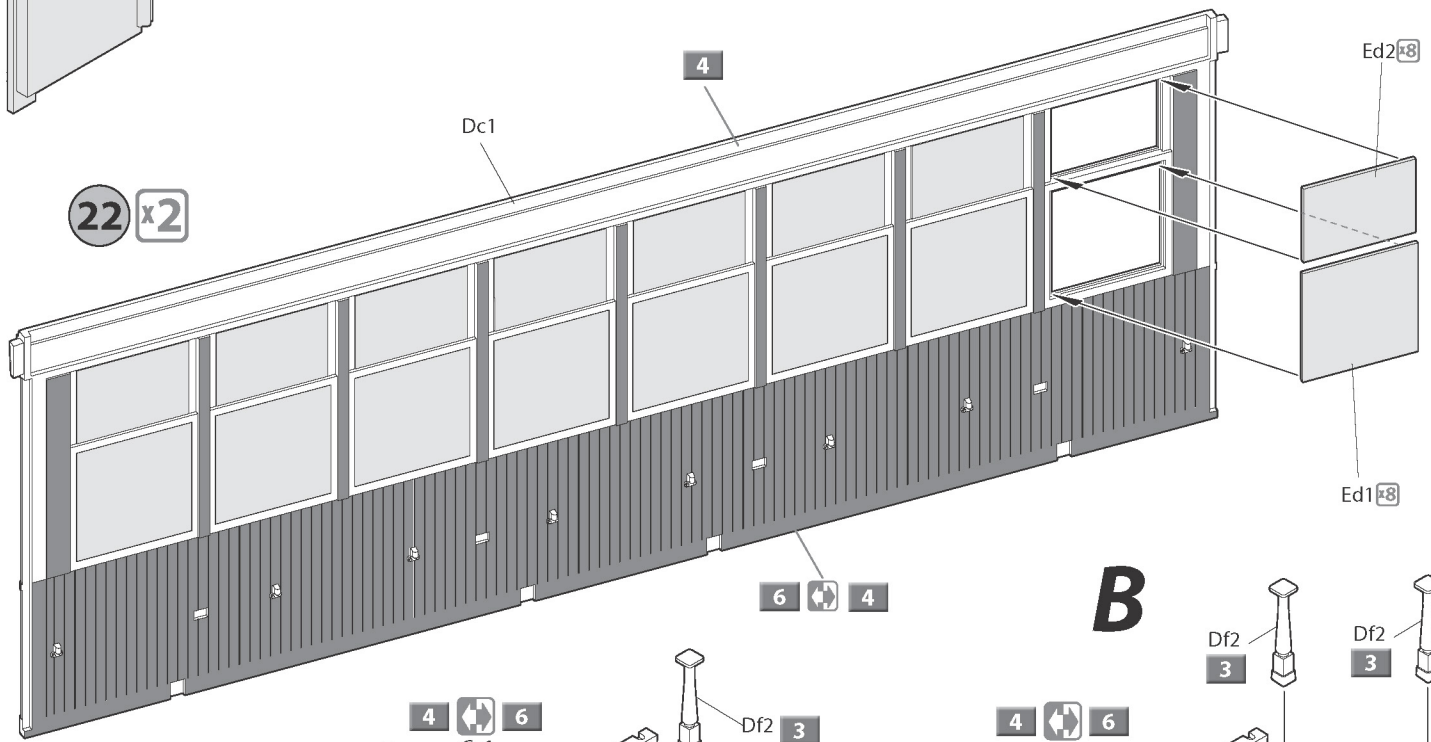

23 x2

**A**

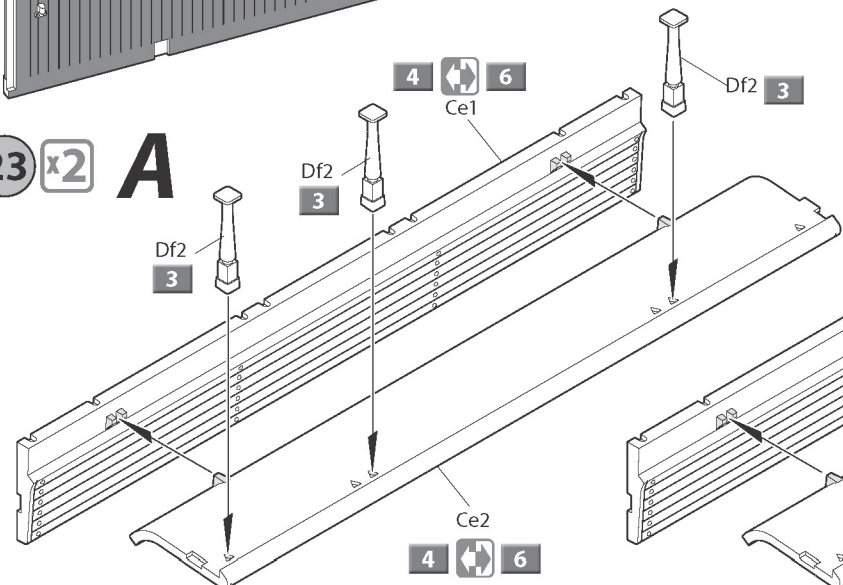

**B**

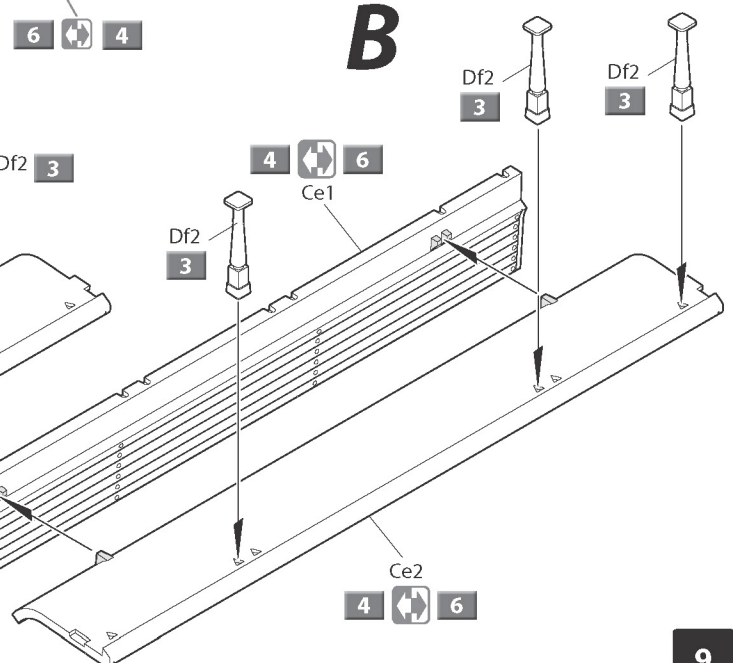

**24** x2 Repeat on the reverse side

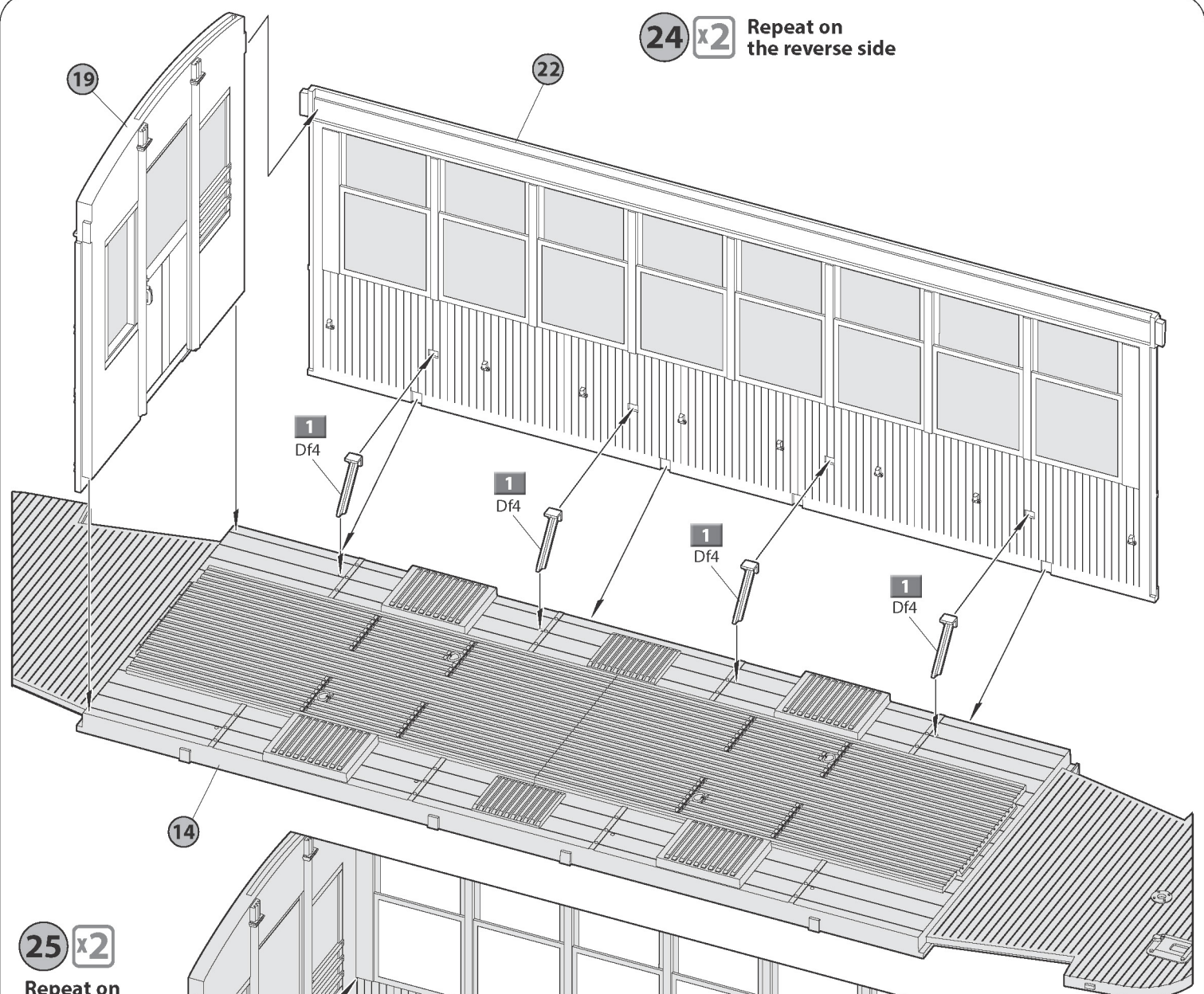

**25** x2 Repeat on the reverse side

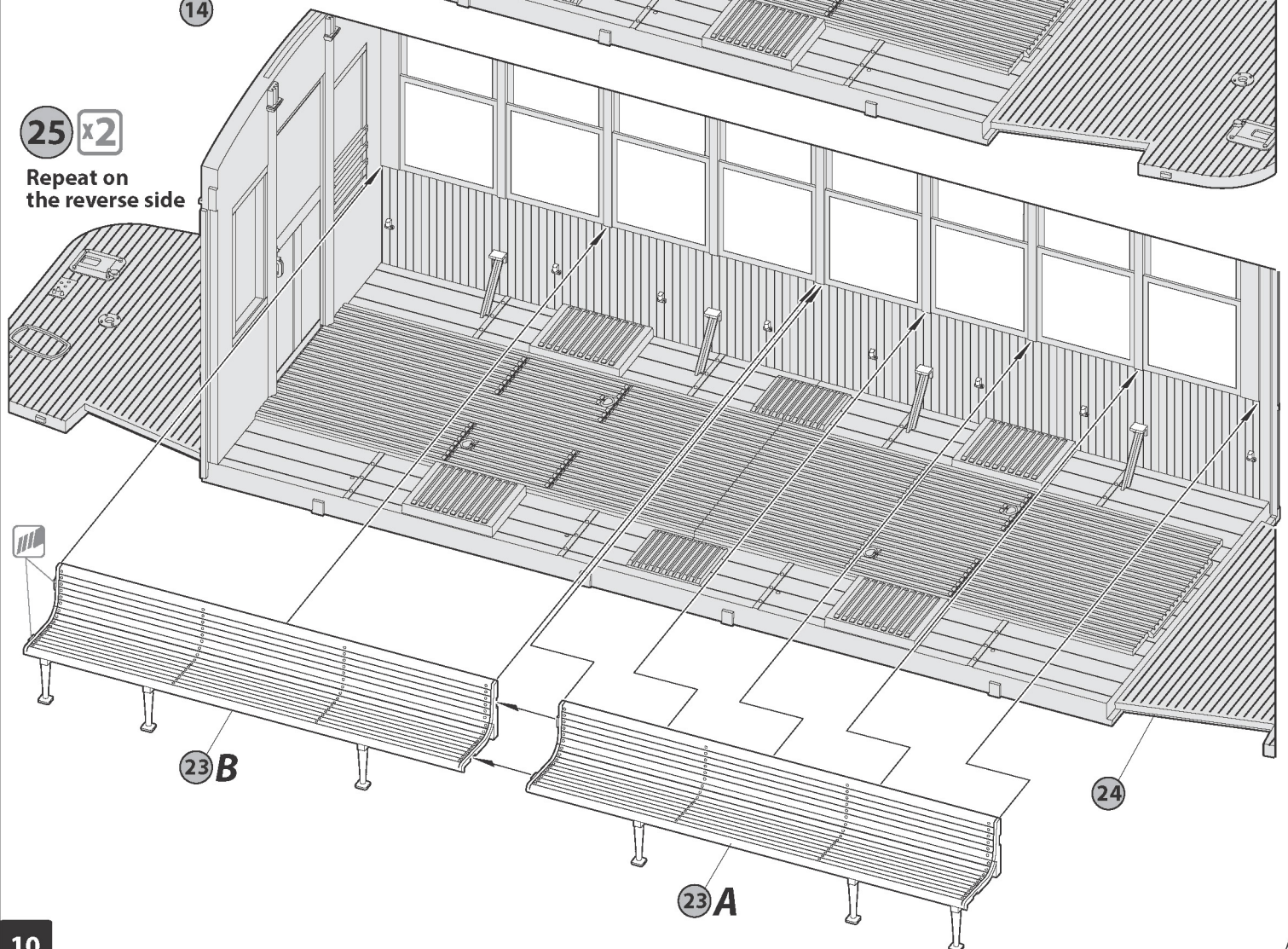

**26** **x2** Repeat on the reverse side

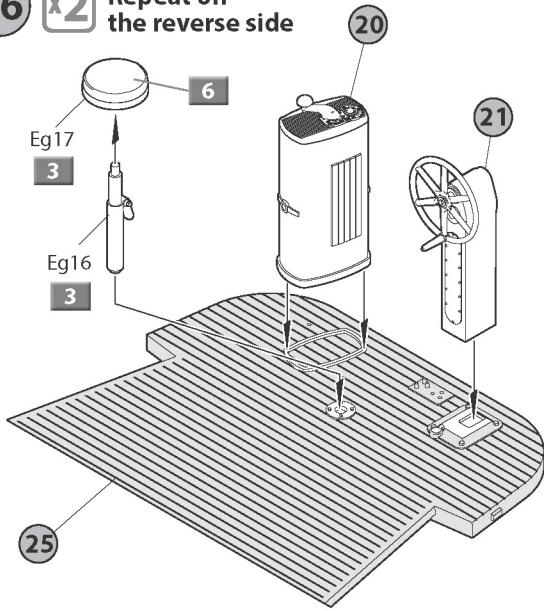

**27** **x2**

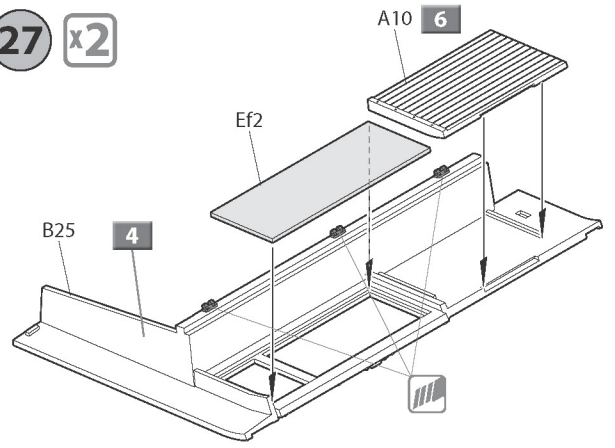

**28** **x2**

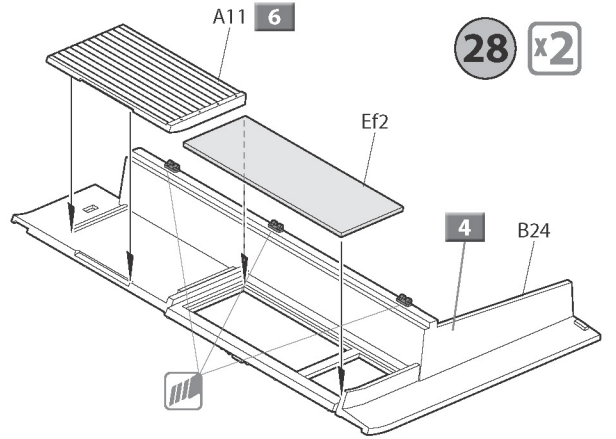

**29** **x2**

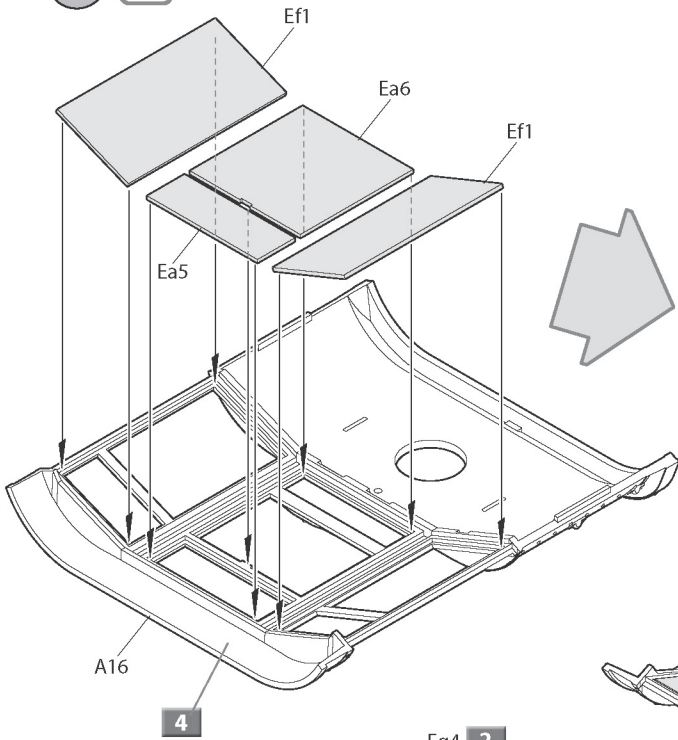

**Ca5** **x2**

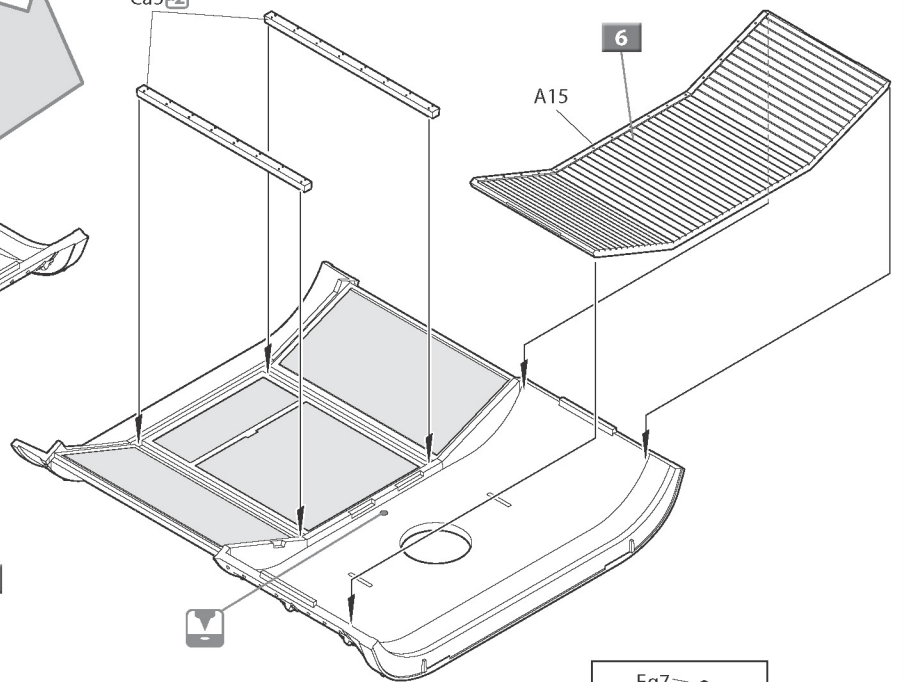

**30** **x2**

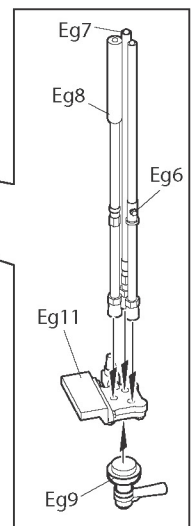
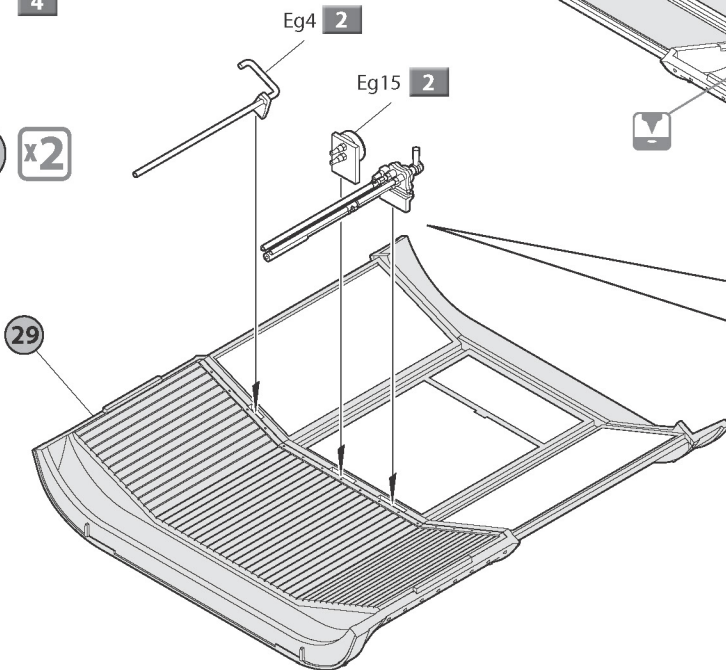

**31** Repeat on the reverse side

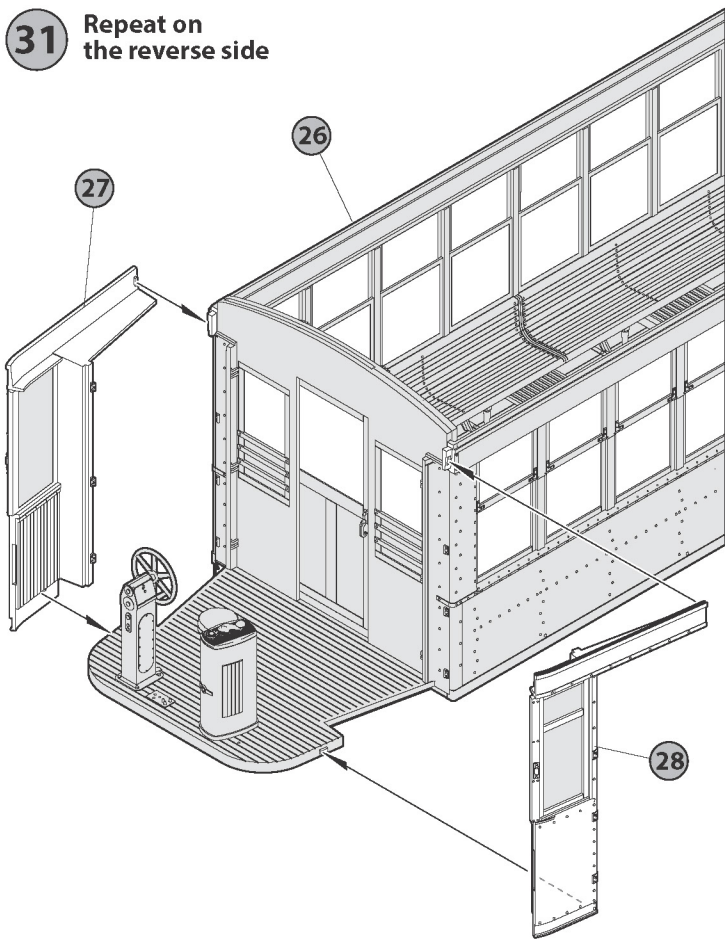

**32** Repeat on the reverse side

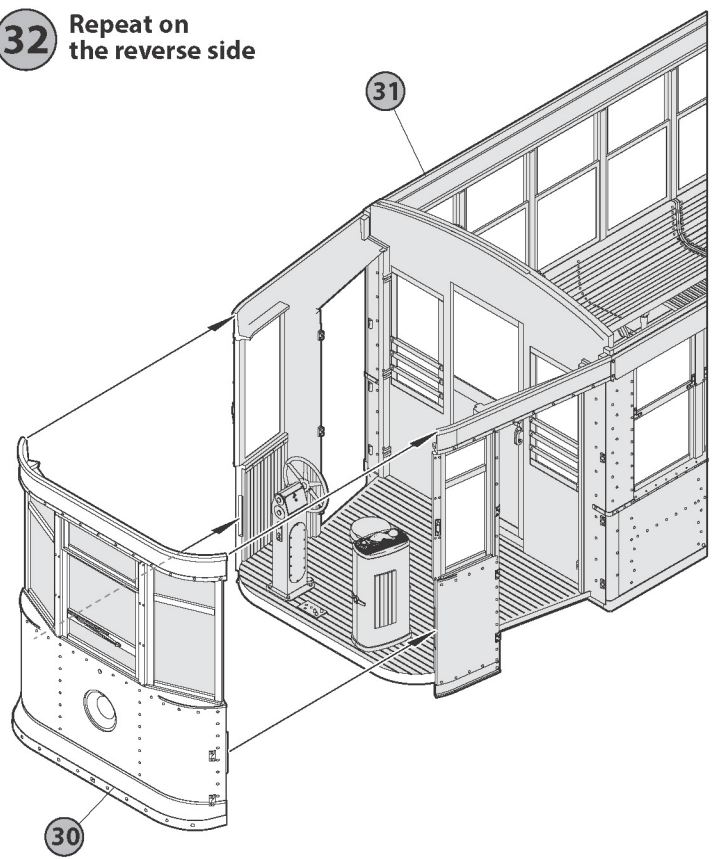

**33** x2

**A**

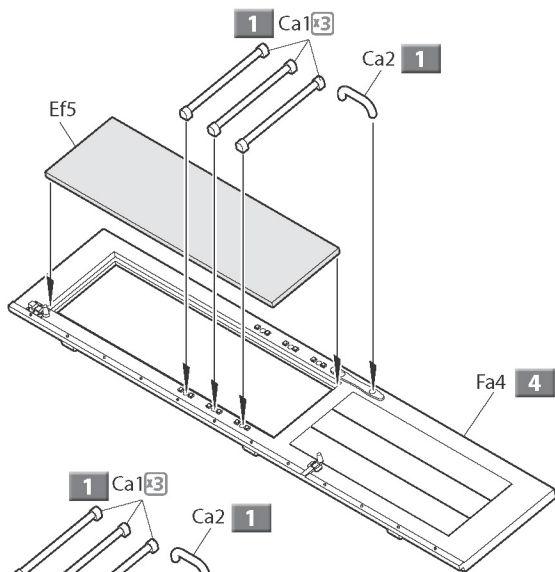

**B**

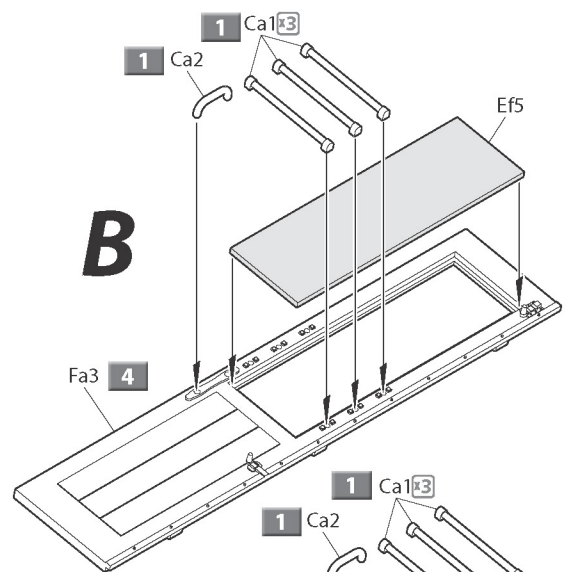

**C**

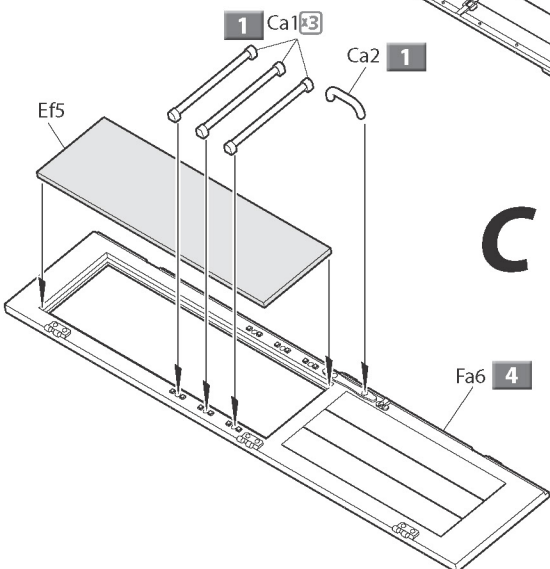

**D**

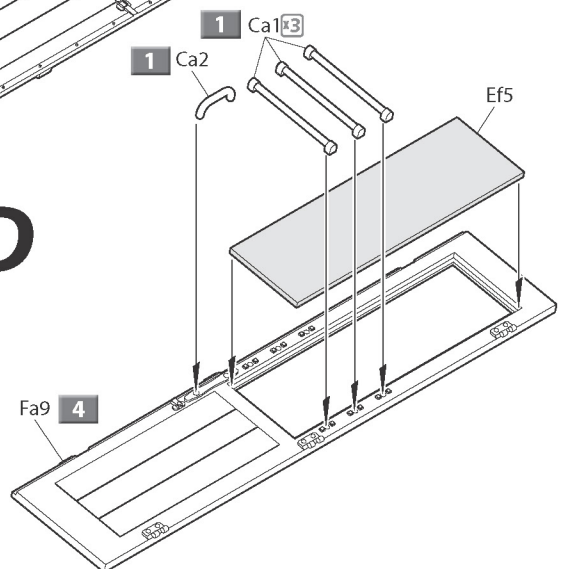

**34** x2

Repeat on the reverse side

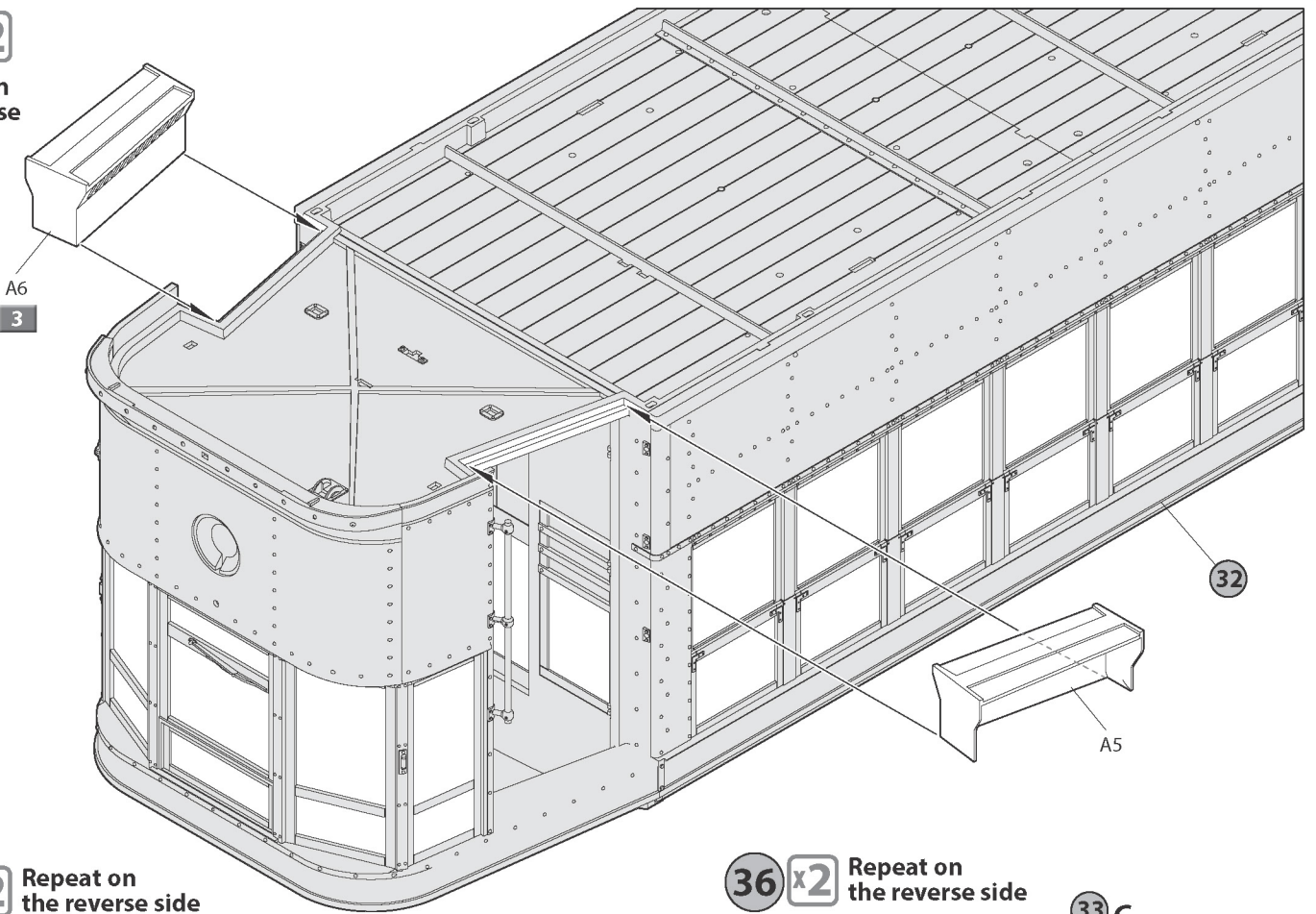

**35** x2

Repeat on the reverse side

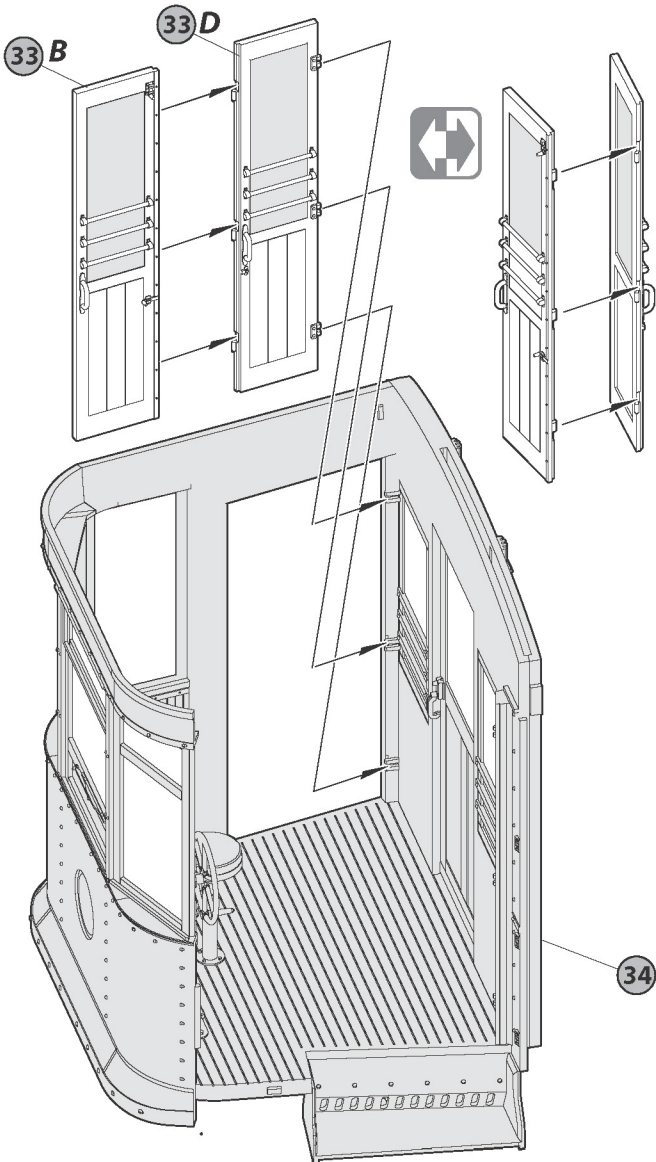

**36** x2

Repeat on the reverse side

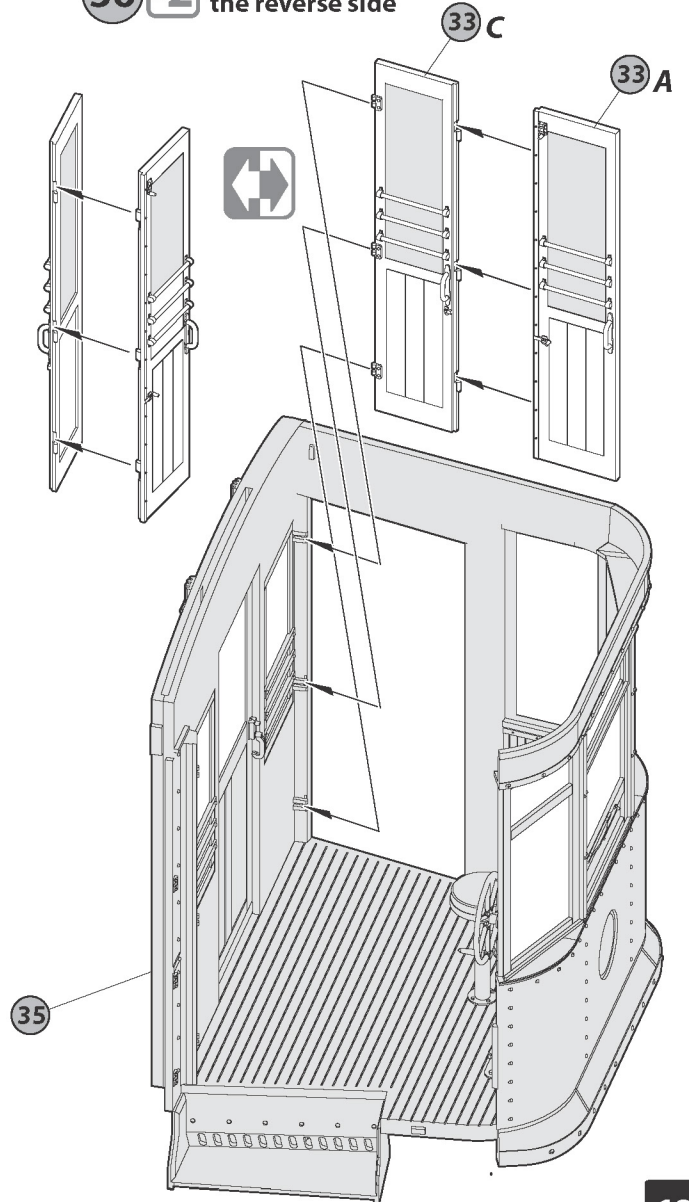

37 x2

Repeat on the reverse side

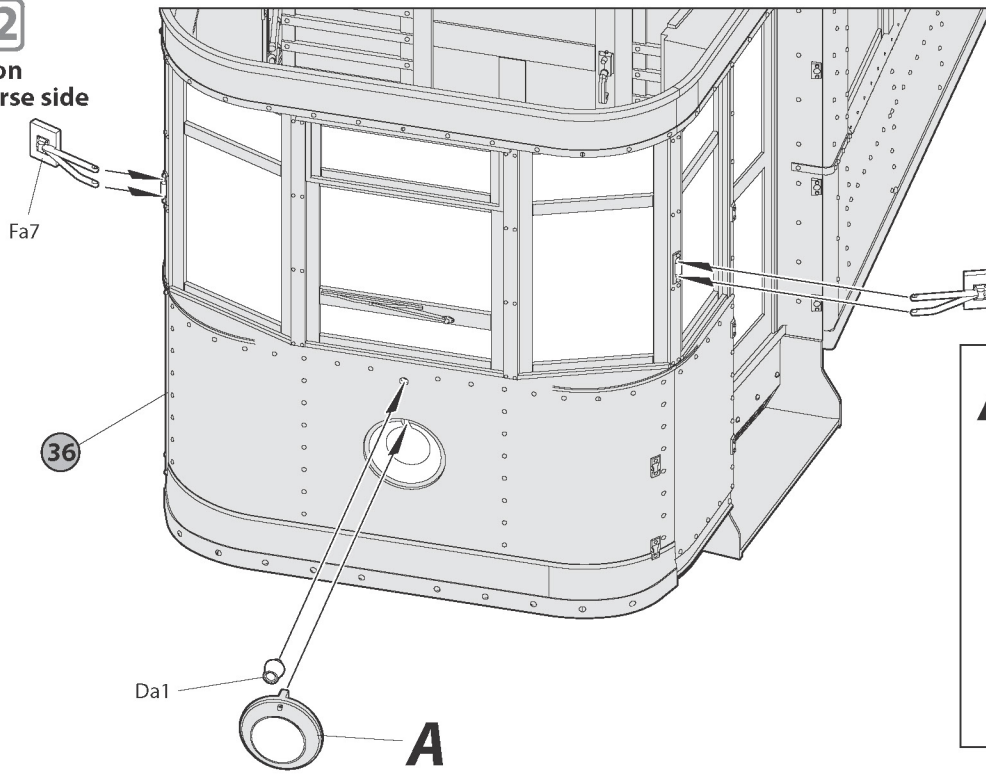

38 x2

Repeat on the reverse side

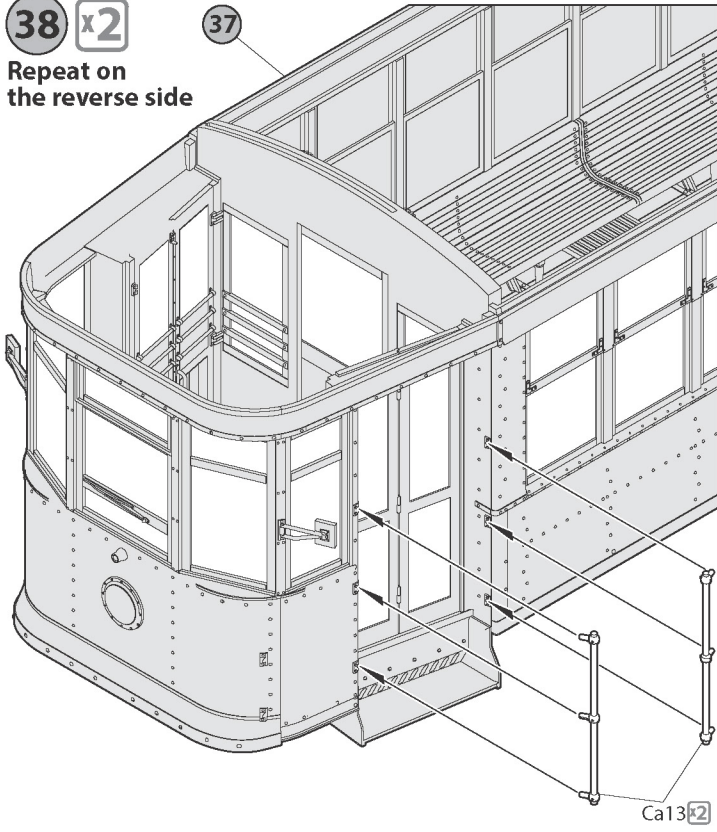

38 x2

Repeat on the reverse side

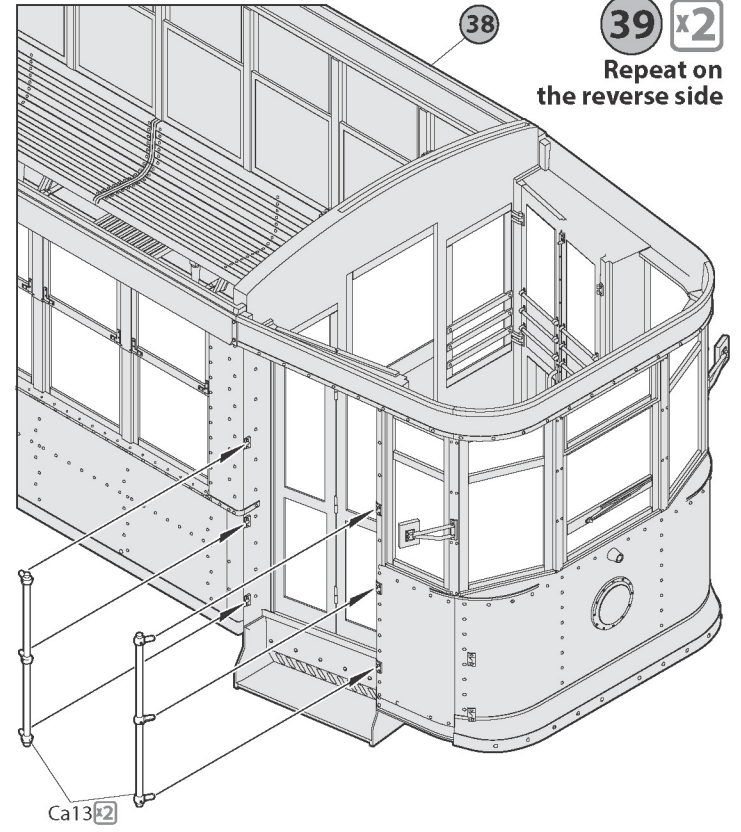

40 x2

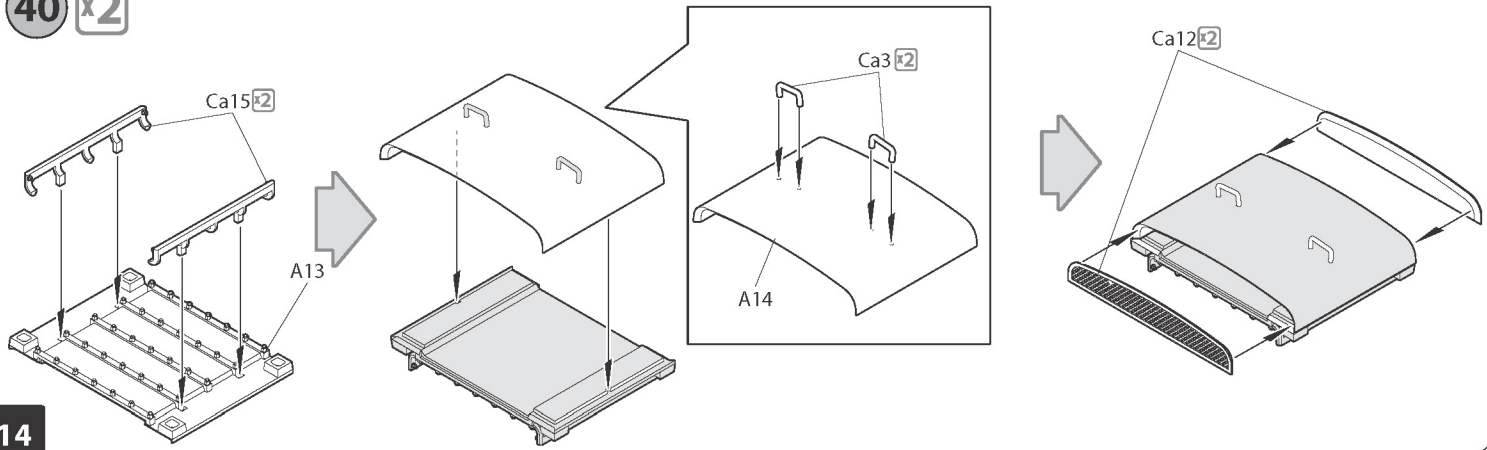

41

3

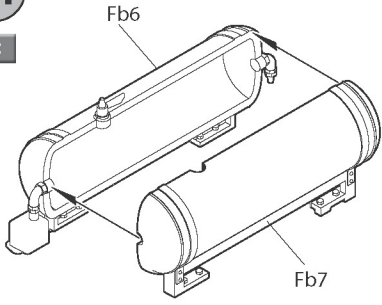

42

7 B20

B18 7

1 Ca19

B18 7

Ca19 1

Fb4

Fb1

Fb5

Fb11

Ca19 2

1

7 B20

39

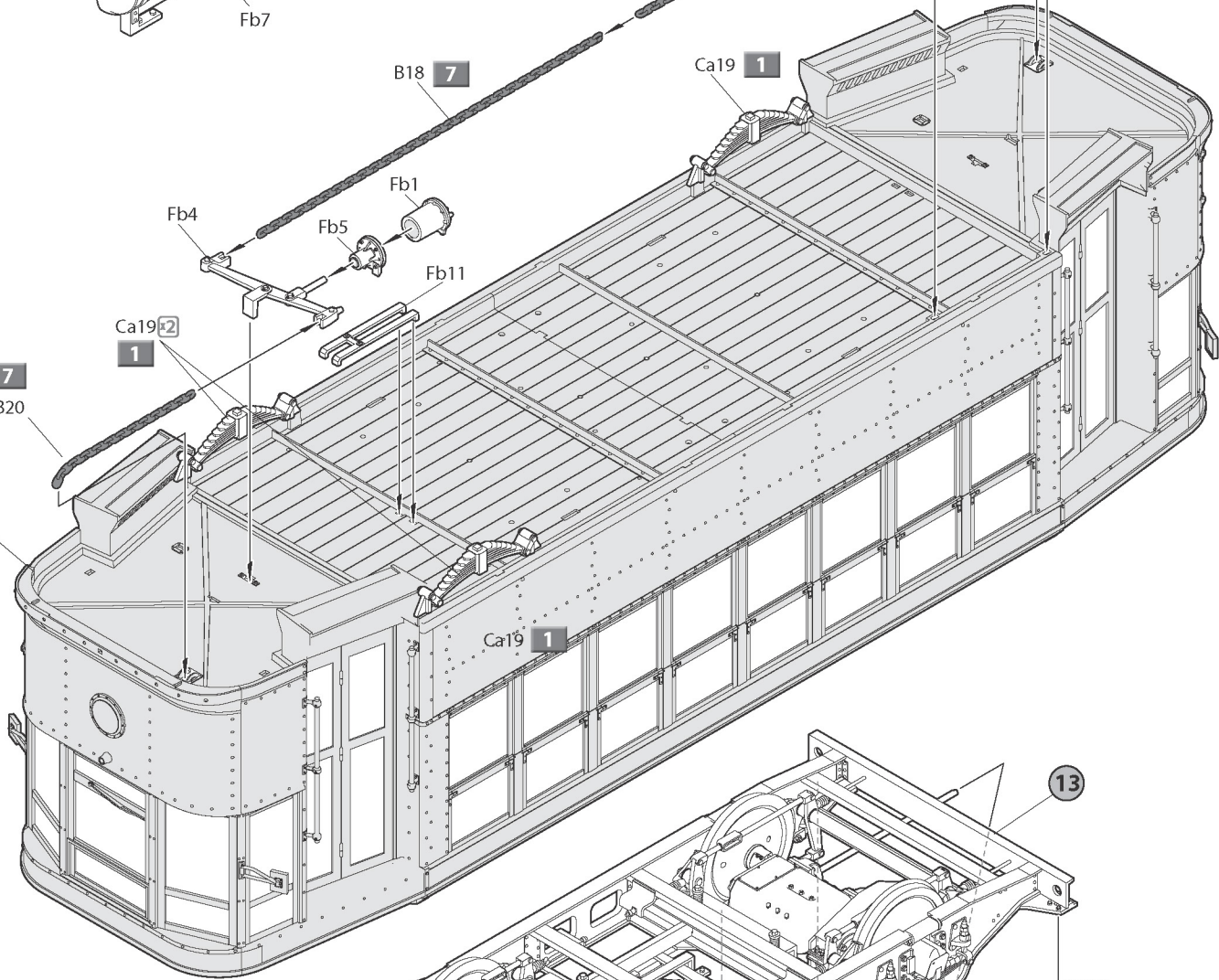

43

13

41

42

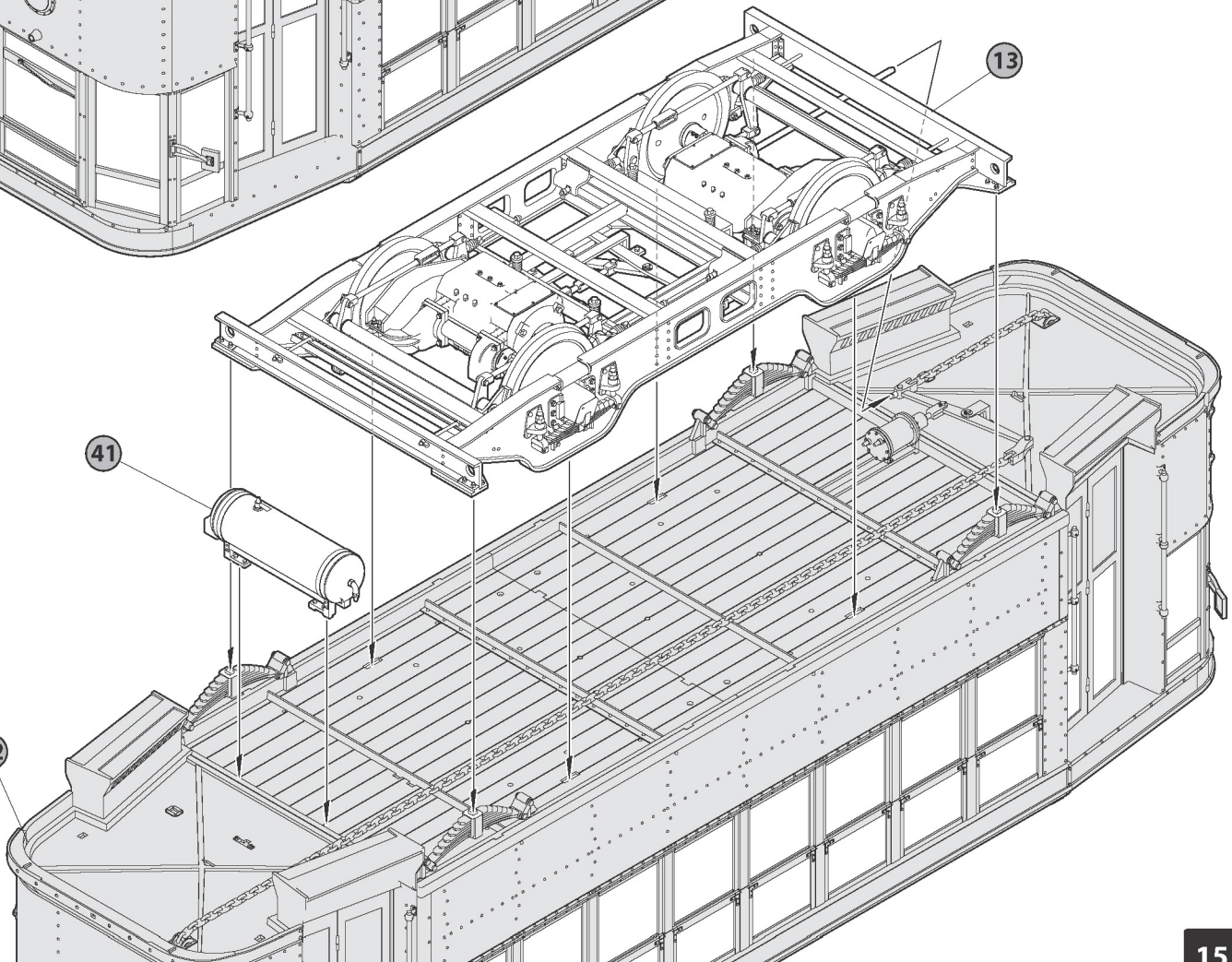

**44** x2 Repeat on the reverse side

**3**

**A**

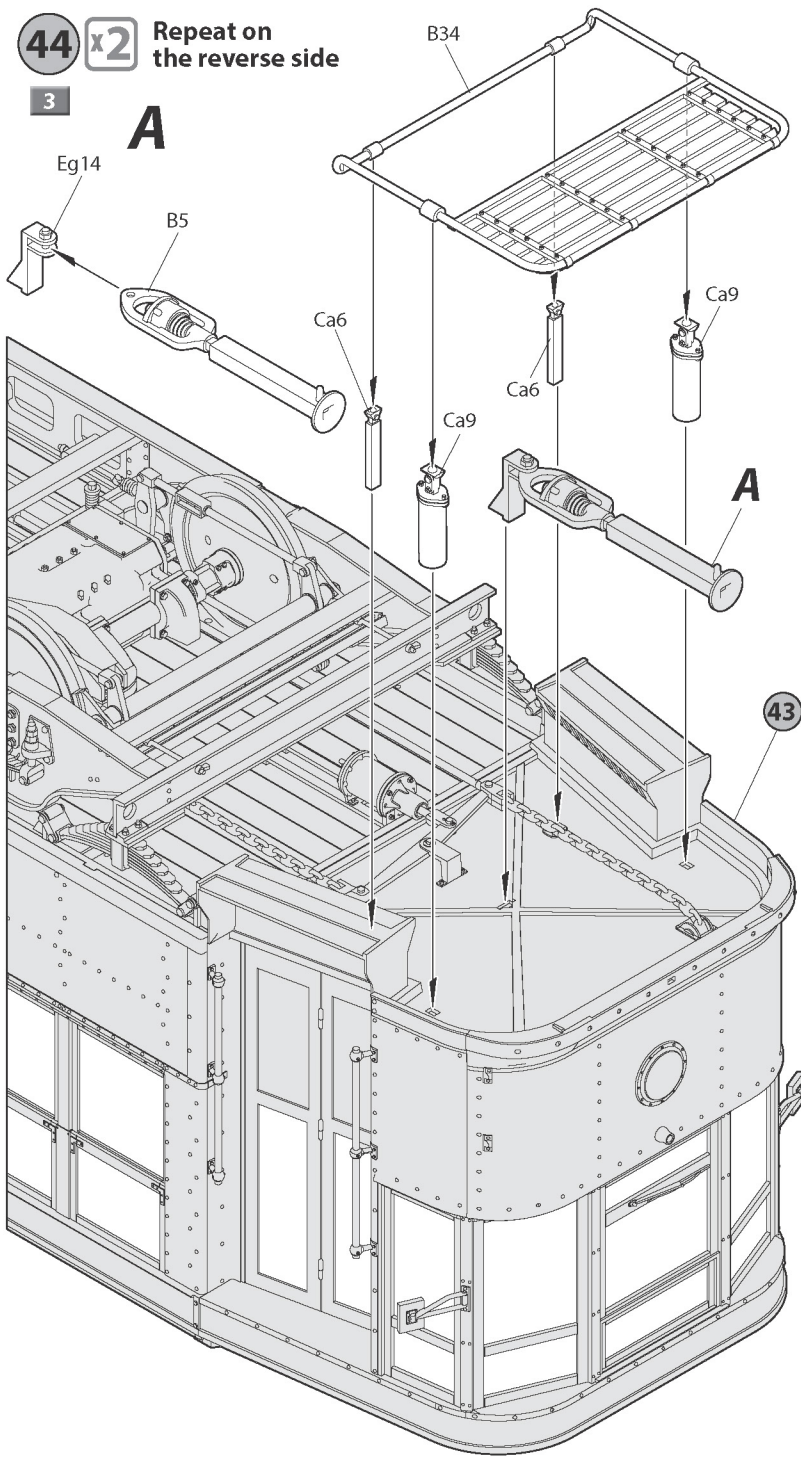

**45** x2 Repeat on the reverse side

**44**

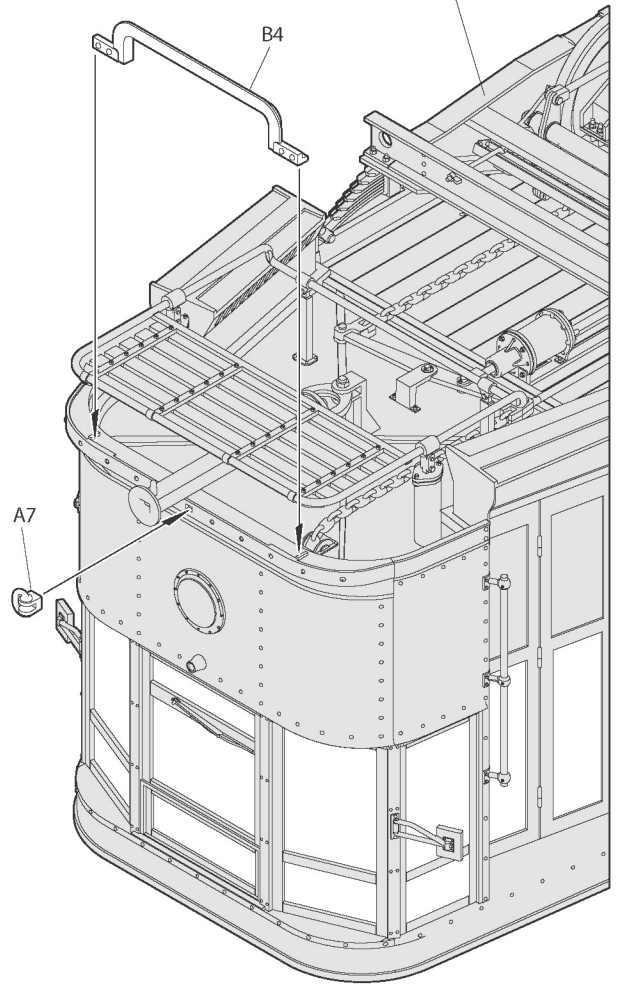

**46** x2

**A**

**B**

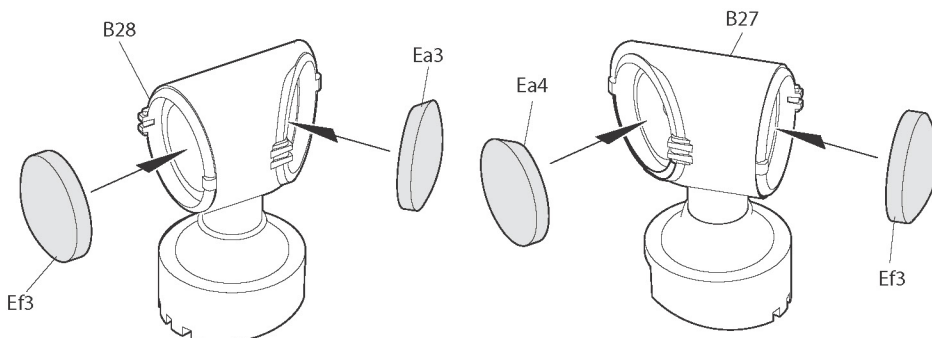

**47** x4

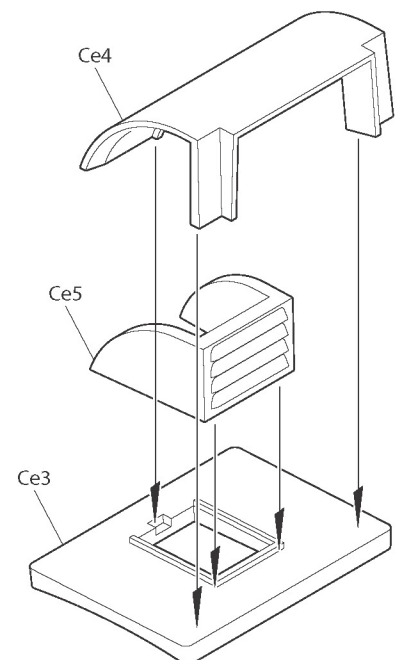



48 x2

Repeat on the reverse side

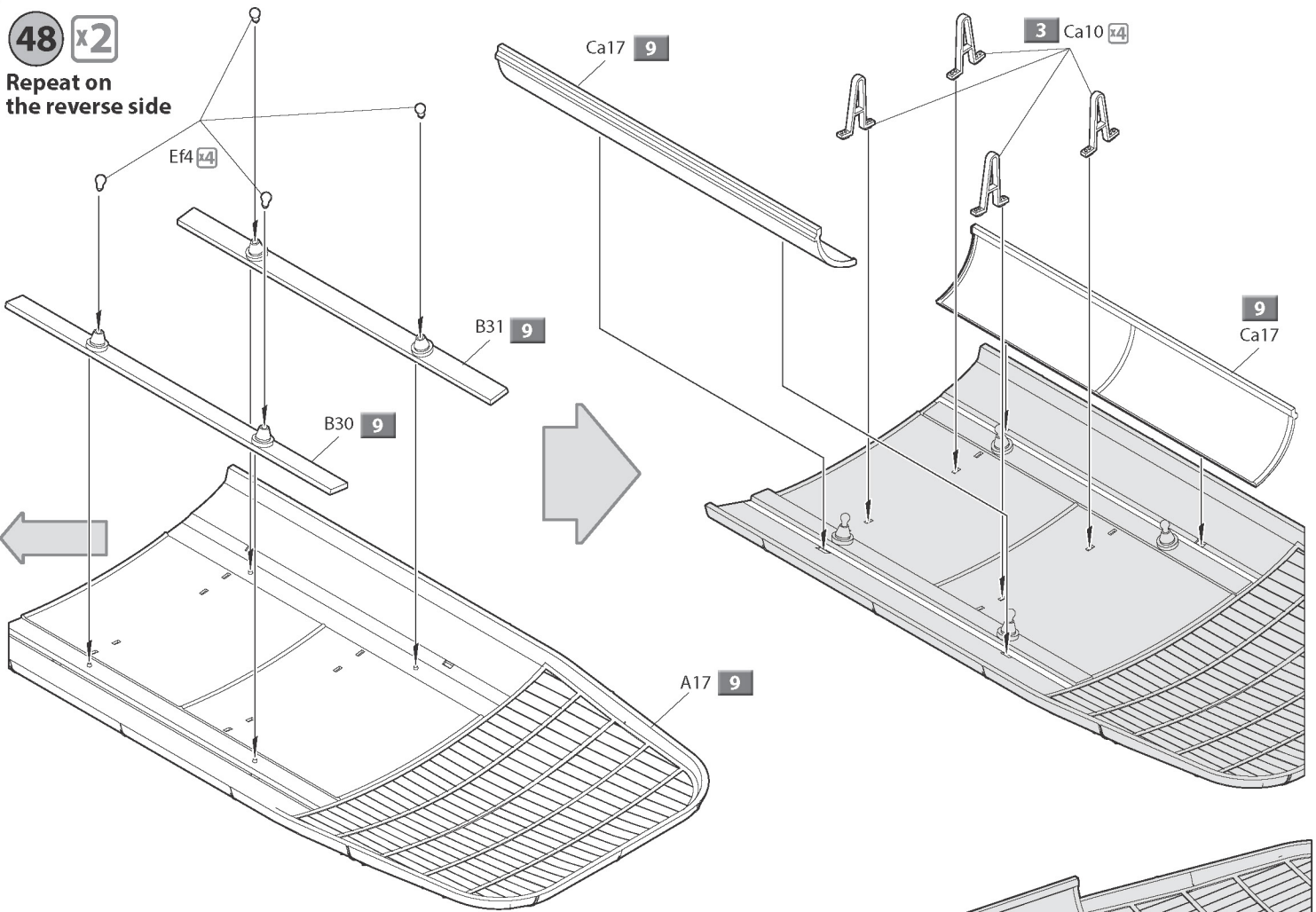

49

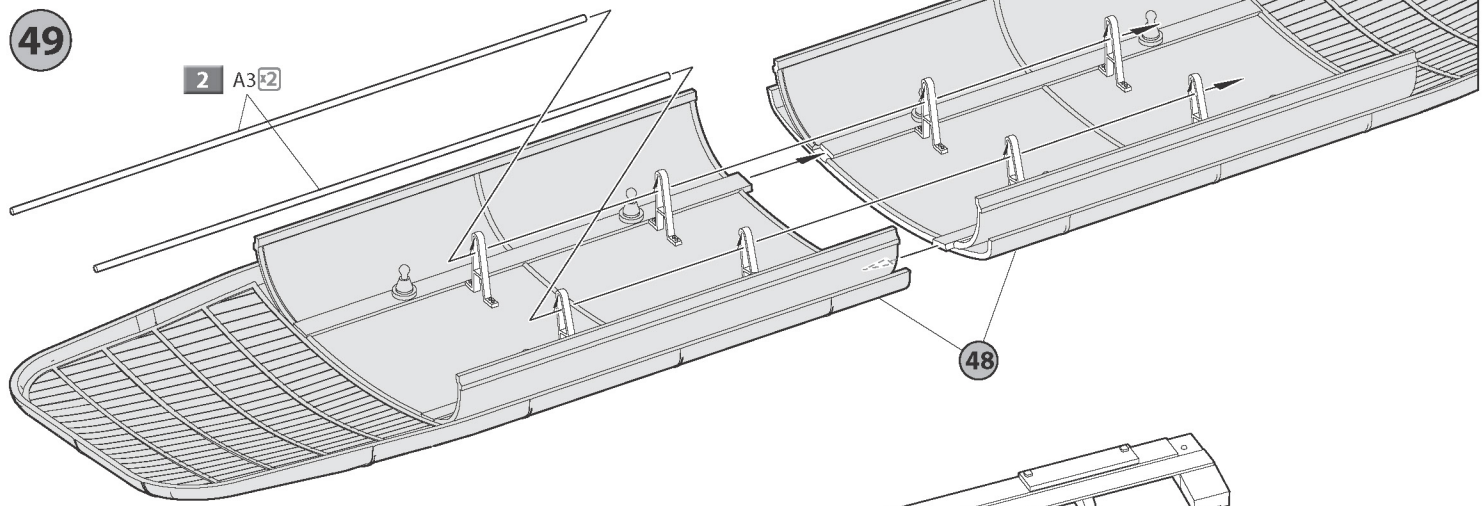

50

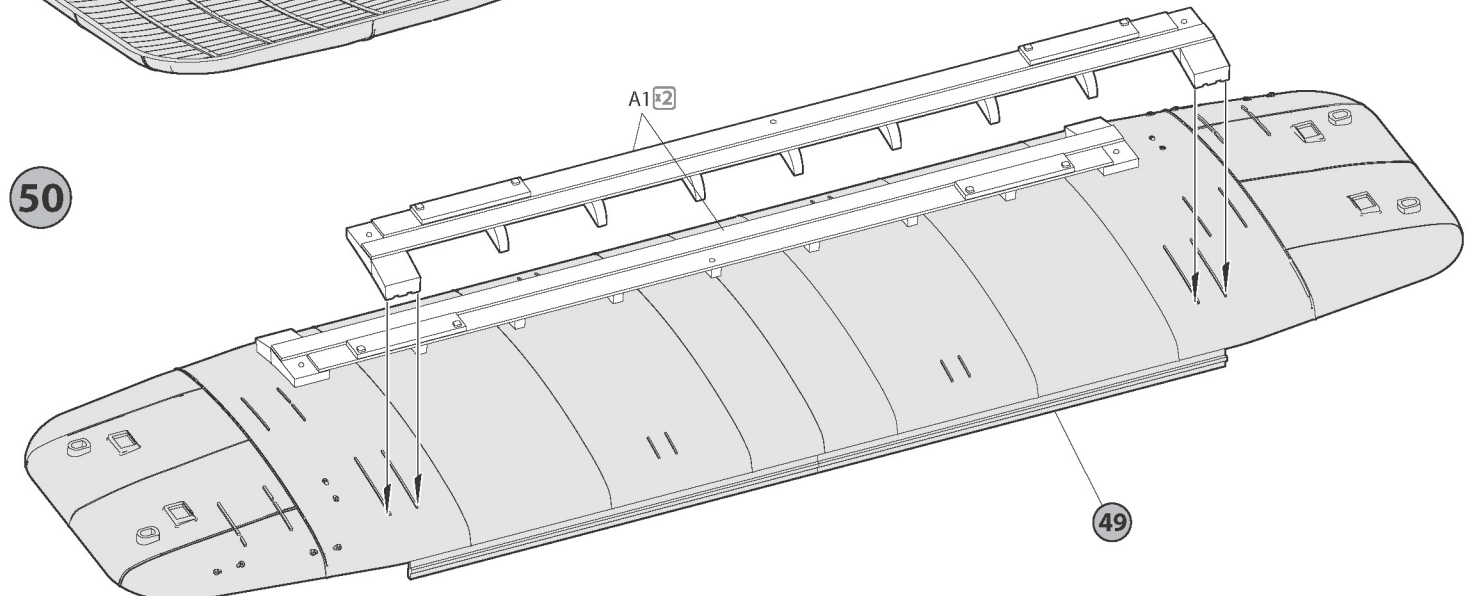

51

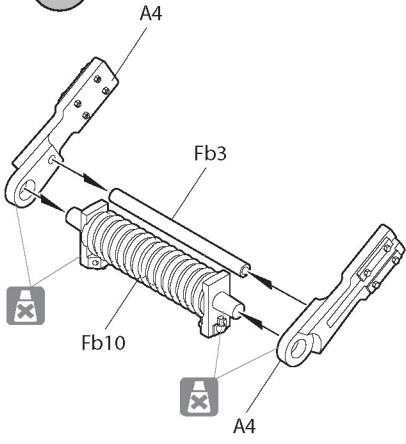

52 x2 Repeat on the reverse side

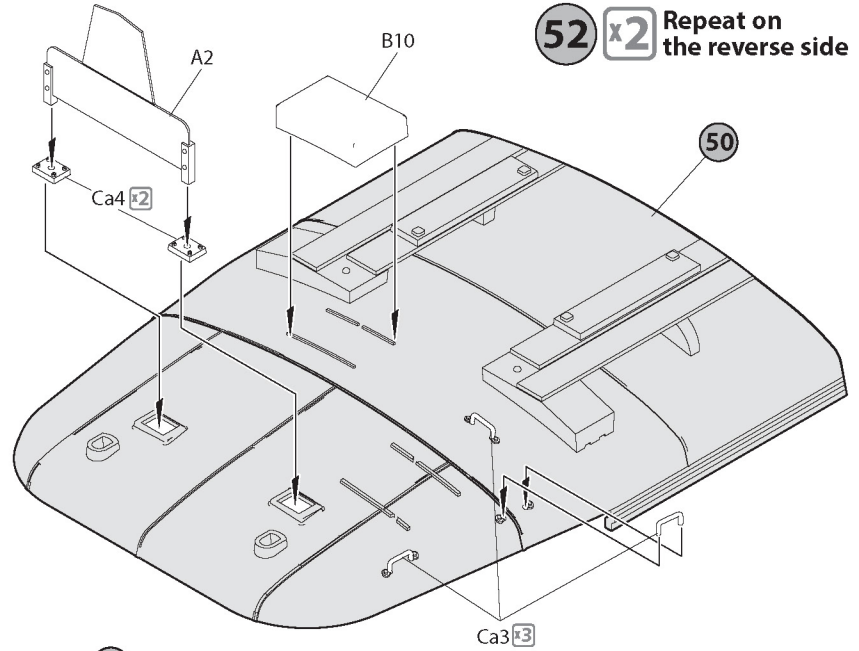

40

53 x2 Repeat on the reverse side

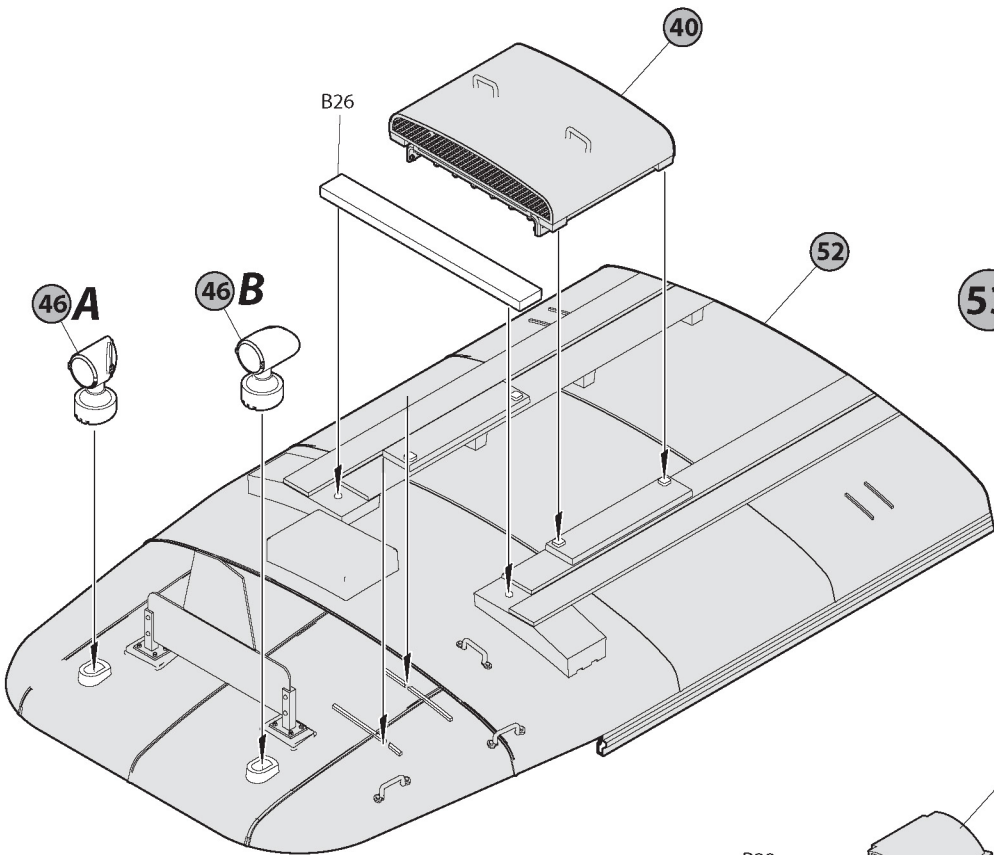

47

54 x2 Repeat on the reverse side

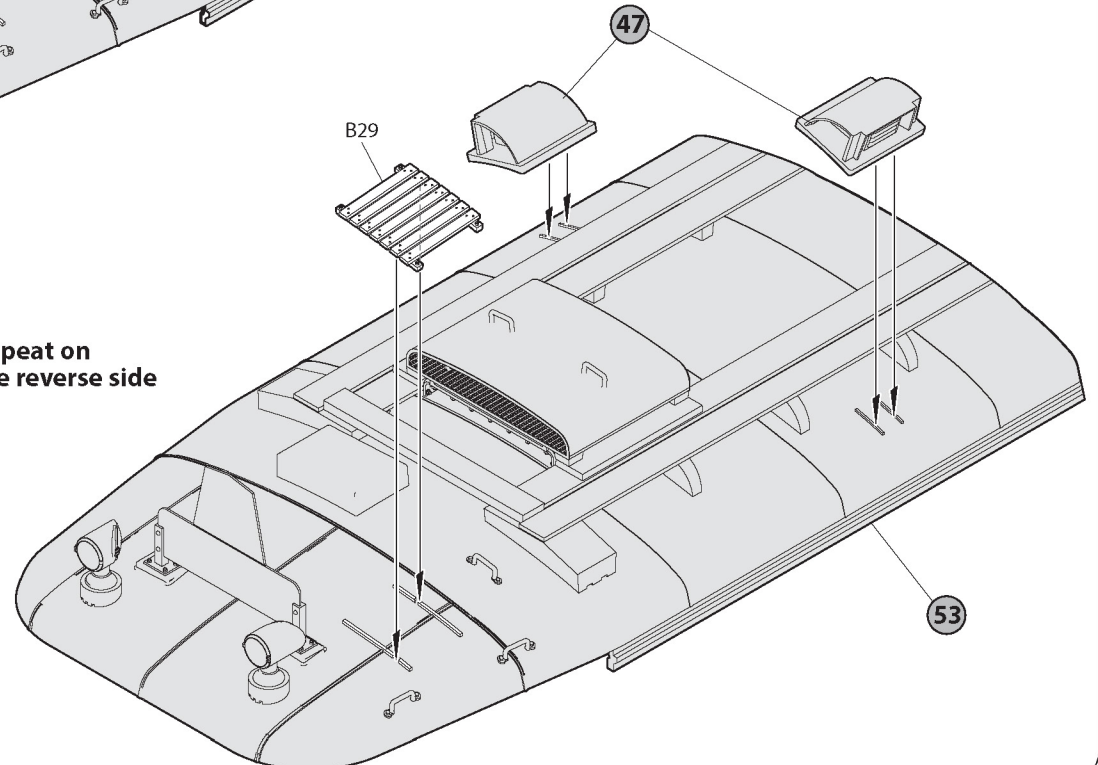

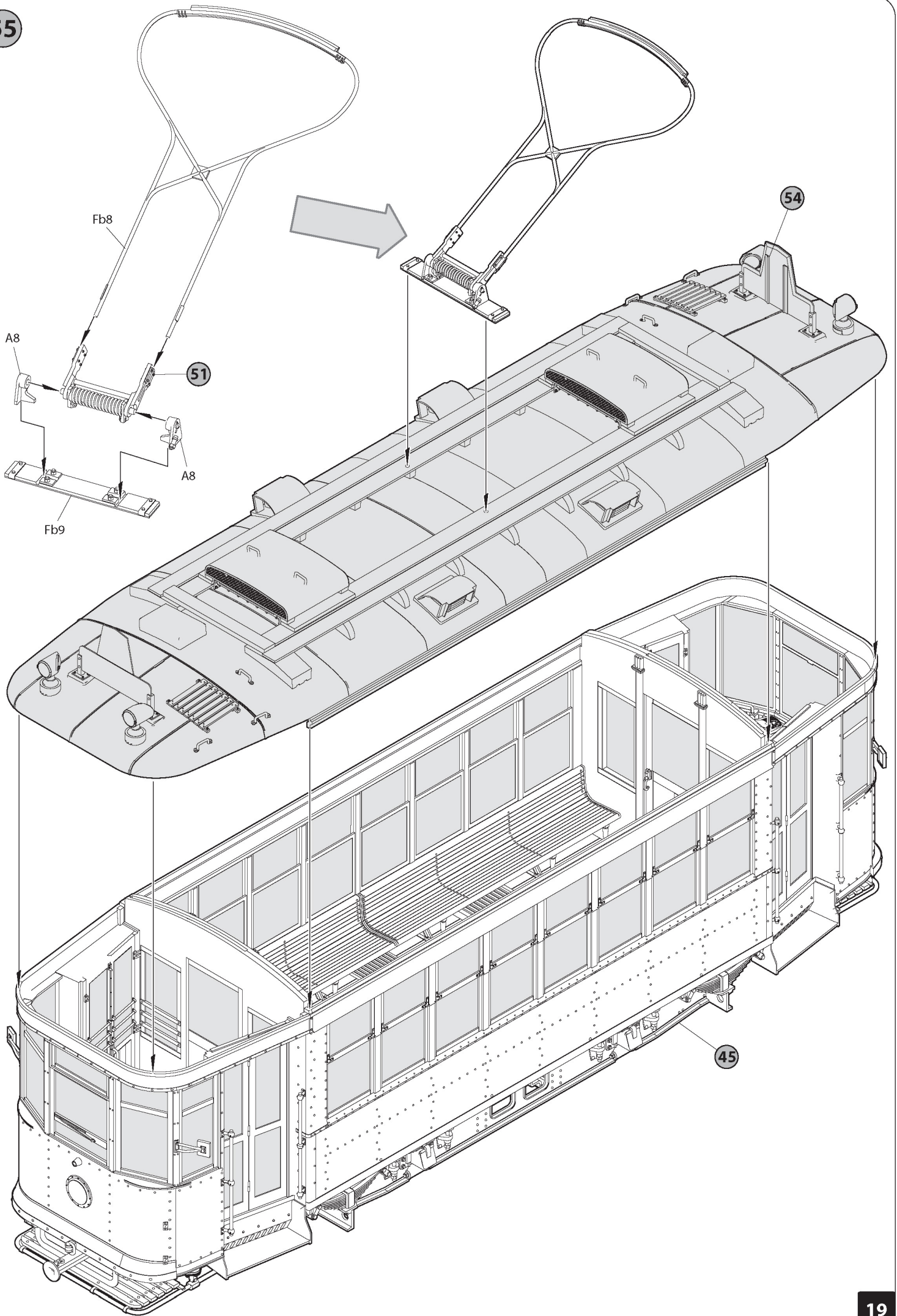

56 x2

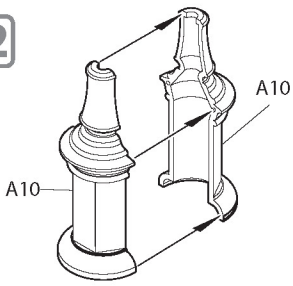

57 x2

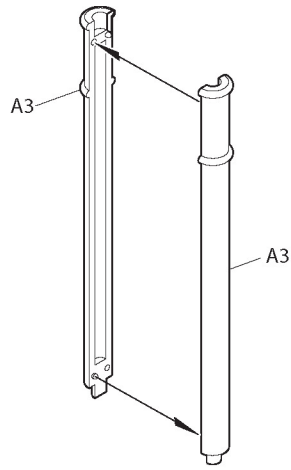

58 x2

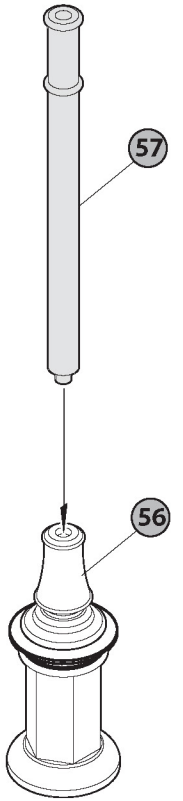

59 x2

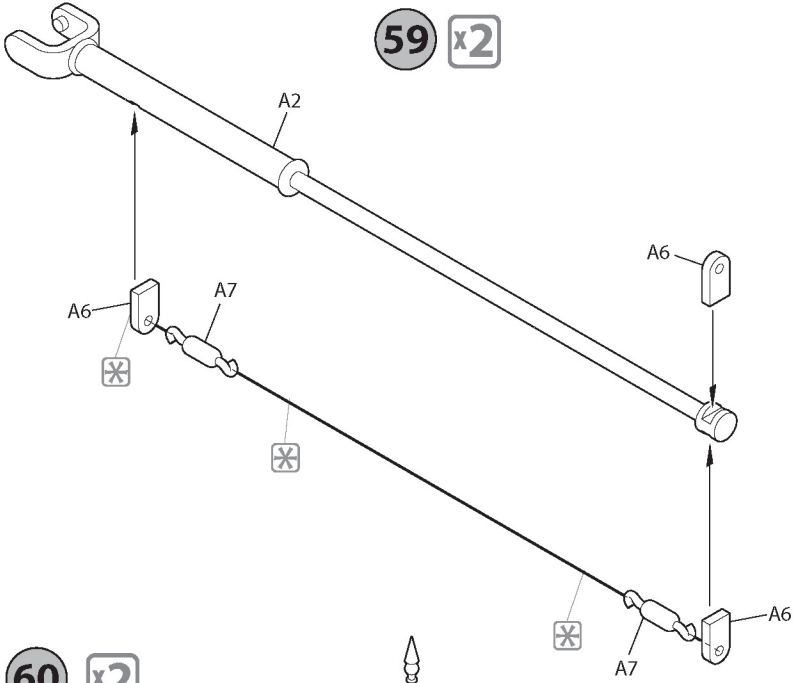

60 x2

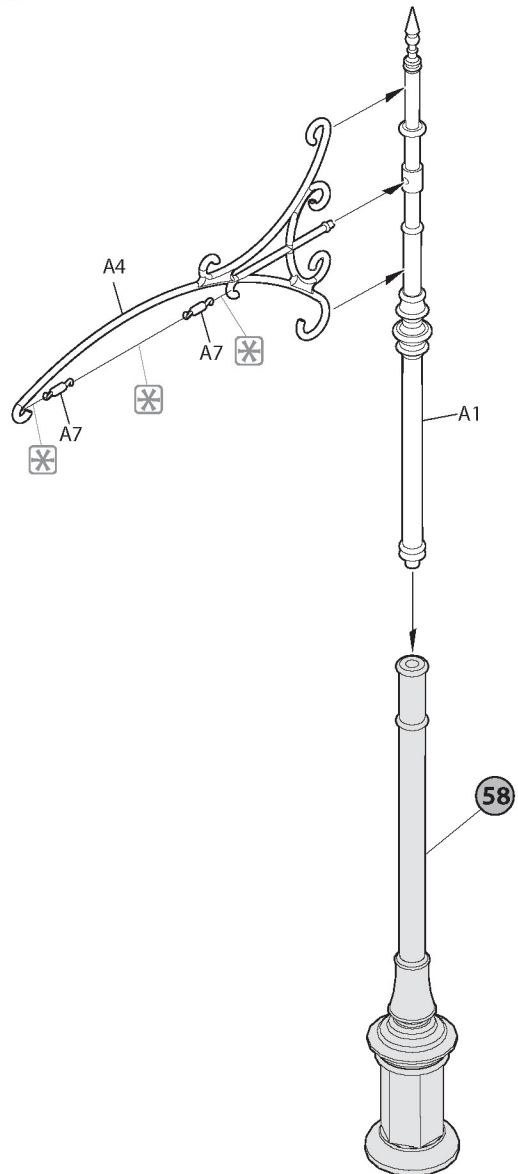
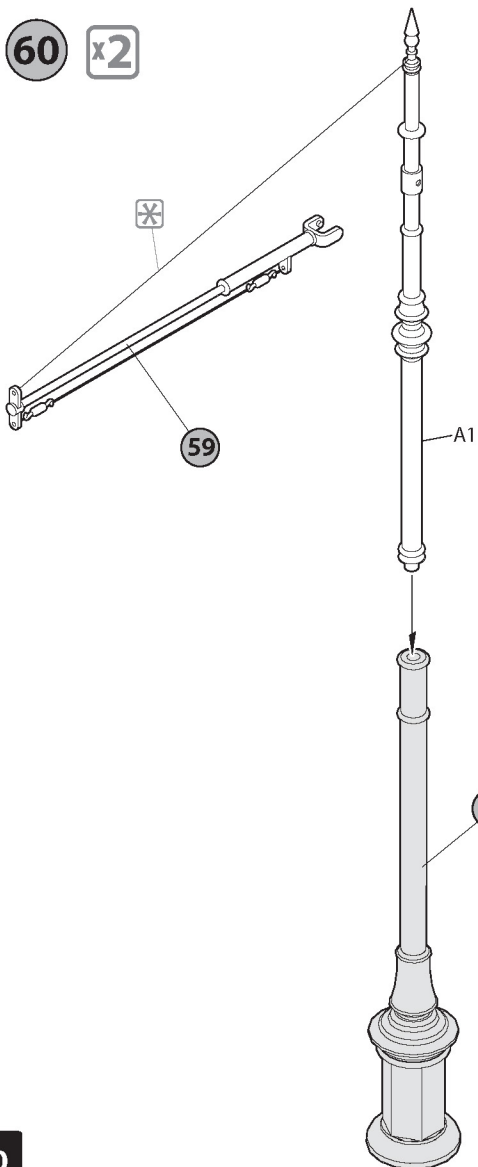

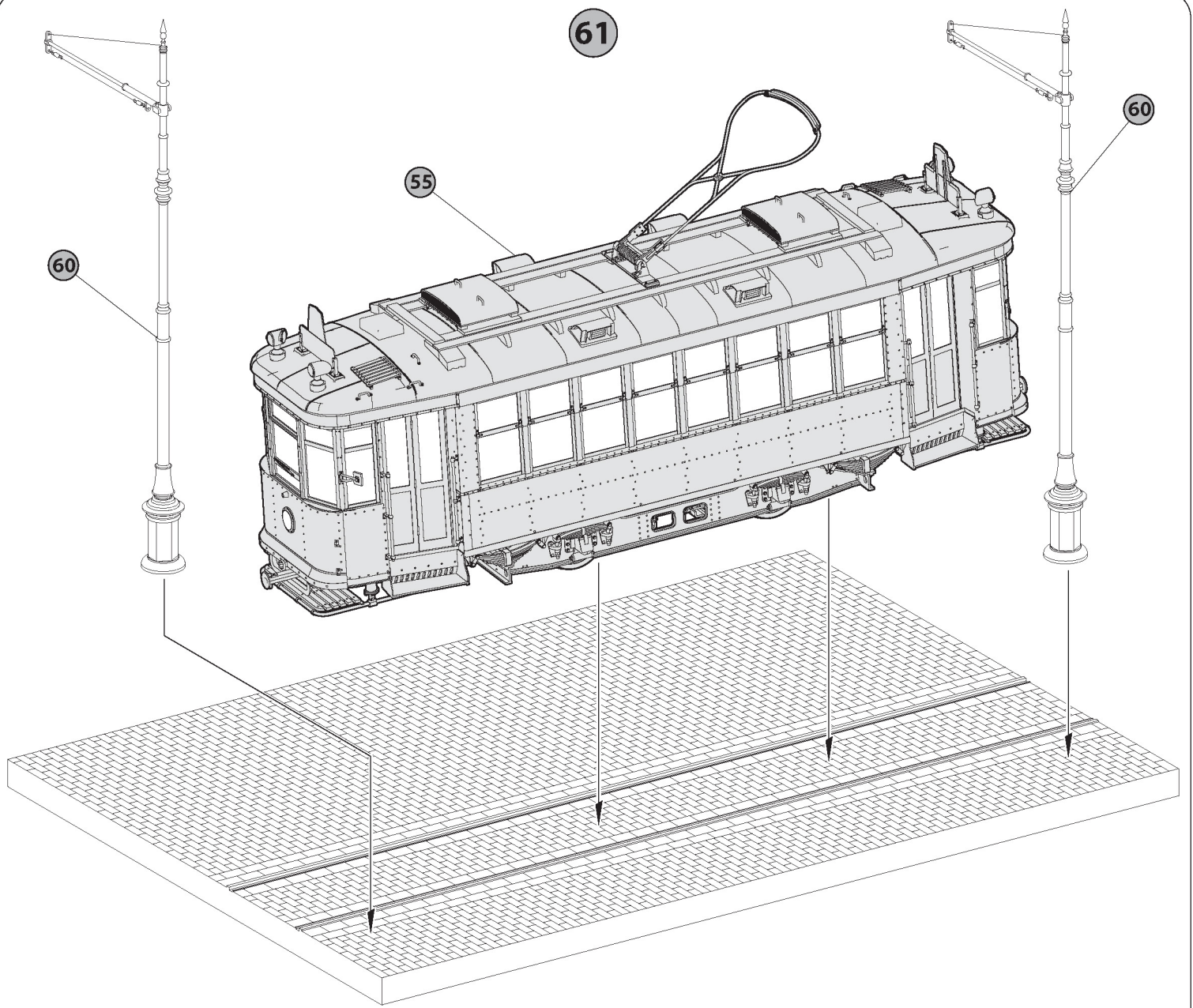

# RELATED ITEMS

**METAL TELEGRAPH POLES**  
BUILDINGS & ACCESSORIES SERIES

UNASSEMBLED PLASTIC MODEL KIT  
23 PLASTIC PARTS  
DECALS SHEET IS INCLUDED

35529  
PLASTIC MODEL KIT  
MiniArt

1:35

**STREET LAMPS & CLOCKS**

UNASSEMBLED PLASTIC MODEL KIT  
23 PLASTIC PARTS  
DECALS SHEET IS INCLUDED

35560  
1:35  
BUILDINGS & ACCESSORIES SERIES

**EUROPEAN TRAMCAR**  
STRÄßENBAHN TRIEBWAGEN 641  
w/CREW & PASSENGERS

UNASSEMBLED PLASTIC MODEL KIT  
CONTAINS 110 PARTS  
OF COMPLETE TRAM  
AND PASSENGERS  
AND CREW  
UNASSEMBLED  
PLASTIC MODEL KIT

38009  
1:35  
MINIATURES SERIES

**STREET ACCESSORIES**  
BUILDINGS & ACCESSORIES SERIES

UNASSEMBLED PLASTIC MODEL KIT  
THIS IS NOT A TOOL KIT  
KIT CONTAINS 44 PARTS  
AND CONTAINS MODELS OF  
STREET ACCESSORIES

35530  
1:35

**PAINTING GUIDE**  
ОКРАСКА

**4** Zaporizhzhia, 30-40s.  
Запорожье, 30-40-е годы.



**5** Kharkiv, 40s.  
Харьков, 40-е годы.

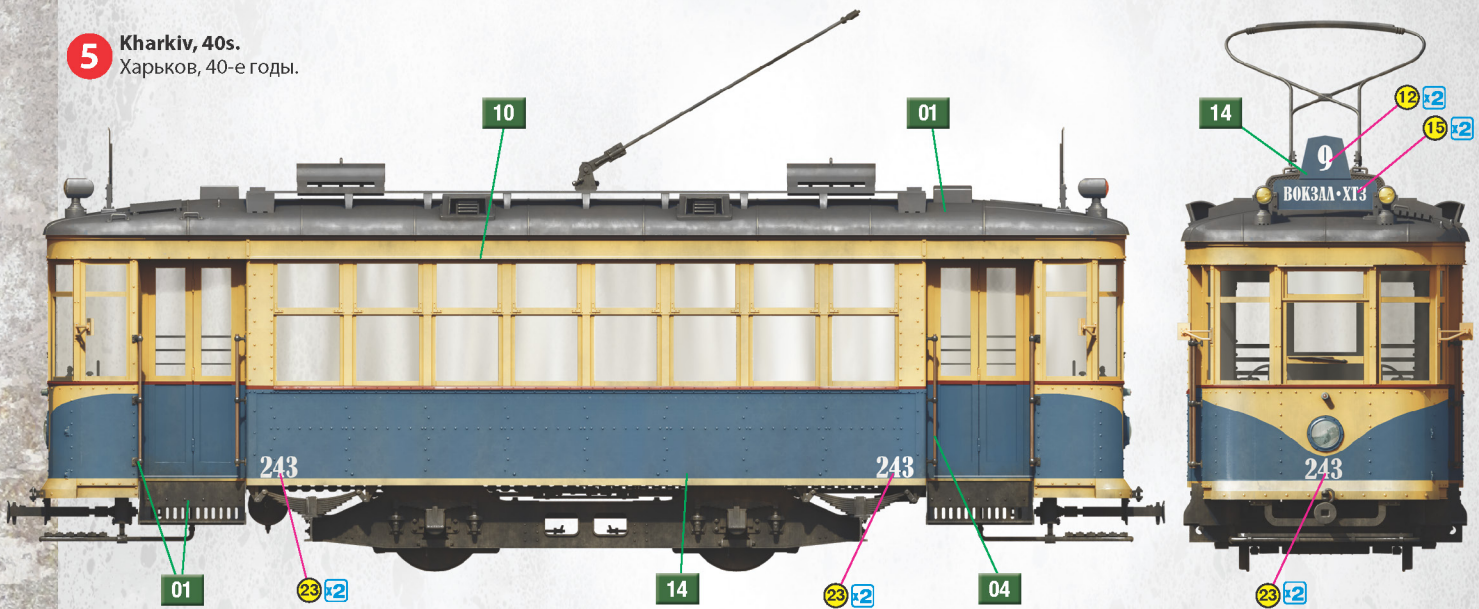

**6** Odesa Romanian occupation period, 1942.  
Одесса периода румынской оккупации, 1942 год.

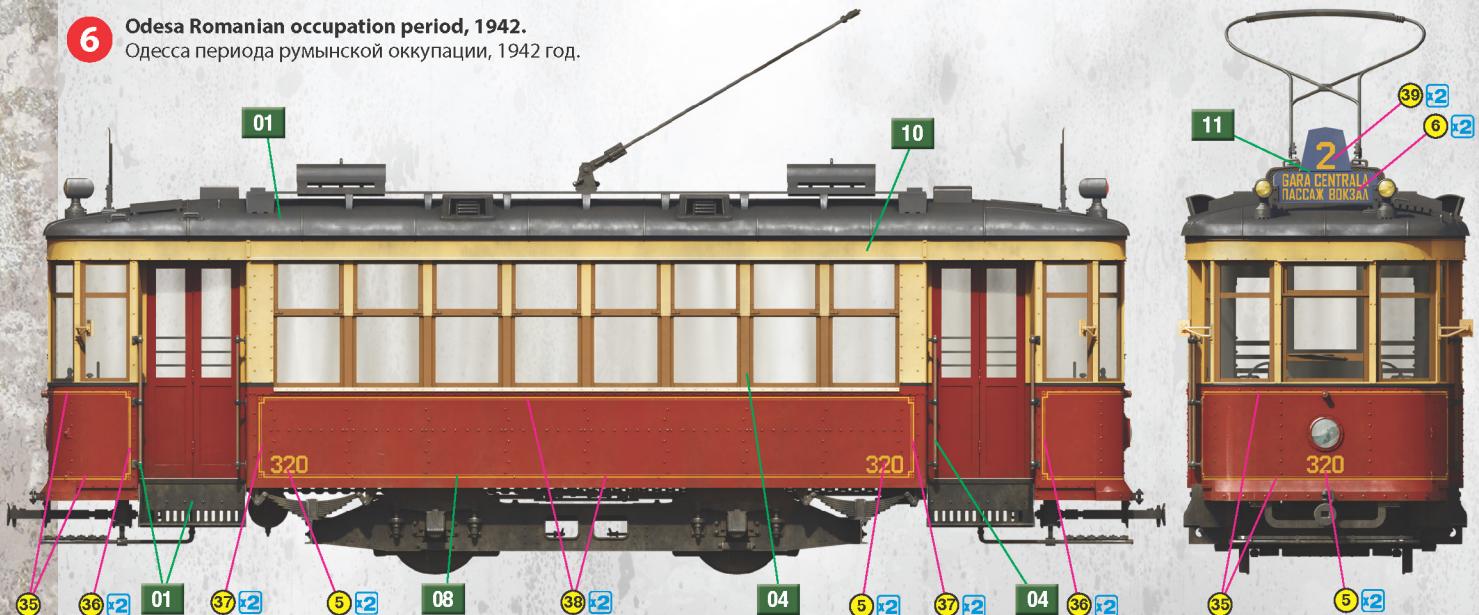

**PAINTING GUIDE**  
ОКРАСКА

**7** Minsk, 30-40s.  
Минск, 30-40-е годы.

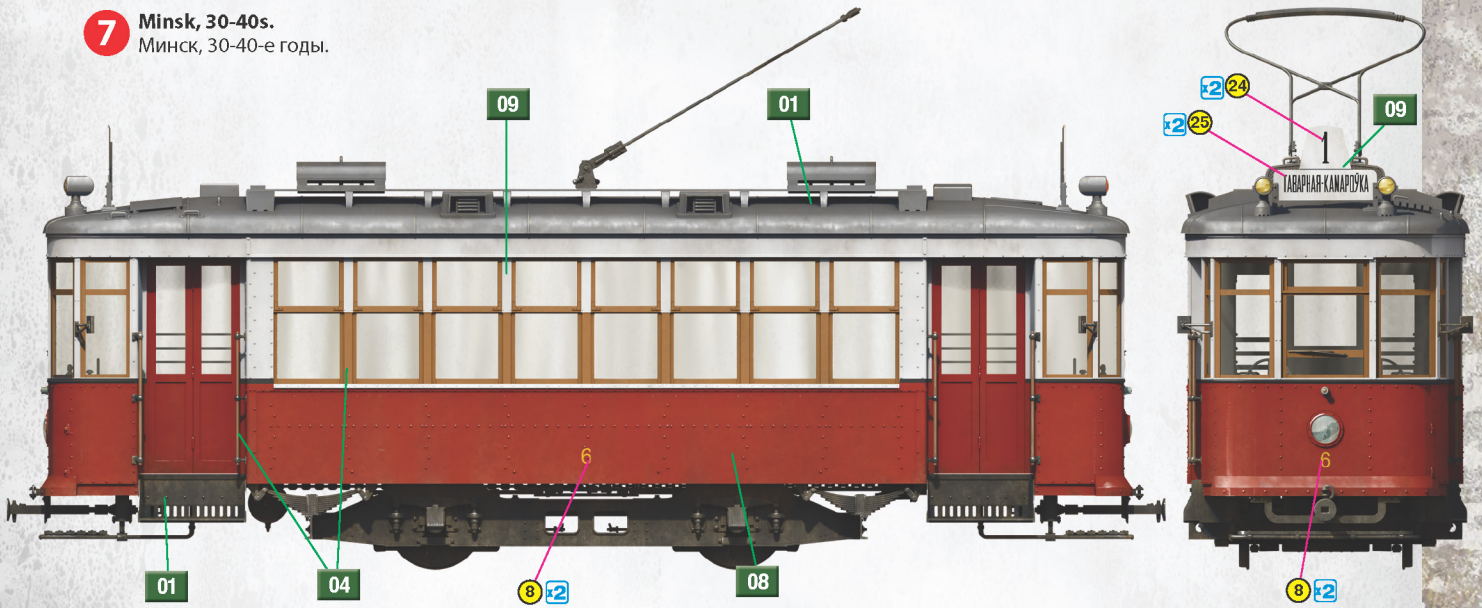

**8** Voronezh, 30-40s.  
Воронеж, 30-40-е годы.

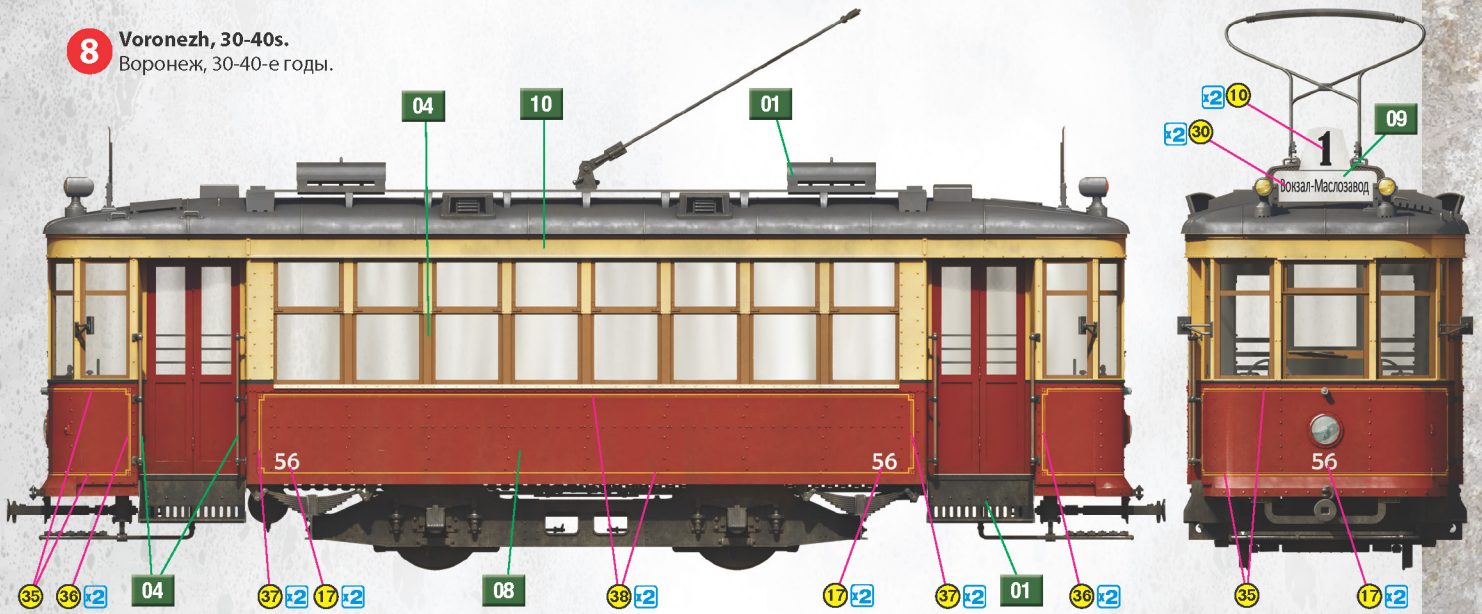

**9** Stalingrad (Volgograd now), 30-40s.  
Сталинград (Волгоград сейчас), 30-40-е годы.

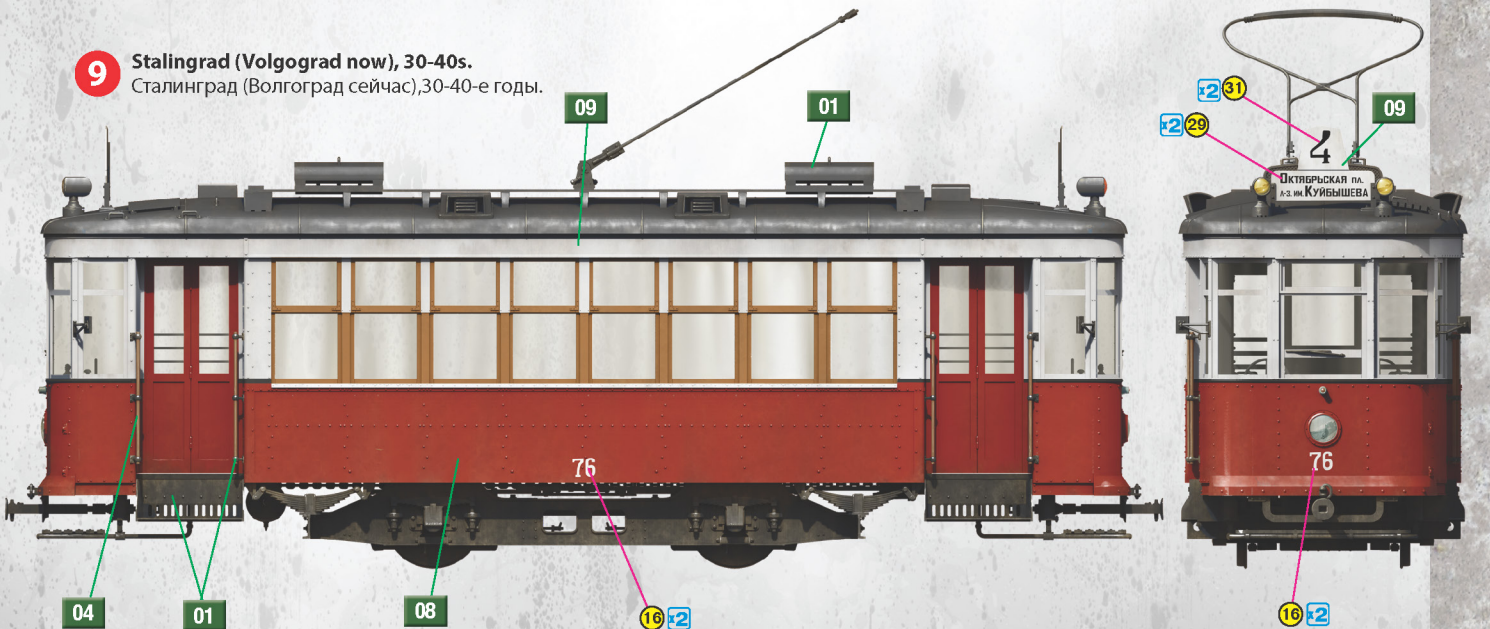



# SOVIET TRAM X -SERIES EARLY TYPE

SCALE  
**1:35**

PAINTING GUIDE  
ОКРАСКА

**10** Pskov, 1941.  
Псков, 1941 год.

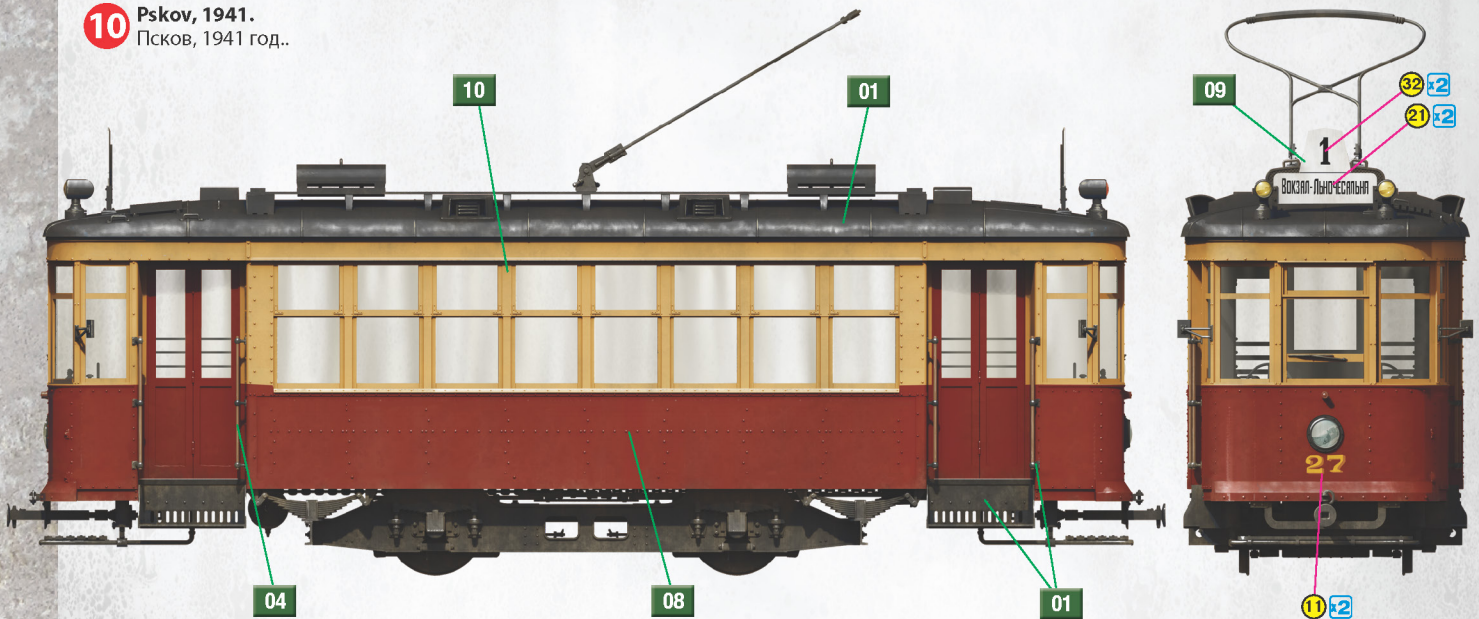

**11** Novorossiysk, 30-40s.  
Новороссийск, 30-40-е годы.



## Colors Chart

№	Color/Цвет	Vallejo	Mr. Color	Life Color	Tamiya	AK	Mission Models	Hataka	AMMO MIG	Название цвета	Color name
01		70.863	078	LC-076	XF-84	RC-015	MMM-001	106	A.MIG-0045	Вороненный металл	Gun Metal
02		70.997	8	LC-074	X-11	RC-020	MMM-006	003	A.MIG-0195	Серебристый	Silver
03		70.950	033	LC-002	XF-01	RC-001	MMP-047	041	A.MIG-0046	Черный	Black
04		70.311	043	UA-714	XF-78	RC-029	MMP-076	013	A.MIG-0037	Дерево	Wood
05		71.818	029	LC-016	XF-64	RC-067	MMP-012	131	A.MIG-0913	Красно-коричневый	Red Braun
06		70.864	028	LC-024	XF-56	AK-457	MMM-002	033	A.MIG-0191	Сталь	Steel
08		70.957	003	LC-006	XF-07	RC-006	MMP-003	103	A.MIG-0049	Красный	Red
09		70.951	062	LC-001	XF-02	RC-004	MMP-001	043	A.MIG-0050	Белый	White
10		70.953	004	UA-140	XF-03	RC-007	MMP-041	066	A.MIG-0048	Желтый	Yellow
11		70.965	005	LC-010	XF-17	RC-036	MMP-065	255	A.MIG-0086	Синий	Blue
12		70.894	136	UA-059	XF-67	RC-047	MMP-009	021	A.MIG-0916	Зеленый	Green
13		70.902	370	LC-008	XF-50	RC-291	MMP-092	028	A.MIG-0257	Лазурный Синий	Azure Blue
14		70.943	322	UA-609	XF-50	RC-055	MMP-061	283	A.MIG-0210	Серо-Синий	Grey Blue