

# PZ.KPFW.IV AUSF. MID PROD. NIBELUNGENWERK. (SEP-NOV 1944)

35339



## GENERAL INSTRUCTION

- HIGHLY DETAILED MODEL
- DRIVER COMPARTMENT INTERIOR ACCURATELY REPRESENTED
- FULLY DETAILED FIGHTING COMPARTMENT INTERIOR
- HIGHLY DETAILED INTERIOR OF TURRET

- ALL HATCHES CAN BE POSED OPEN & CLOSED
- FULL AMMUNITION INCLUDED
- ENGINE INCLUDED
- WORKABLE TRACKS INCLUDED
- CLEAR PLASTIC PARTS INCLUDED
- PHOTO-ETCHED PARTS INCLUDED
- DECAL SHEET FOR 6 OPTIONS

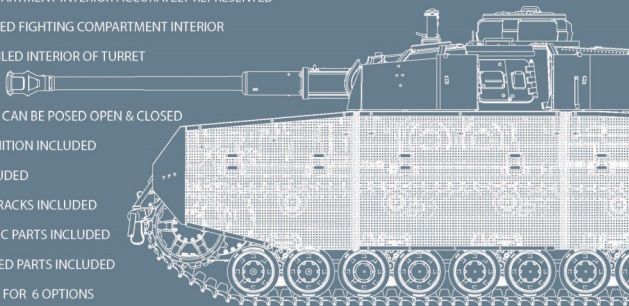

# Pz.Kpfw.IV Ausf. J Nibelungenwerk. Mid Prod. (Sep-Nov 1944)

SCALE  
**1:35**

PAINTING GUIDE **1** 6. Pz.Rgt. 3. Pz. Div. Poland, Autumn 1944. Variant 1.

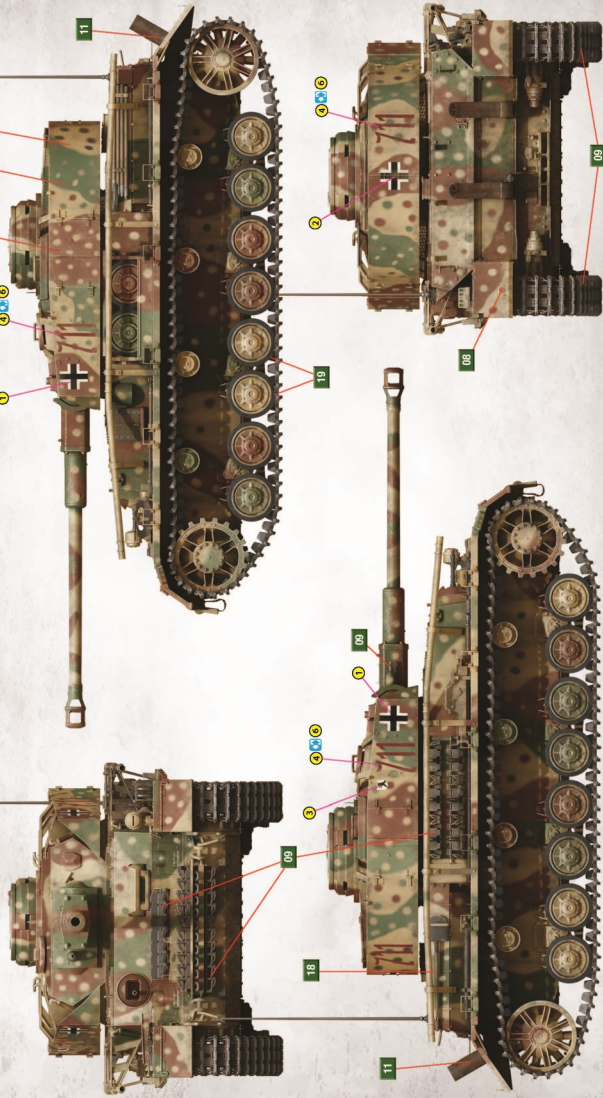

# Pz.Kpfw.IV Ausf. J Nibelungenwerk. Mid Prod. (Sep-Nov 1944)

SCALE  
**1:35**

PAINTING GUIDE **2** 6. Pz.Rgt. 3. Pz. Div. Poland, Autumn 1944 (with Torma schützen). Variant 2.



**ATTENTION**  
Ne pas utiliser de colle ou de peinture a proximité d'une flamme nue, et aérer la pièce de temps en temps.  
Pour retirer les pièces hors du cadrn, utiliser des ciseaux spectraux pour marquer le plastique en enchi avec un cutter ou une lime.  
Voi la fin de cette colonne pour la signification des symboles.  
Après l'assemblage peut rester des pièces inutilisées.

**УВАГА**  
При використанні клею та фарб всі роботи проводити подаль від джерел вогню у приміщенні, що добре провітрюється.  
Деталі відкривати від ліпіння ножем або іншим ріжучим інструментом. Зачистити обробку і місця злизу за допомогою надфайла та надчасного паперу. Будівництво моделі виконувати тільки в сухому приміщенні.  
Для зручності побудови кожна деталь позначена номером.  
Після складання можуть залишитися невикористані деталі.

**ВНИМАНИЕ**  
При использовании клея и красок все работы производить в проветриваемом помещении вдали от источников огня.  
Детали отделять от литьевого носика или другим режущим инструментом. Зачистите обробку і місця злизу при помощи надфайла и наждачной бумаги. Сборку моделей производить согласно схеме сборки.  
Для удобства сборки каждая деталь обозначена номером.  
После сборки набора могут остаться неиспользованные детали.

**ZUR BEACHTUNG!**  
Kleber und Farbe nicht nahe von offenem Feuer verwenden und das Fenster von Zeit zu Zeit zur Belüftung öffnen.  
Zum Abschneiden der Teile vom Werbündstück eine Modellierschere verwenden und die überschüssigen Plastikteile mit einem Meißel oder einer Feile beseitigen.  
Die Bedeutung der Symbolschäule finden Sie unten in dieser Spalte.  
Nach dem Zusammenbau des Modells, können einzelne Teile übrig bleiben

**ATTENZIONE**  
Non usare colla e vernice vicino a fiamme esposte, e aprire le finestre di tanto in tanto per cambiare l'aria. Quando si staccano parti del cartello, usare forbici da modellismo e eliminare la plastica in eccesso con un coltello o una lima. Vedere in fondo a questa colonna per il signifi. Dopo l'assemblaggio possono rimanere parti inutilizzate.

**CAUTION**  
When you use glue or paint, do not use near open flame, and use modeling scissors or cutter.  
See the bottom of this column for the meaning of symbols.  
Extra details can remain after assembling of the kit.

## PARTS

### Ah x4

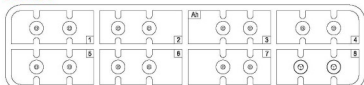

### Ak x2

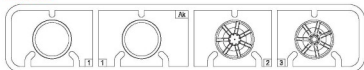

### Kc (Clear parts)

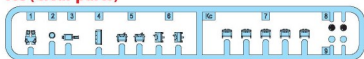

### PEb parts

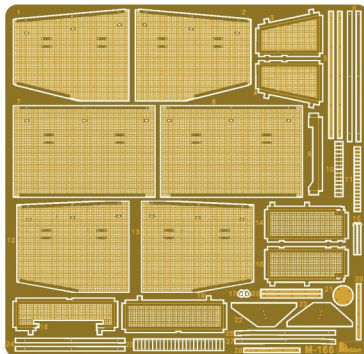

### PEa parts

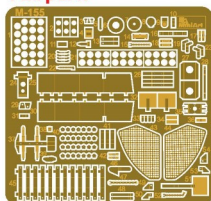

### Cd

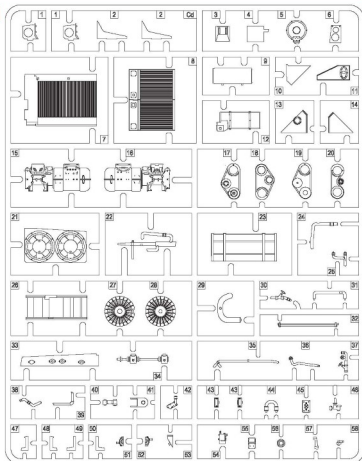

### Ai x4

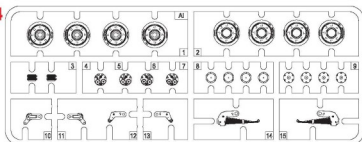

### Ea

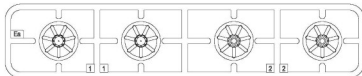

### Decal





MAKÉ DVA  
3 TEILE FERTIGEN  
EFFECTUOR 2 PIECES  
FARE CUIE PEZZE  
TÉTE 2 PÉC  
GÖR 2 BİT  
ПОДГОТОВЬ ДВА ПИЕСА  
КЛЫКСТЬ ПАЗІВ



DO NOT CEMENT  
NICHT KLEBEN  
NE PAS COLLER  
NON INCOLLARE  
ESIMANA  
LIMAJALI  
НЕ ПОСКОБЛОВАТЬ КЛЕЯ  
НЕ КЛЕЙТИ



OPTIONAL  
NACH BELIEBEN  
FACILITATIVO  
FACILITATIVO  
VALIKOVALIKOVANNEN  
VALIKAR  
BIRIYANLARI  
BIRIYANLARI



OPEN HOLE  
ÖFFNEN  
FARE UN TROU  
FORD APERTO  
ASA NERVA  
ÖPPNA HÅLET  
СДЕЛАТЬ ОТВЕРСТИЕ  
СПОБИТИ ОТВЕР



REMOVE  
ENTFERNEN  
RETIENIR  
SEPARARE  
ROTEZ  
ALAGSANA  
OTVIKNUY  
BIRIYANLARI



BEND  
BITS BIEGEN  
PLIER LES  
VOUS PLIAT  
PIEGARE  
ZAVTA  
BOCCA  
BIRIYANLARI  
BIRIYANLARI



SCRATCH-BUILD  
AM MISTEN ZU MACHEN  
FAIRE LE PLUS  
RENCHIRI  
TÉTE FISE  
GÖR DİG BİLİYİ  
СДЕЛАТЬ СКАМОУ  
СПОБИТИ СКАМОУ

## PARTS

### Bf x2

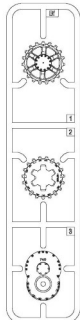

### Be x2

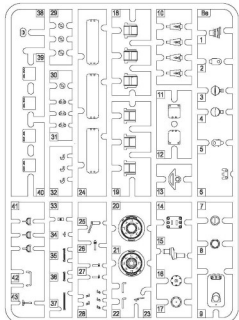

### Bg x2

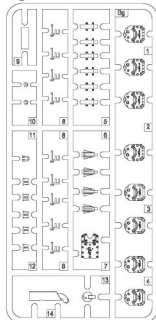

### Bc x2

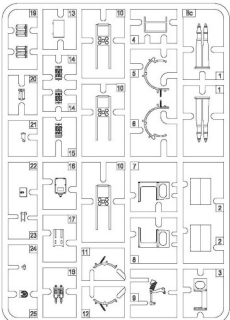

### Da

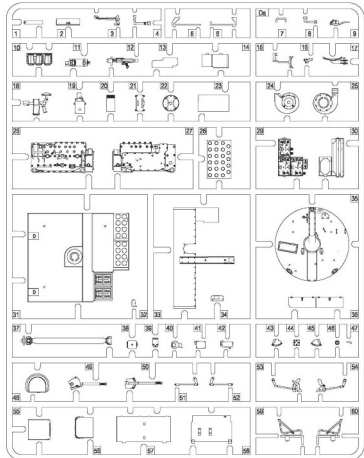

### Db

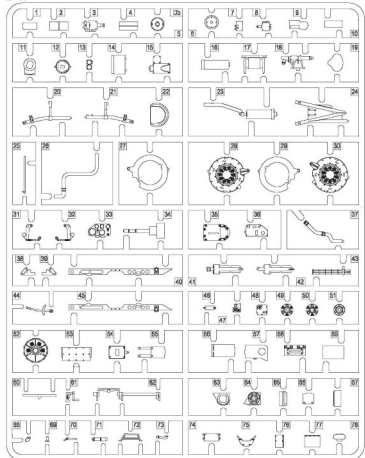

### Lg

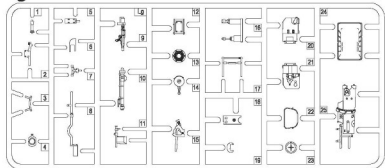

### Lc

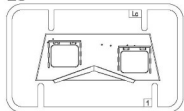

### Lf

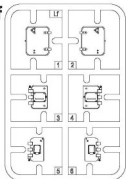

Ga

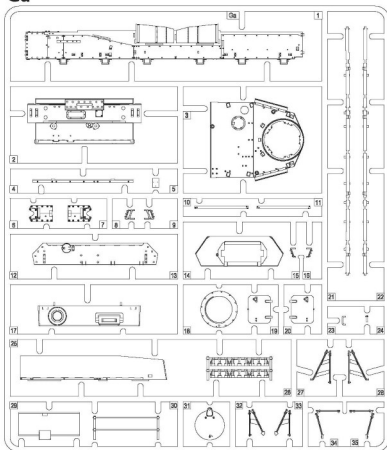

Gb

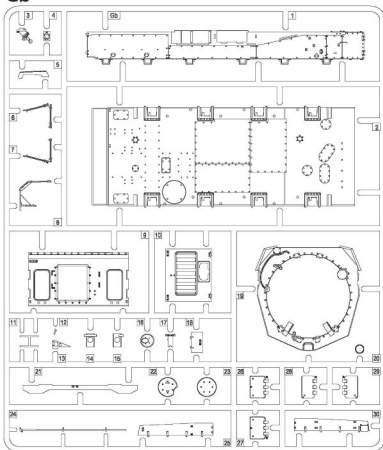

Ha

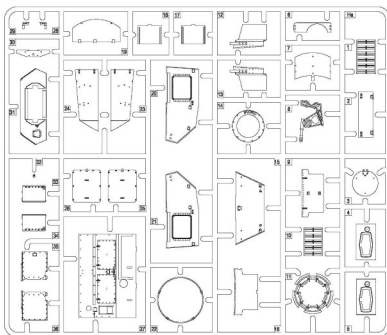

Hb

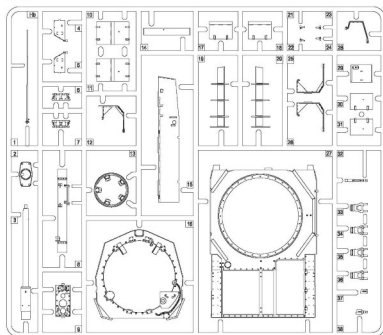

Ad x4

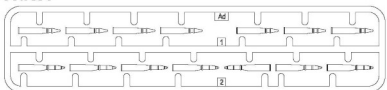

Ae x2

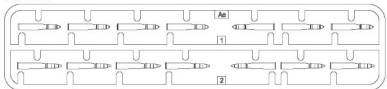

Ke

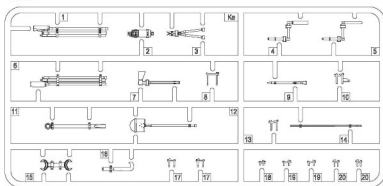

Ed

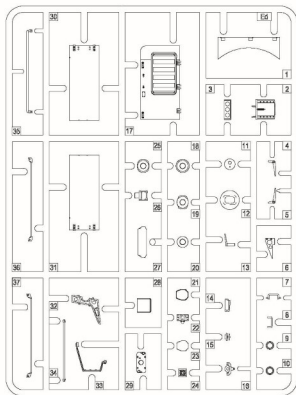

Ka

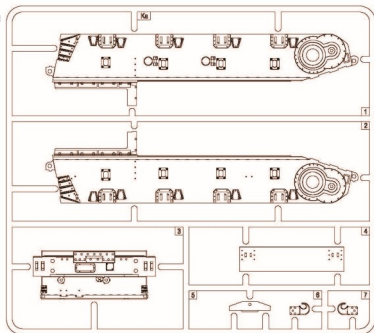

Ec

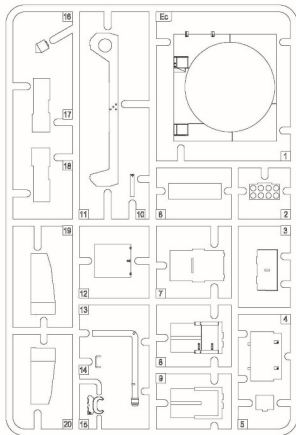

Ca

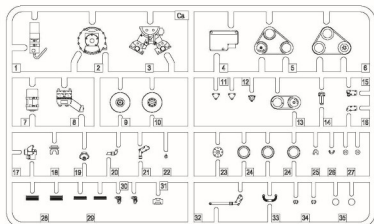

Cb

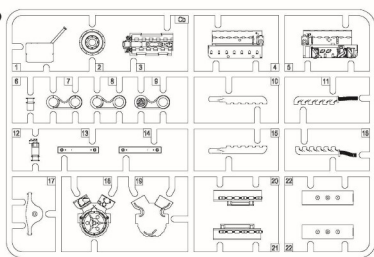

Jd

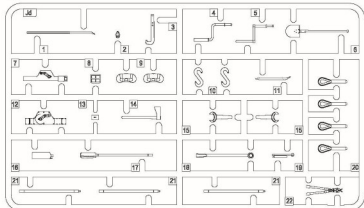

Tracks x22



Af x4

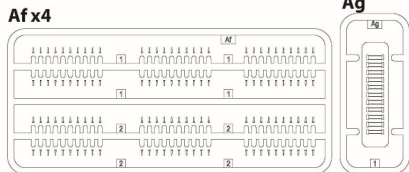

Ag

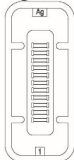

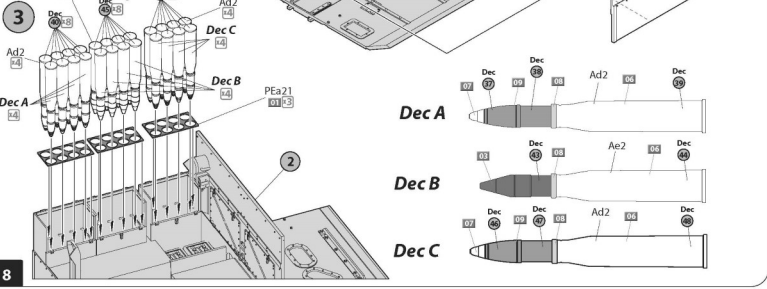
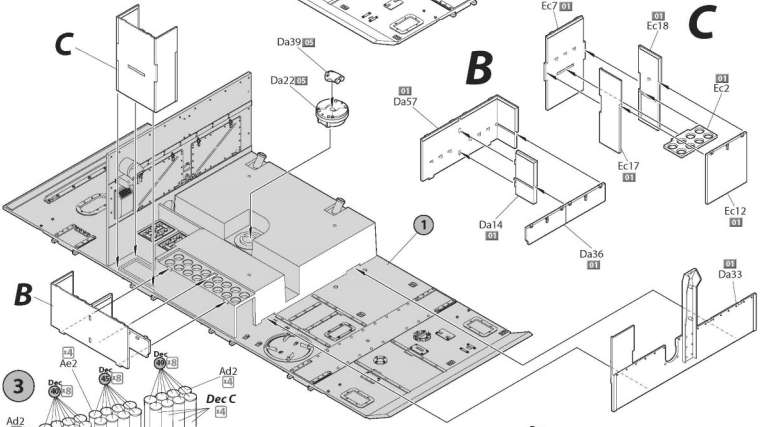
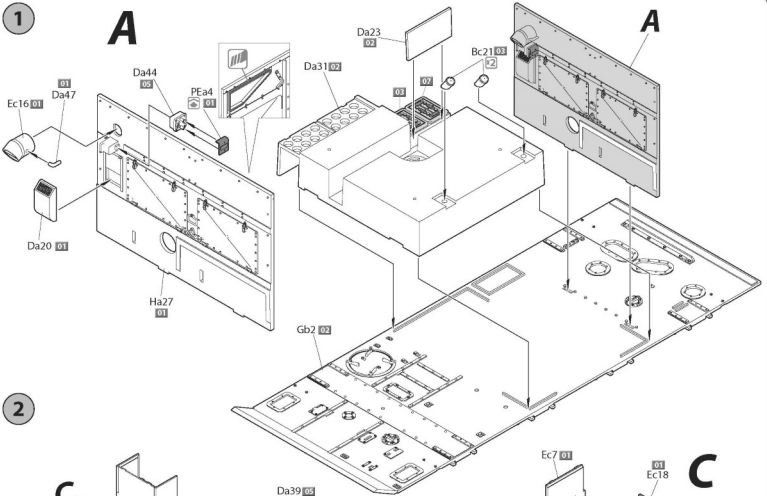



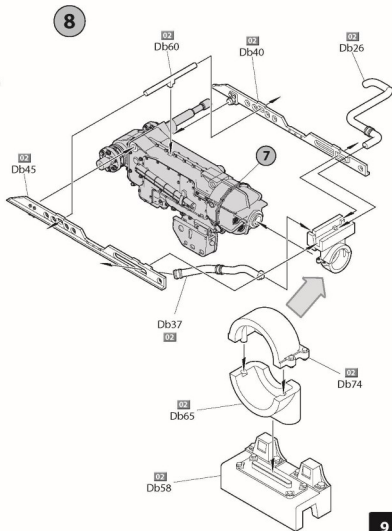
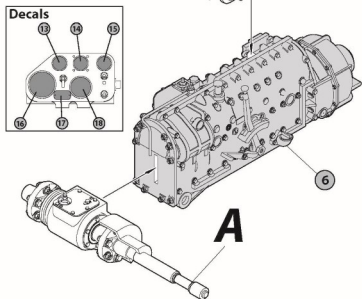
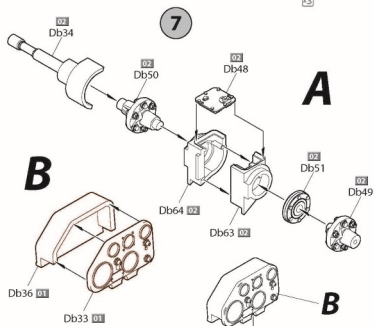
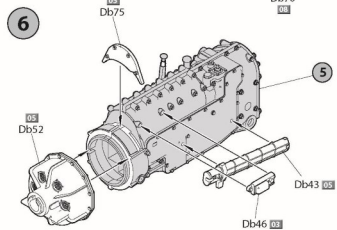
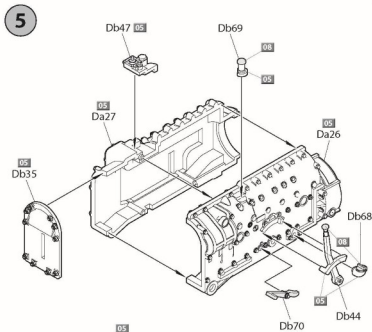
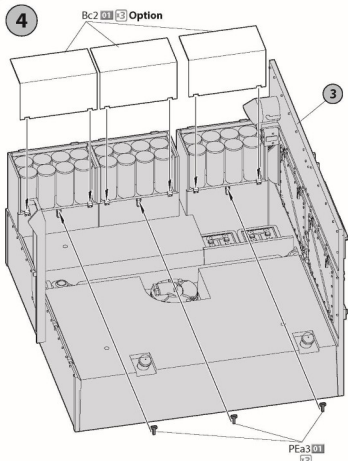

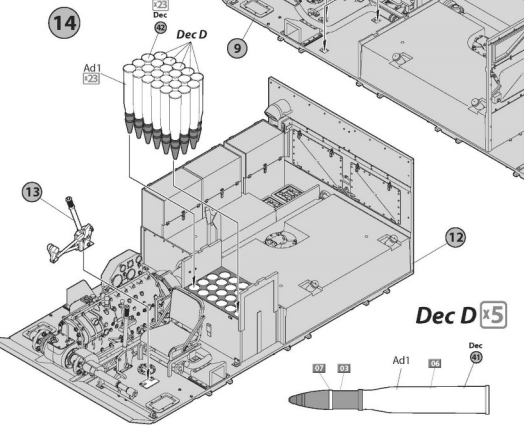
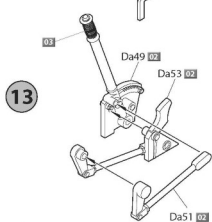
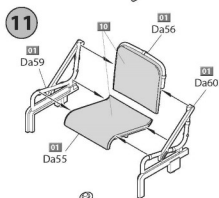
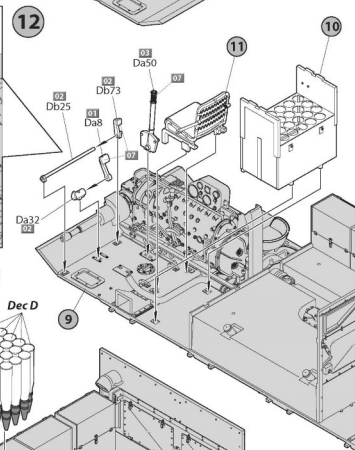
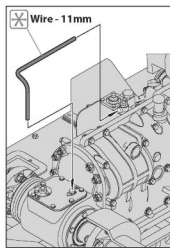
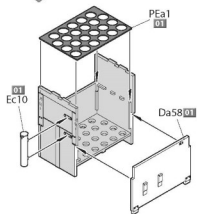
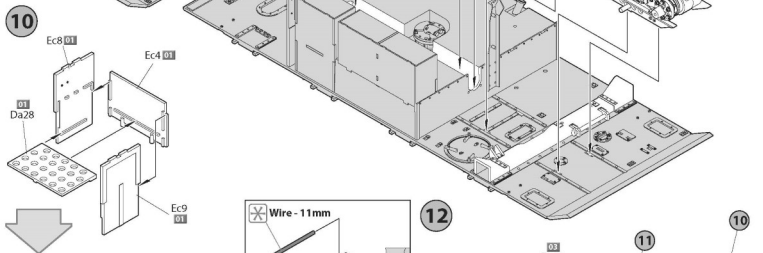
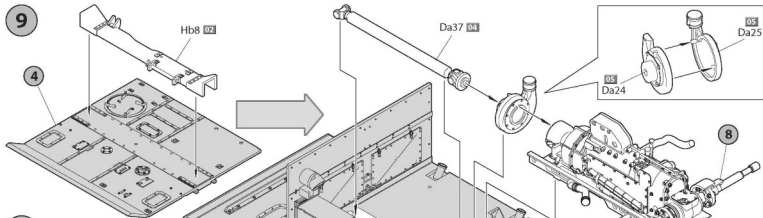

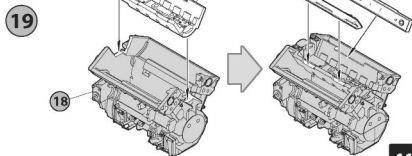
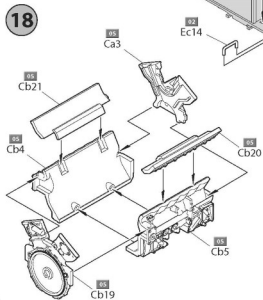
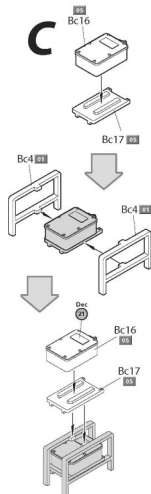
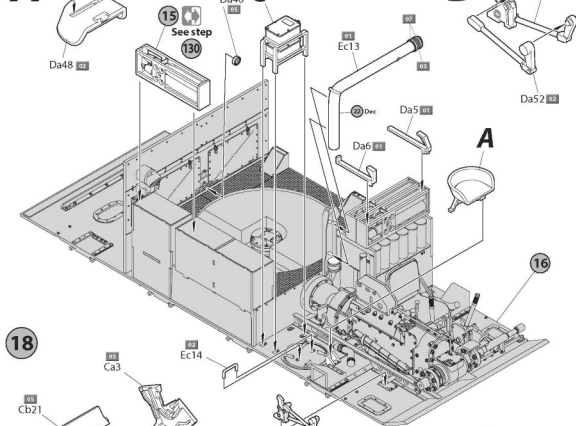
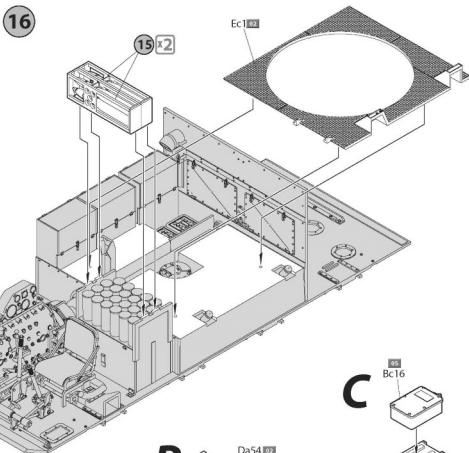
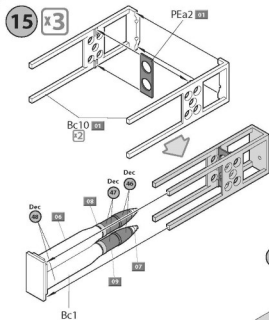

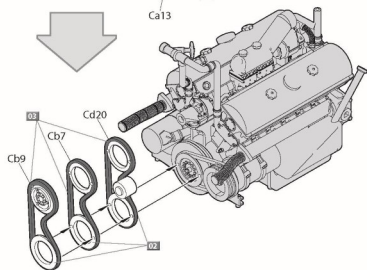
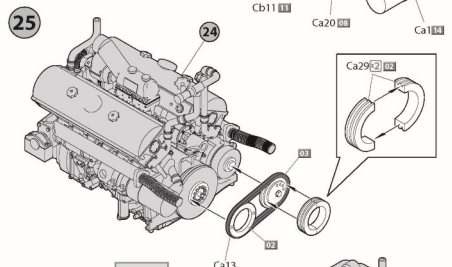
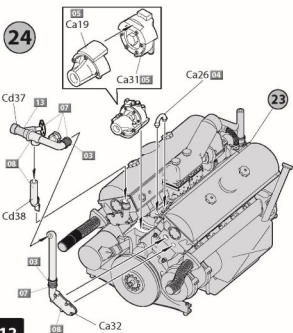
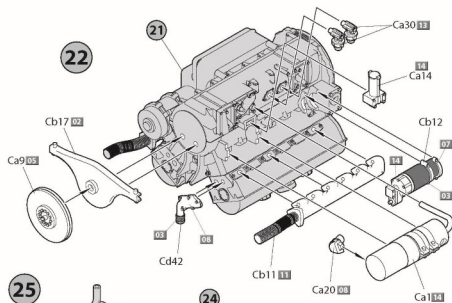
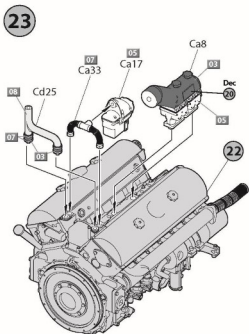
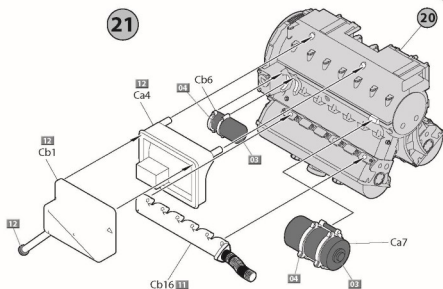
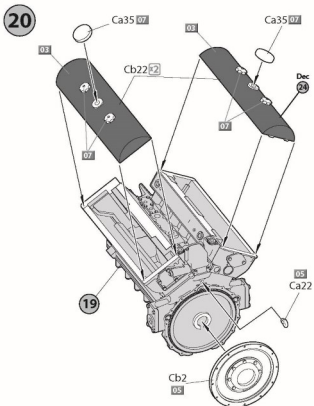

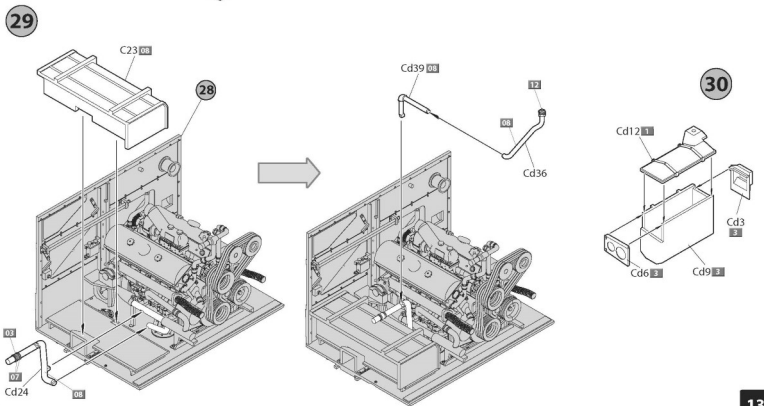
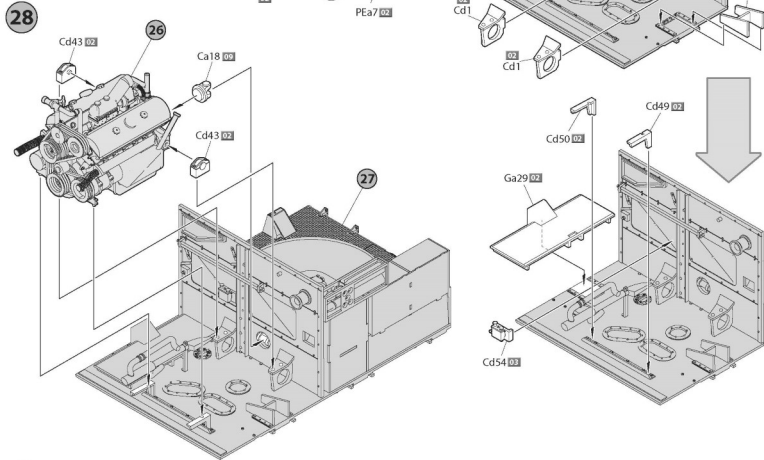
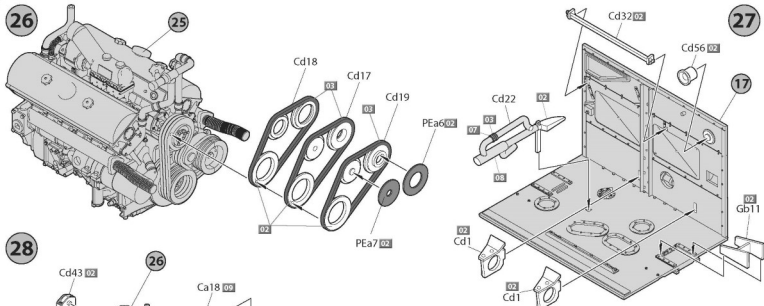

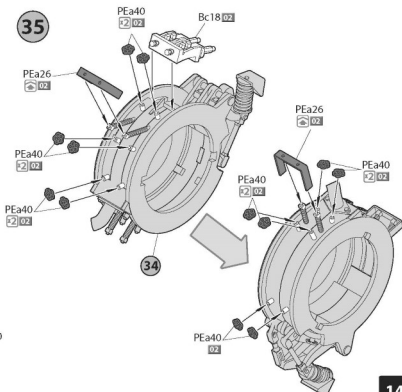
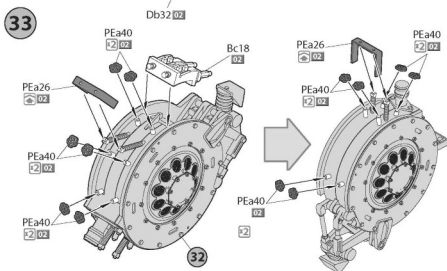
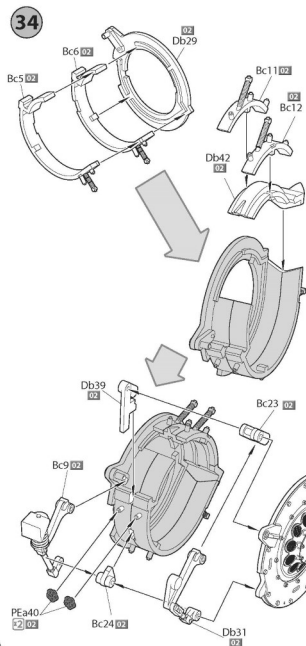
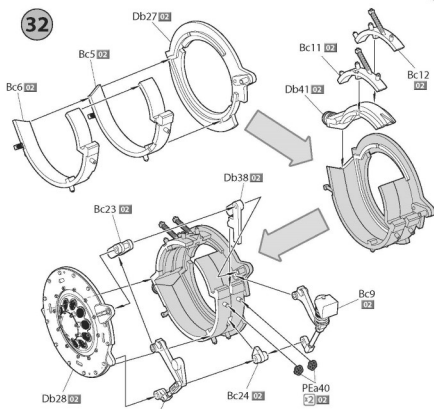
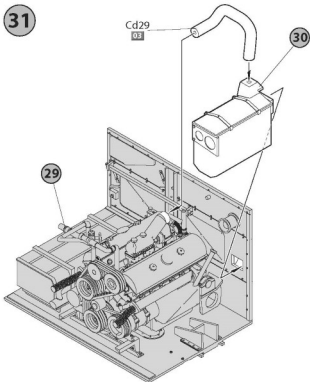

36

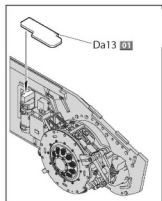
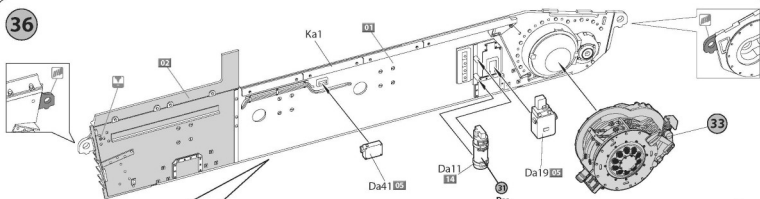

37

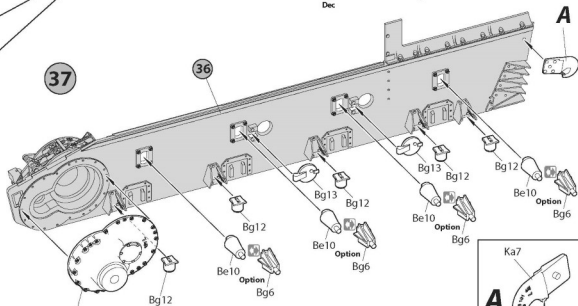

38

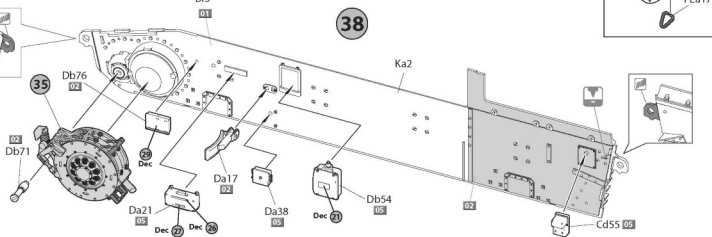

40

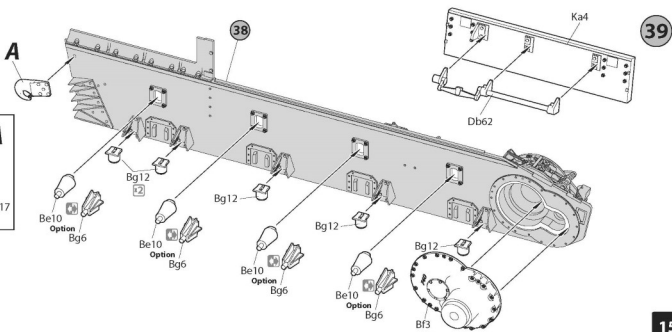
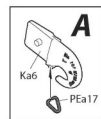

41

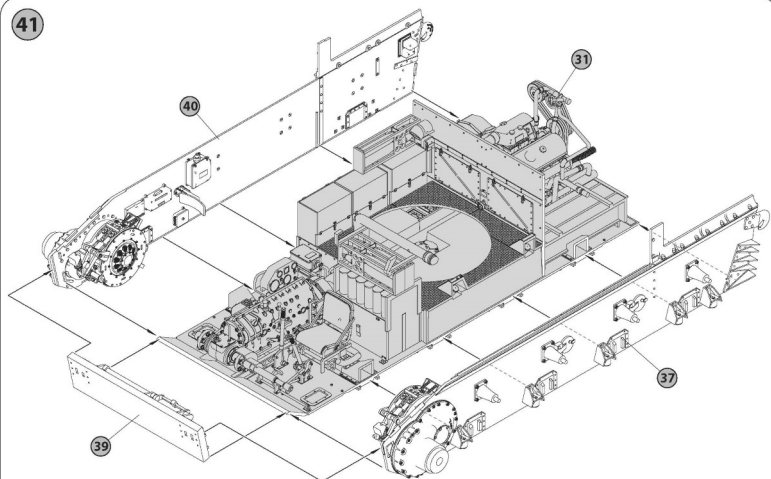

42

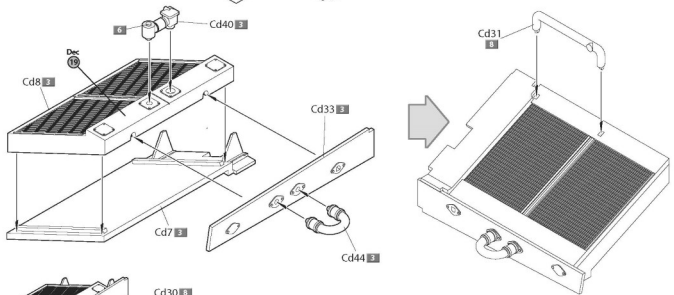

43

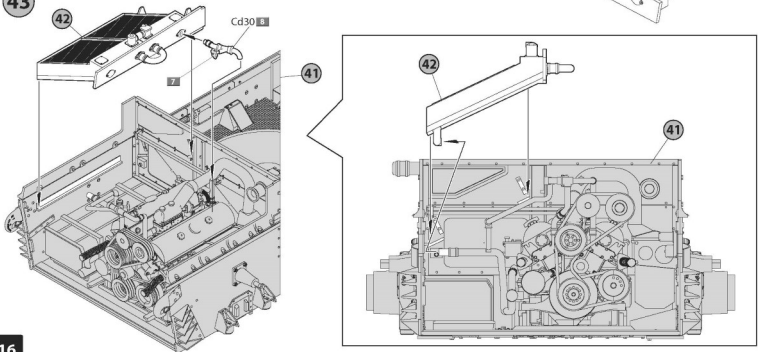



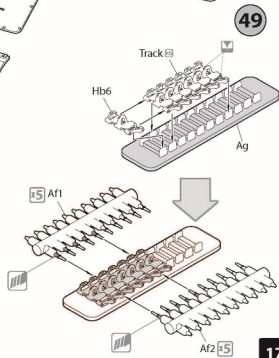
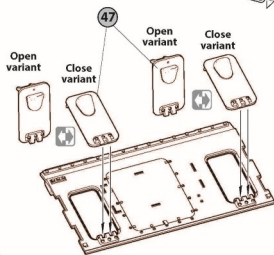
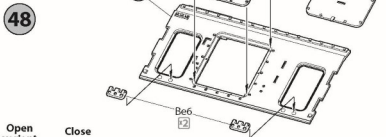
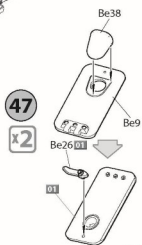
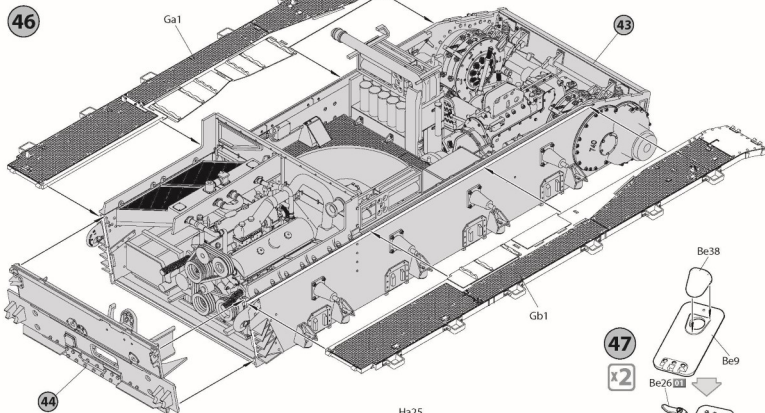
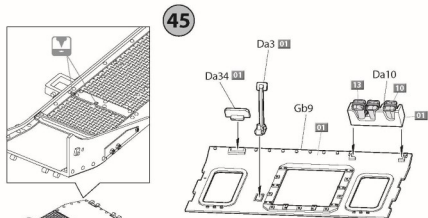
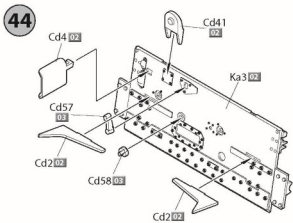

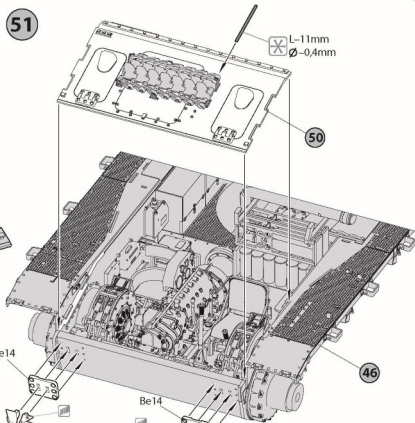
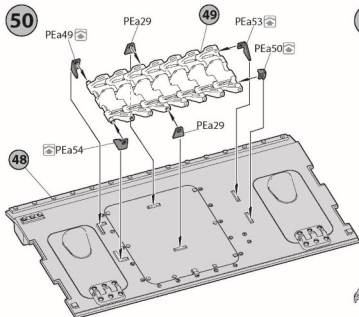

**52** Variant 2. See step **54**

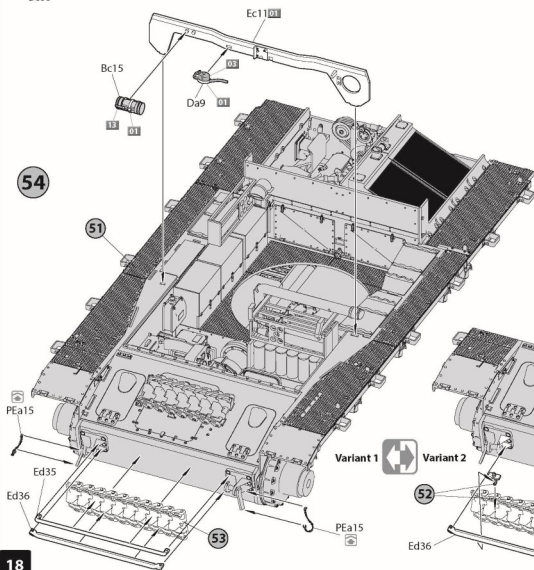
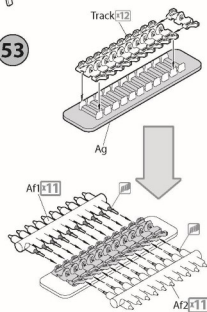
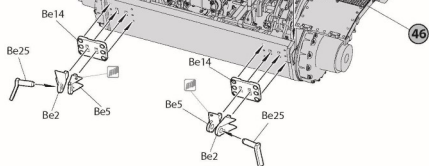

Variant 1 Variant 2

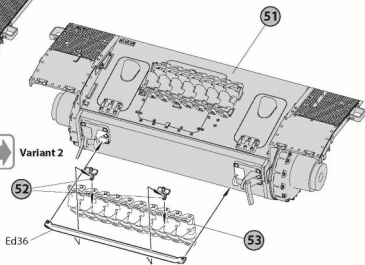

55

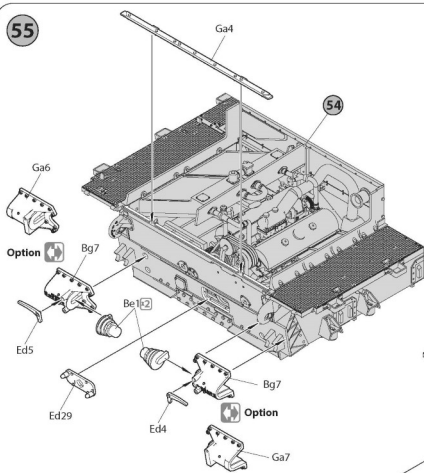

56

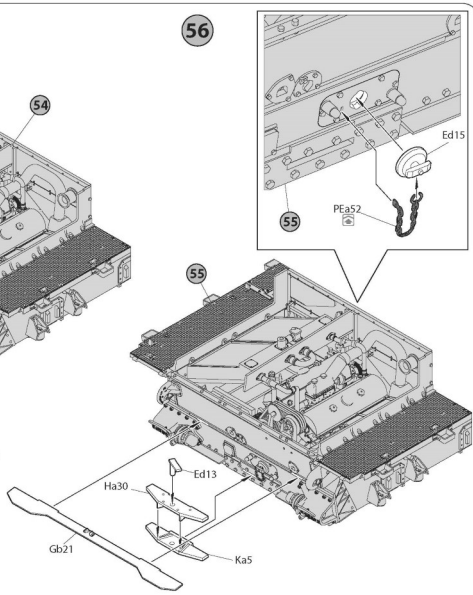

57

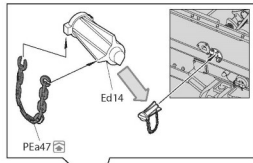

58

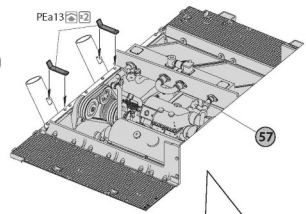

56

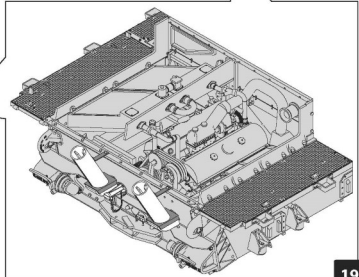
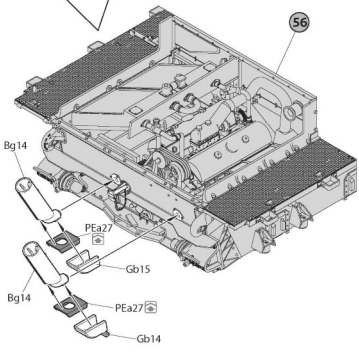

59

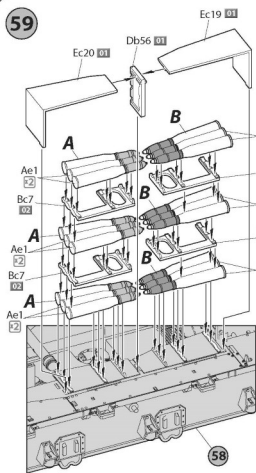

60

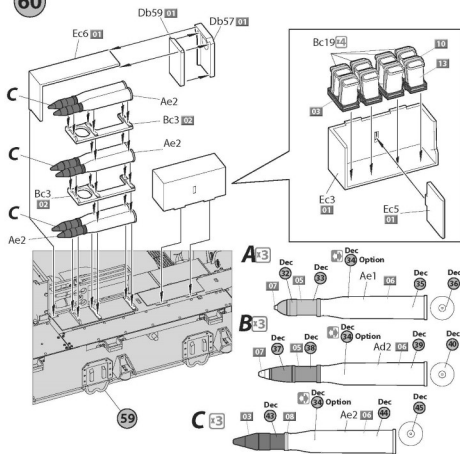

61

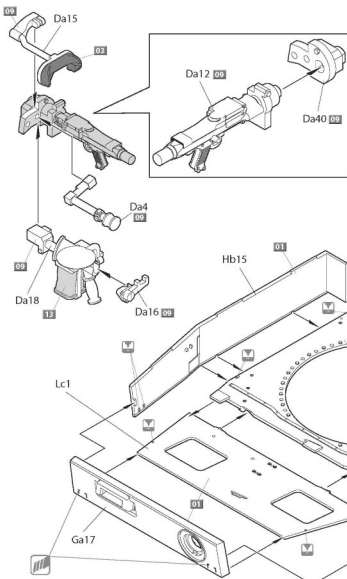

62

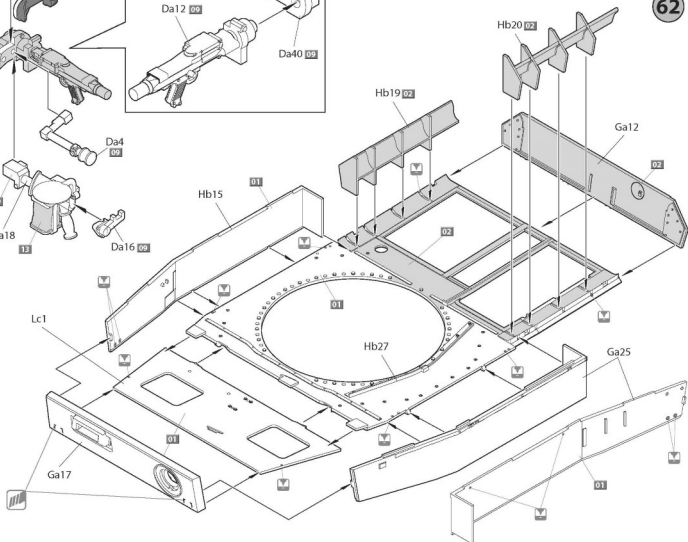



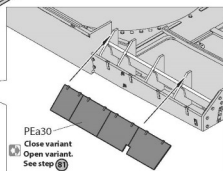
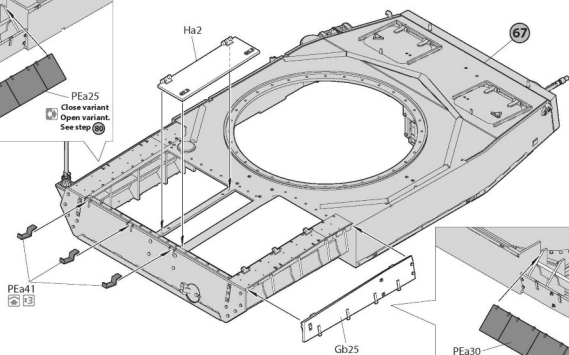
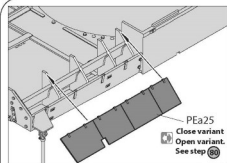

69

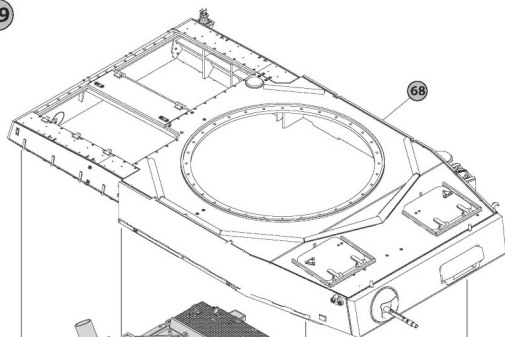

70 x2

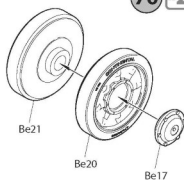

71

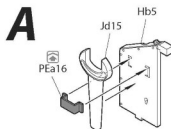
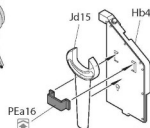
**B**

72

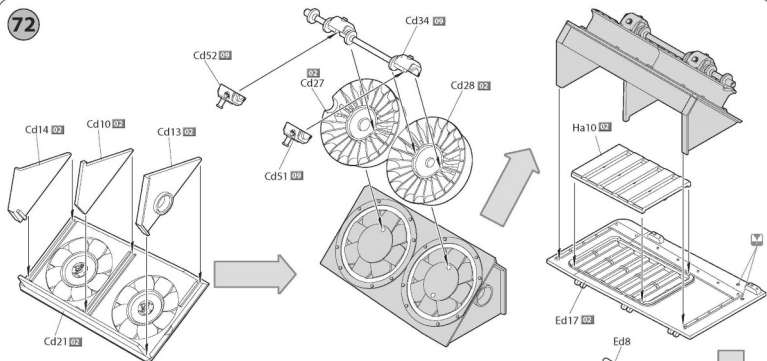

73

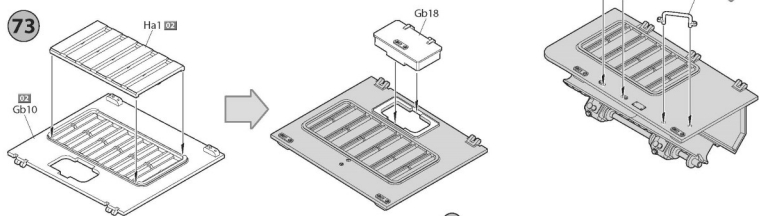

74

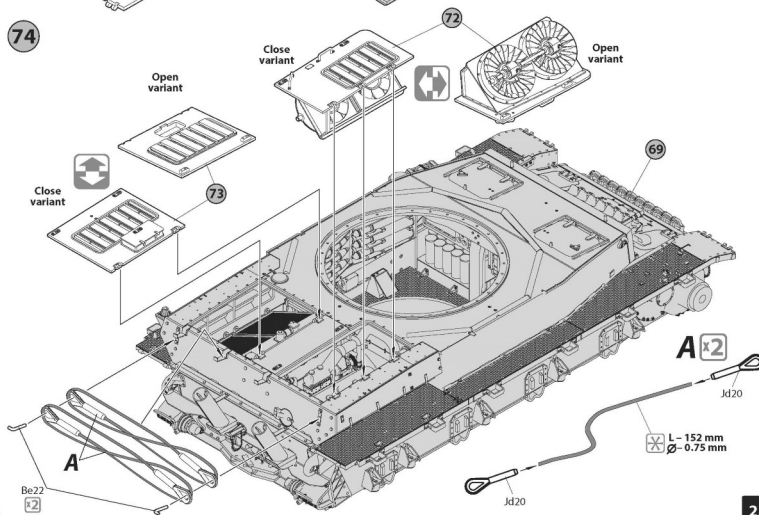

75

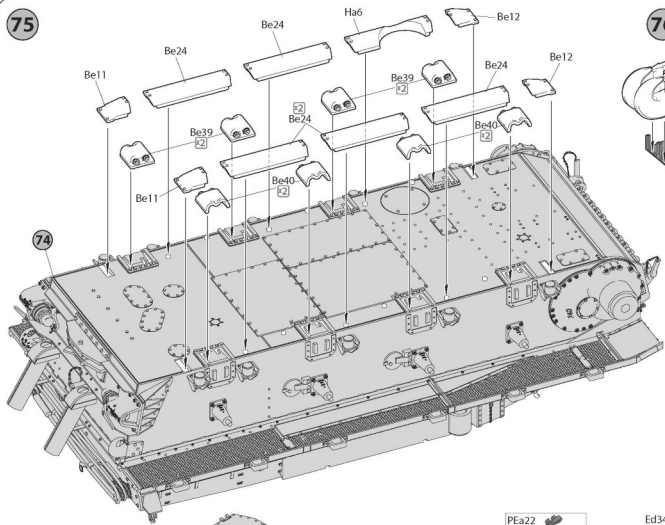

77

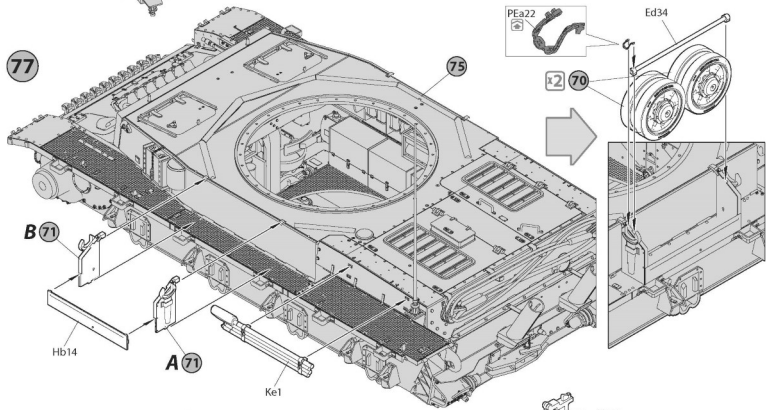

78

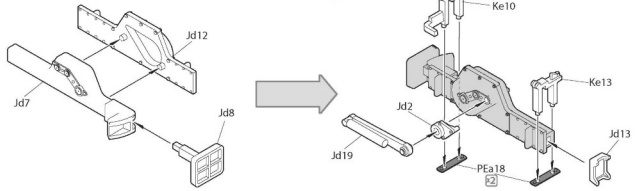



79

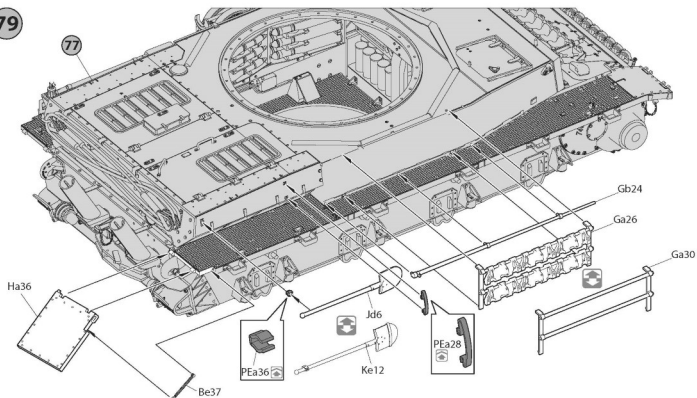

79

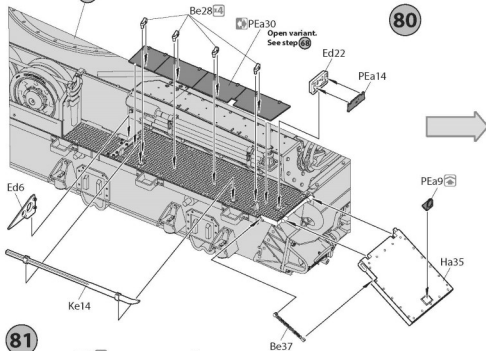

80

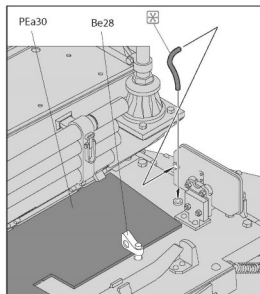

81

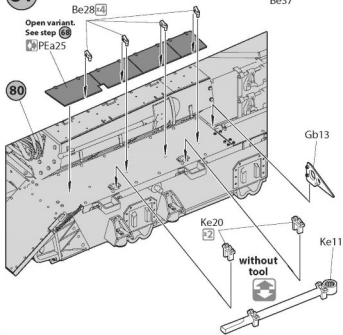

80

82

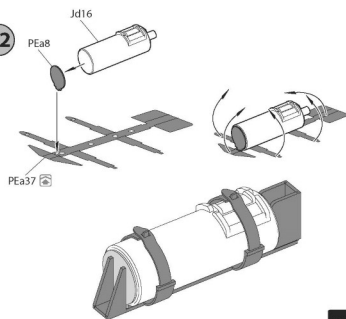

83

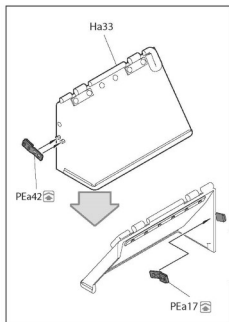

Open variant

Close variant

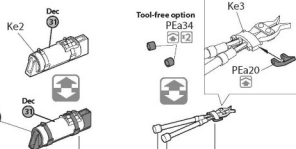

81

 Ga15 Variant 1  
 Ga8 Variant 2  
 See step 102

84

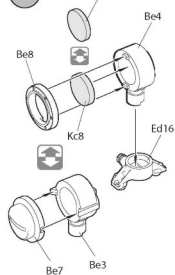

85

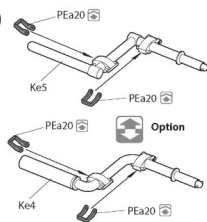

Option

86

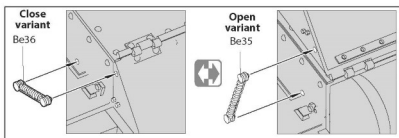
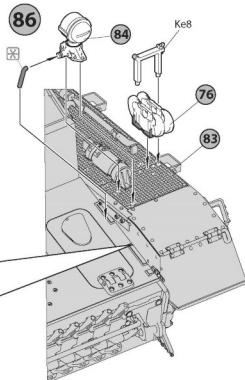

87 x8

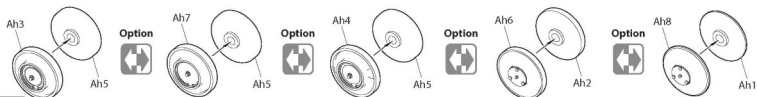

88

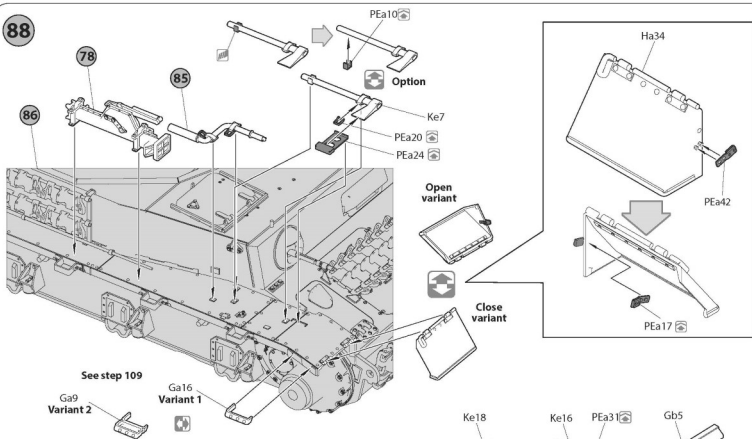

89

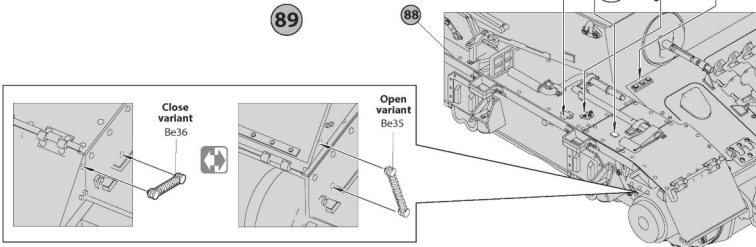

90 x16

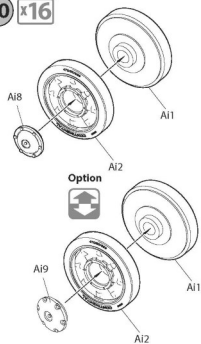

91 x2

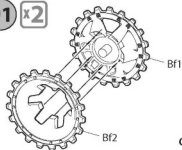

92 x2

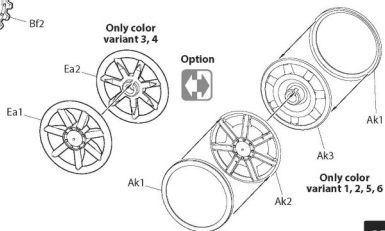

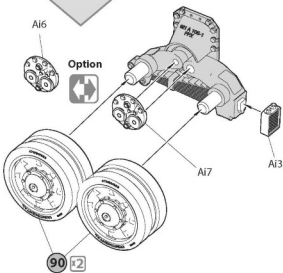
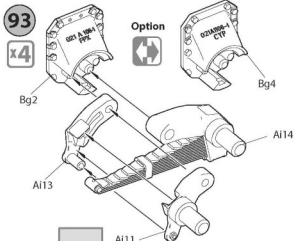

**Part Bg1, Bg2, Bg3, Bg4  
For workable suspension**

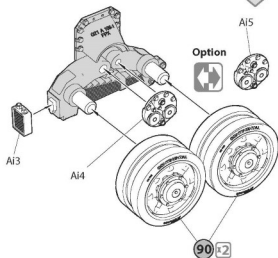
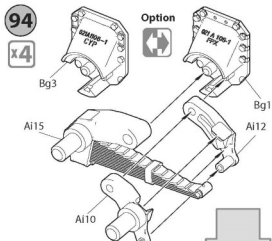

**95** **x2**

**Repeat on  
the reverse side**

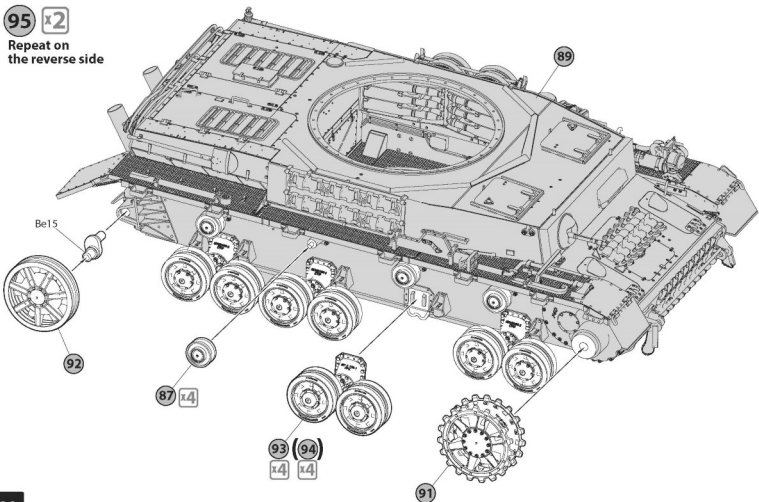

96

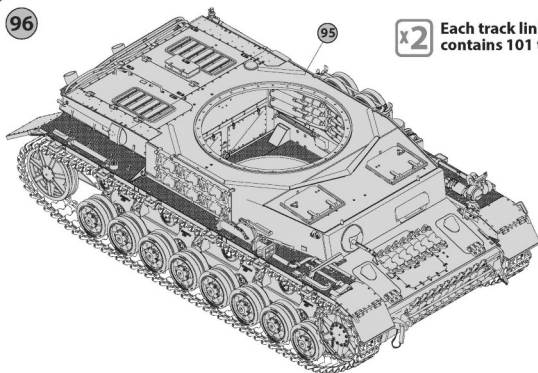

**x2** Each track links contains 101 tracks

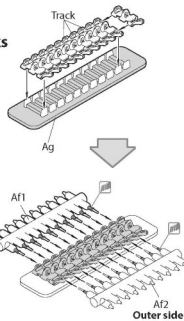

97

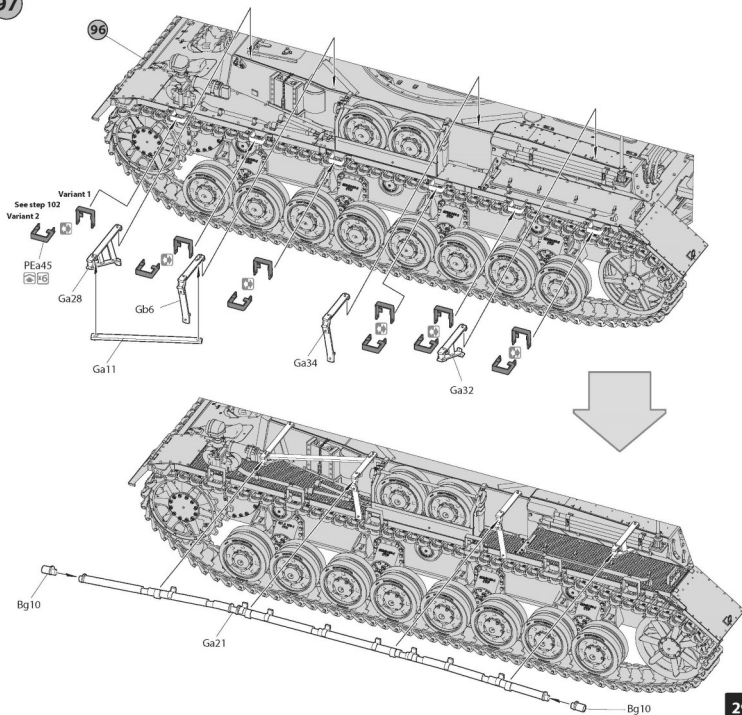

98

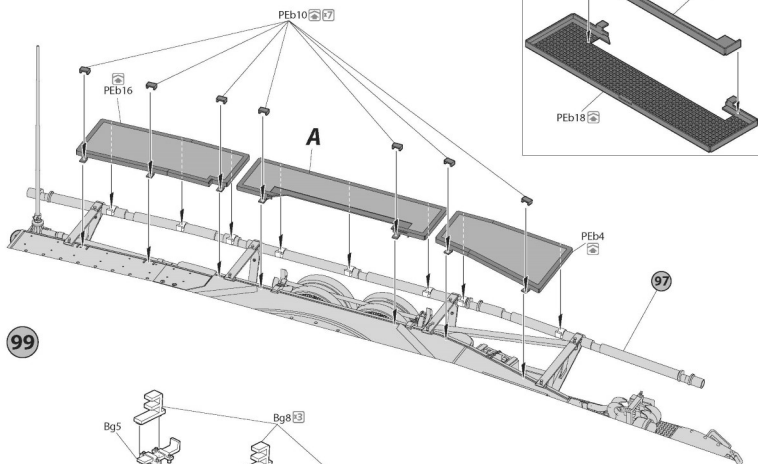

99

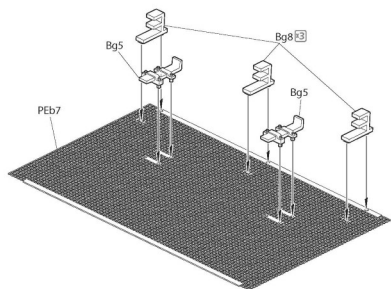

100

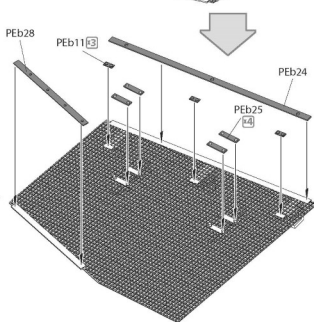
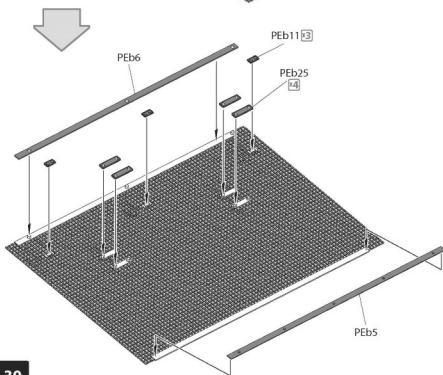
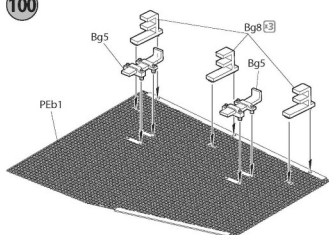

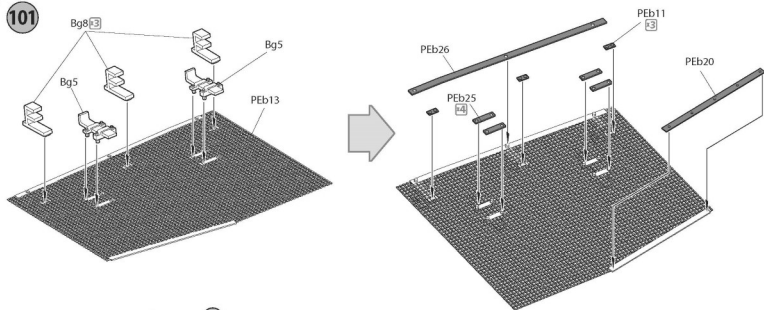
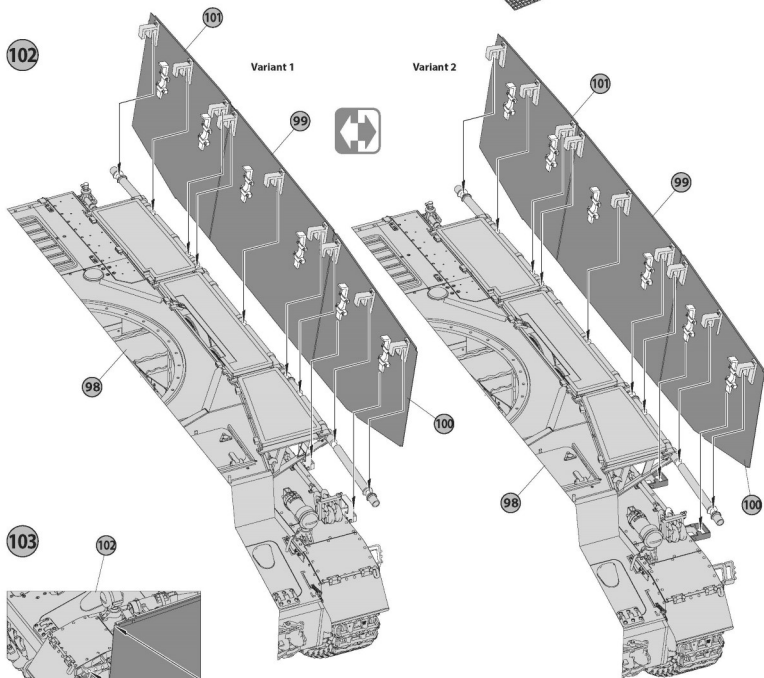
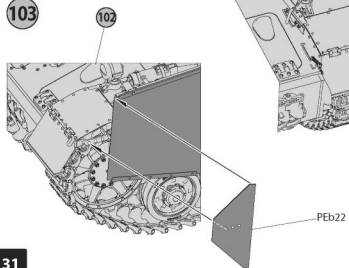
**101****102****103**

104

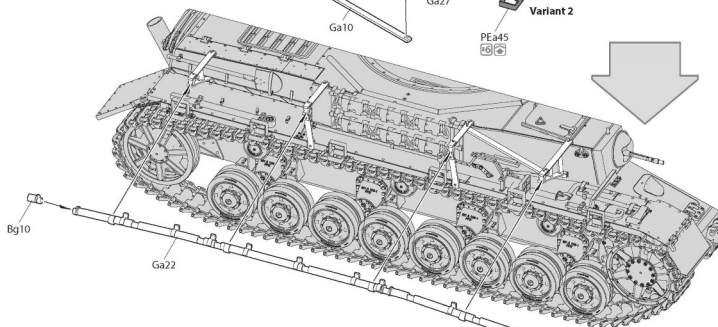
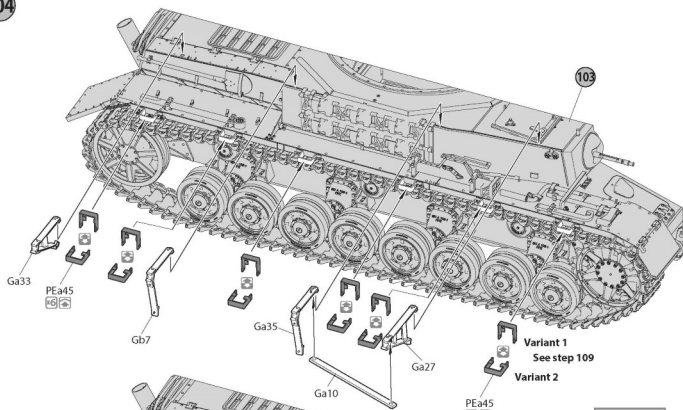

105

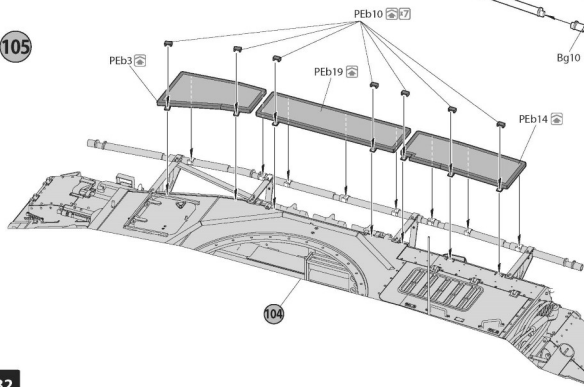



106

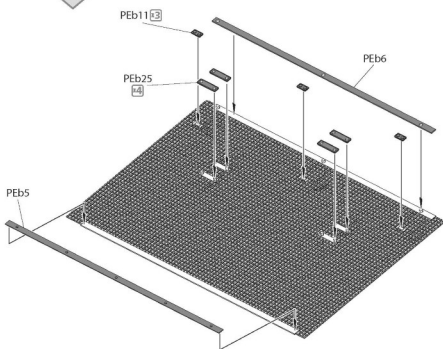
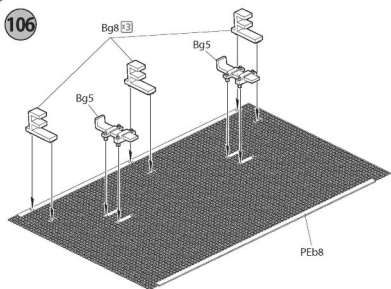

107

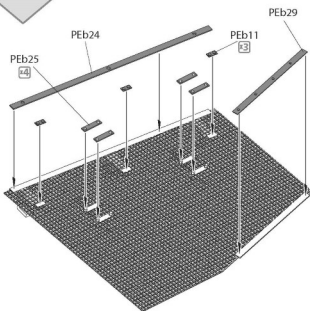
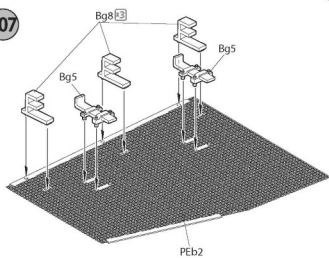

108

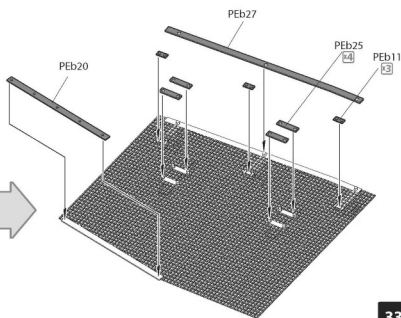
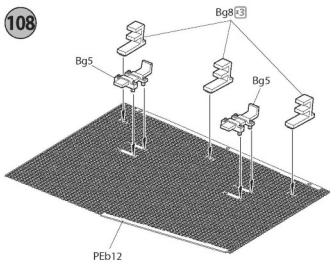

109

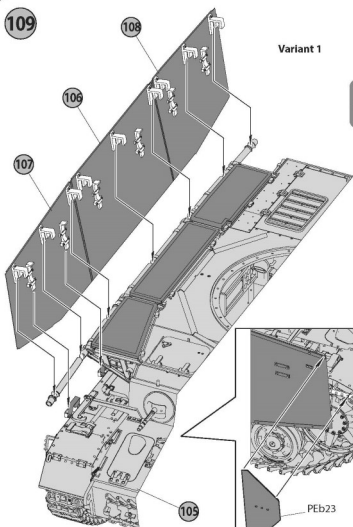

Variant 2

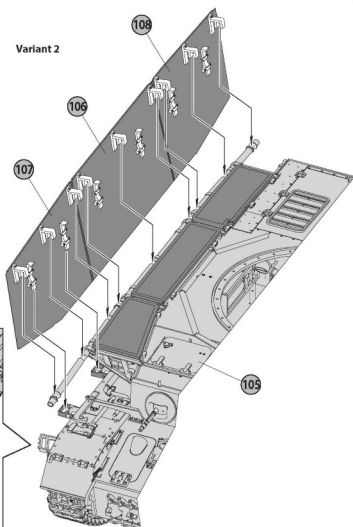

110

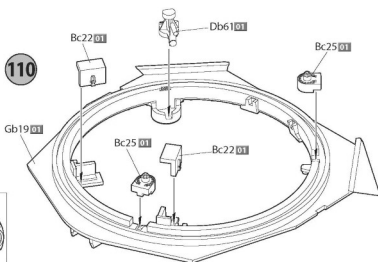

111

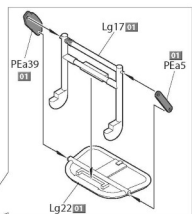

110

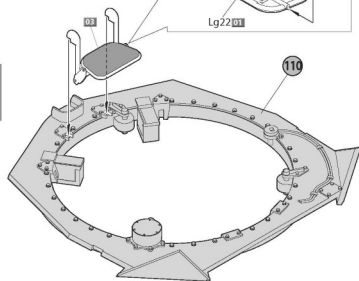
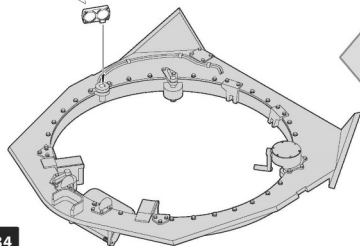

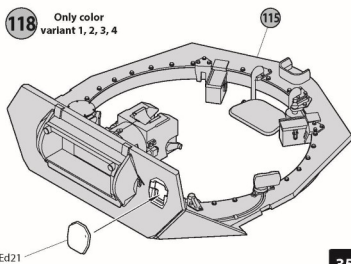
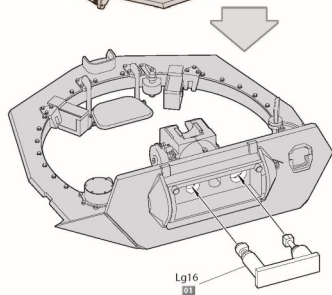
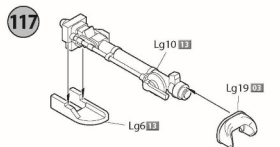
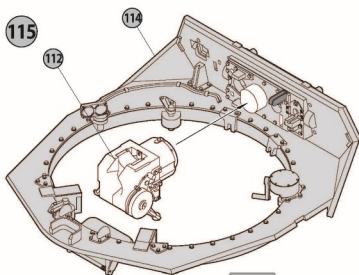
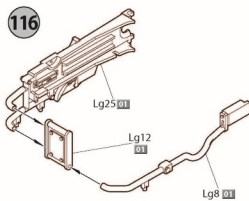
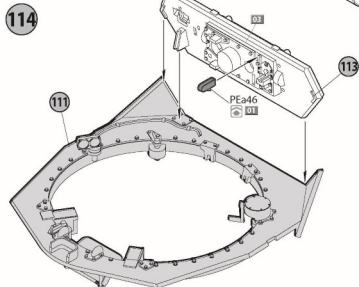
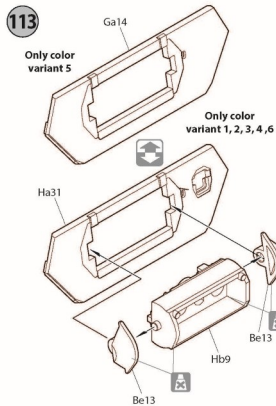
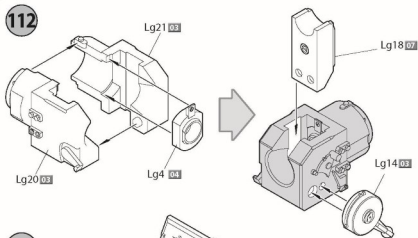

**119** Only color variant 6

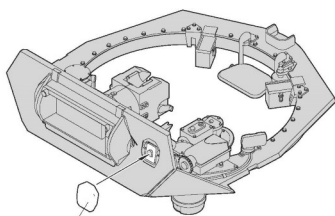
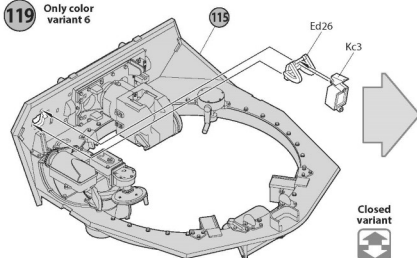

Closed variant



Open variant

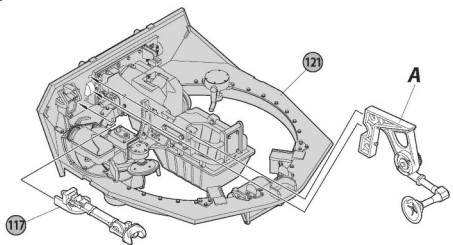
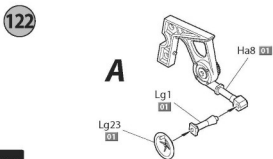
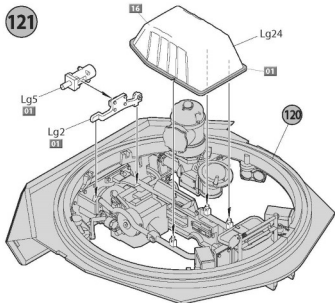
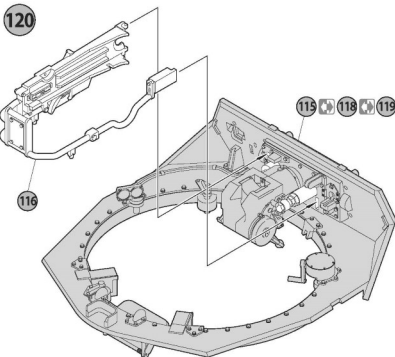
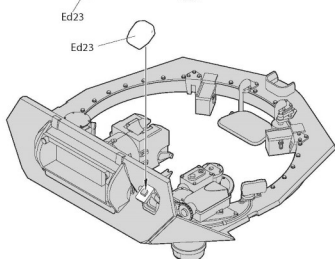
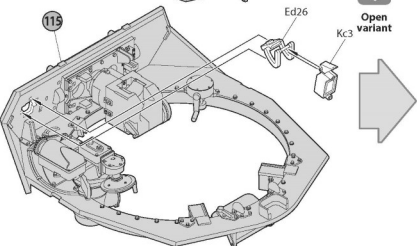

123

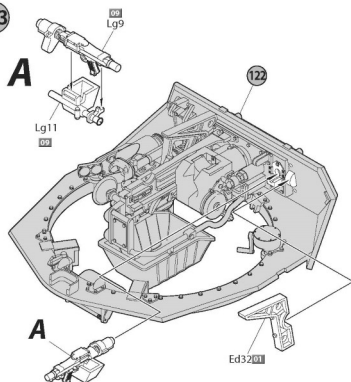

124

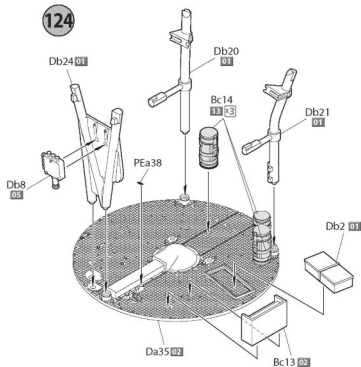

125

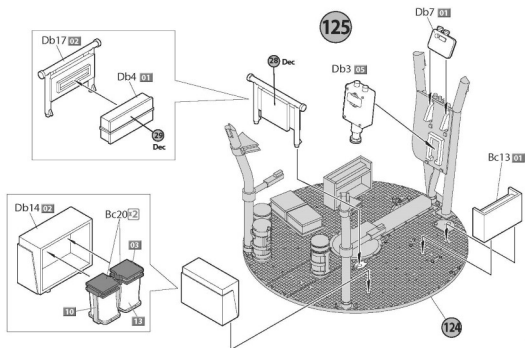

126

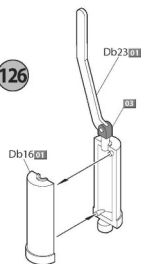

127

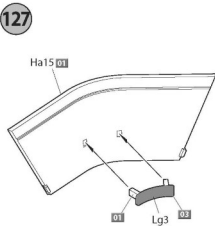

128

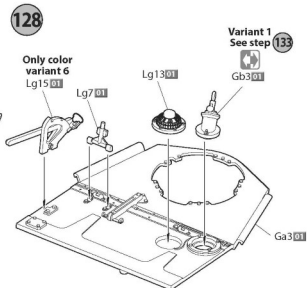

129

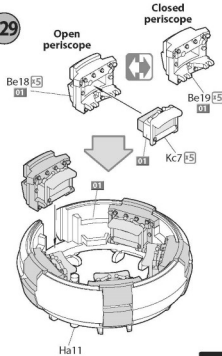

130

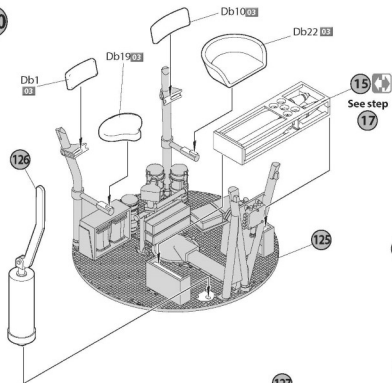

131

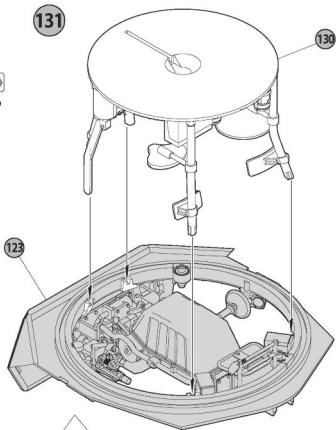

132

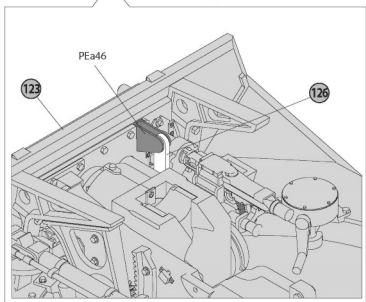
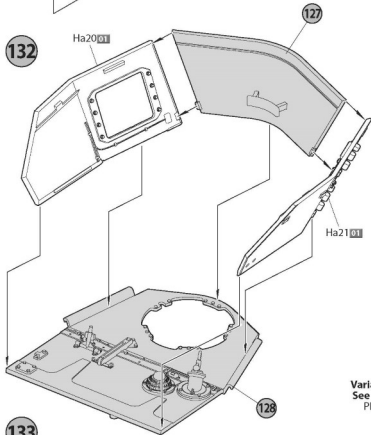

133

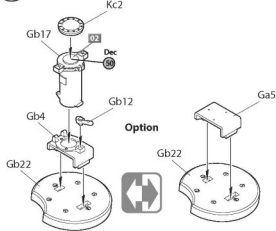

134

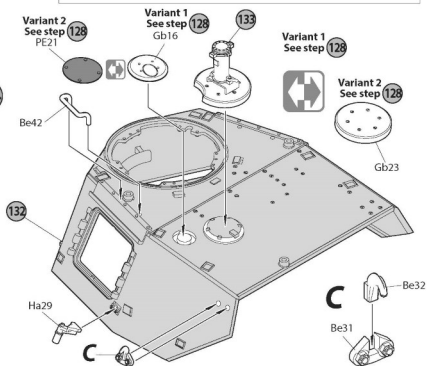

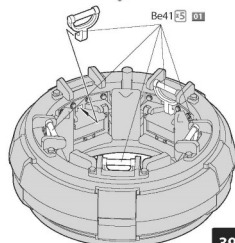
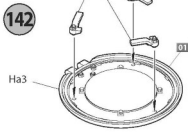
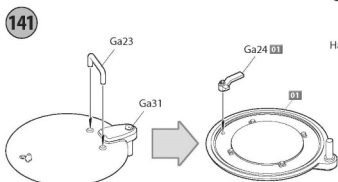
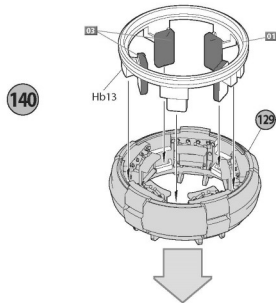
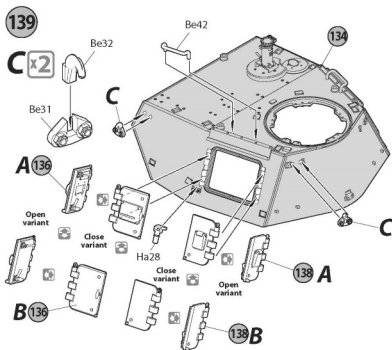
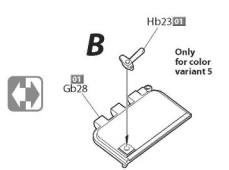
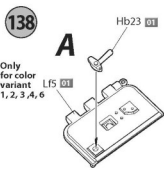
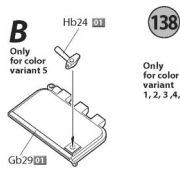
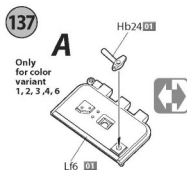
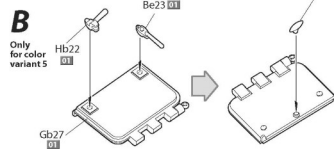
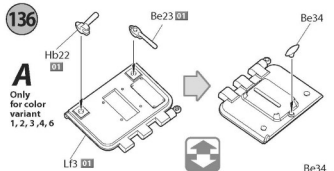
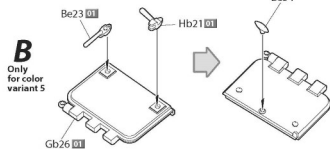
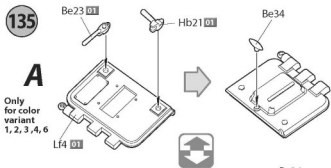

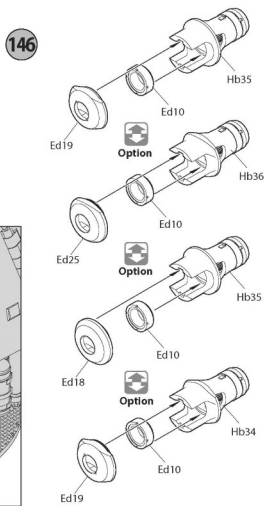
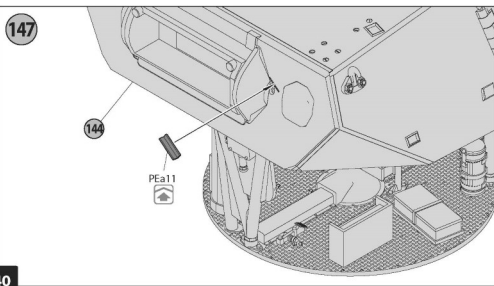
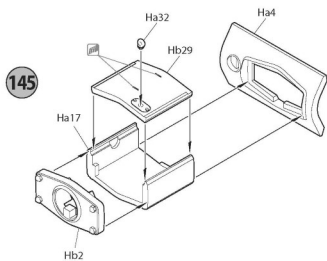
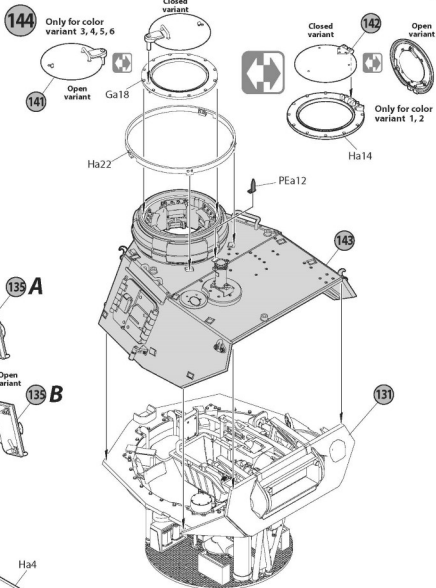
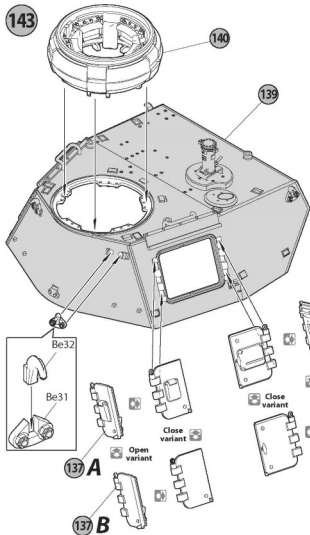



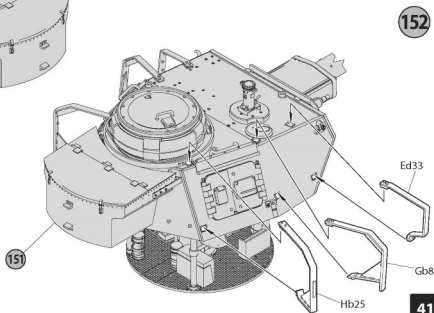
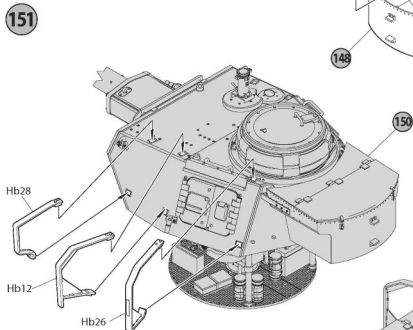
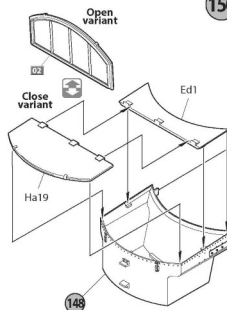
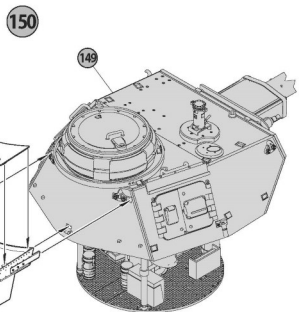
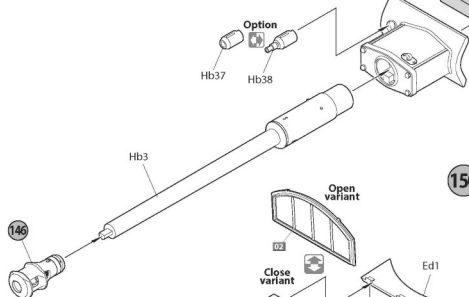
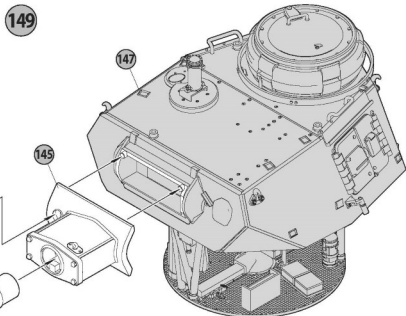
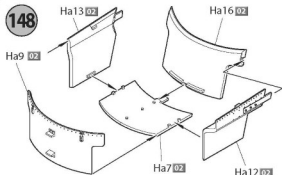

153

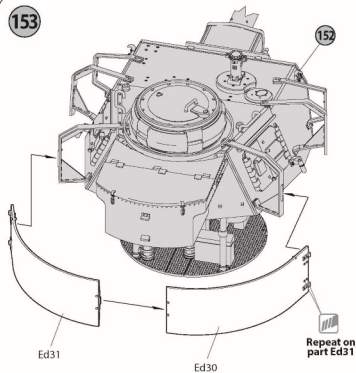

154

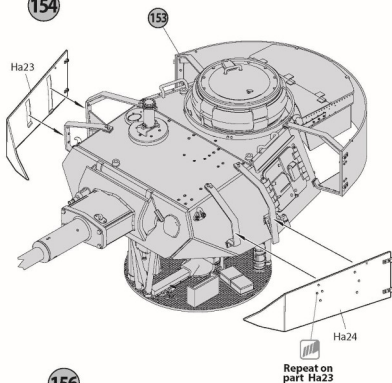

155

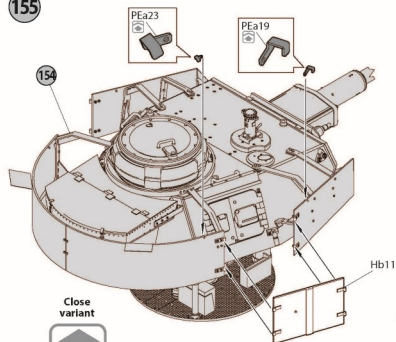

156

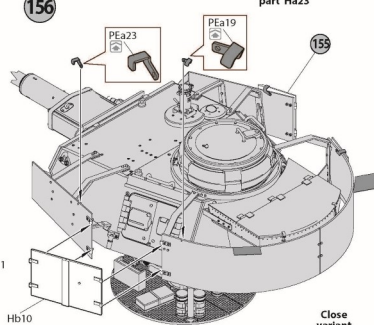

Open variant

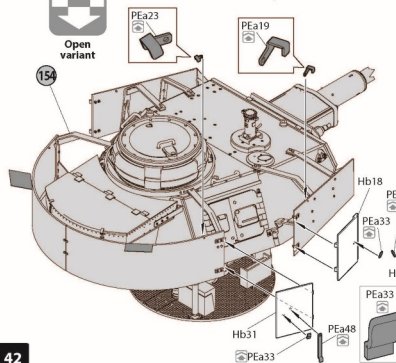

Open variant

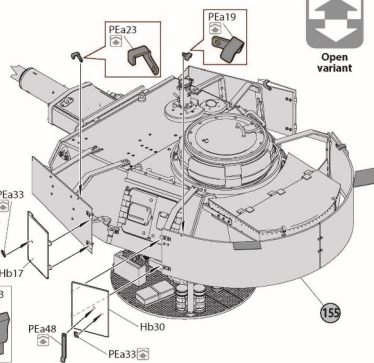

157

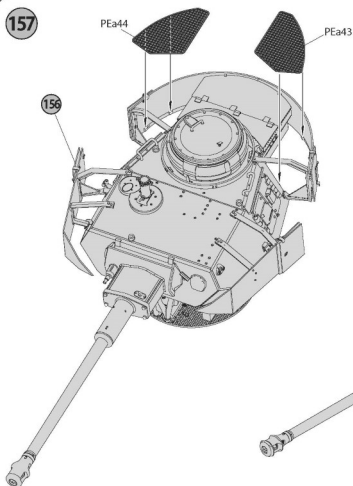

158

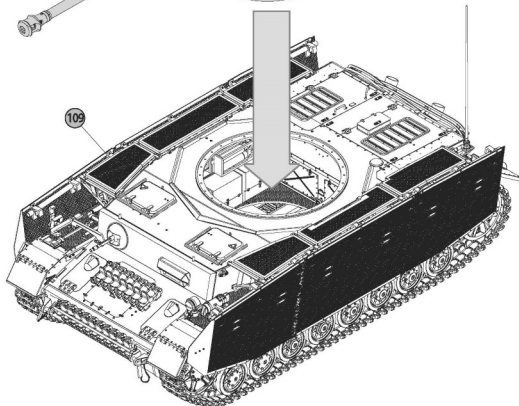
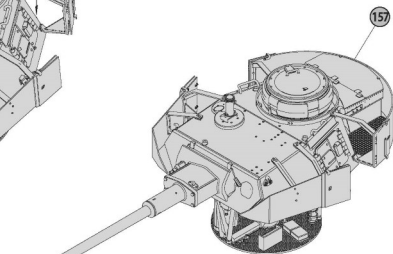

## COLOR CHART

Mf	Vallejo	Mr. Color	AK RC	Mission Models	AMMO MIG	Tamiya	Color name
01	71.119	C-322	RC-003	MMP-082	A.MIG-0017	XF-02	Cremesuisse
02	71.271	C-041	RC-067	MMP-015	A.MIG-0014	XF-64	German Rotbraun
03	71.057	C-033	RC-001	MMP-047	A.MIG-0046	XF-01	Black
04	71.072	C-028	AK-476	MMM-002	A.MIG-0191	XF-56	Steel
05	71.056	C-040	RC-057	MMP-014	A.MIG-0008	XF-63	Dunkelgrau
06	71.067	C-219	AK-460	MMM-009	A.MIG-0197	X-12	Brass
07	71.062	C-090	RC-020	MMM-008	A.MIG-0194	XF-16	Aluminium
08	71.003	C-003	RC-006	MMP-003	A.MIG-0049	XF-07	Red
09	71.073	C-078	RC-015	MMM-001	A.MIG-0045	XF-84	Gun Metal
10	71.041	C-310	RC-035	MMP-033	A.MIG-0076	XF-10	Brown
11	71.069	C-121	AK-709	MHW-001	A.MIG-0041	XF-10	Rust
12	71.089	C-005	RC-036	MMP-065	A.MIG-0086	XF-17	Blue
13	71.007	C-038	RC-023	MMP-025	A.MIG-0081	XF-62	Olive Green
14	71.276	C-060	RC-299	MMP-072	A.MIG-0075	XF-55	Light Grey
15	71.025	C-039	RC-062	MMP-011	A.MIG-0010	XF-60	Dunkelgelb
16	71.016	C-012	RC-024	MMP-020	A.MIG-0071	XF-49	Khaki
17	71.001	C-062	RC-004	MMP-001	A.MIG-0050	XF-02	White
18	71.027	C-043	RC-030	MMP-076	A.MIG-0037	XF-79	Wood
19	71.251	C-137	RC-022	MMP-040	A.MIG-0033	XF-85	Tire Black

# RELATED ITEMS

**Pz.Beob.Wg.IV Ausf. J**  
**LATE/LAST PROD. WITH CREW** **2 IN 1**

THIS IS A MILD PLASTIC MODEL KIT  
 BOX CONTAINS MODEL OF TANK & 5 FIGURES  
 PEANUTS INCLUDED  
 1:35 SCALE (90MM)  
 THIS IS NOT A TOY

1:35

**MiniArt**

880TH20  
 35344

WW II MILITARY MINIATURES SERIES

SPECIAL EDITION SCALE 1:35 35319

**GERMAN TANK REPAIR CREW**

UNUSUAL PLASTIC MODEL KIT  
 THE KIT CONTAINS MODELS OF  
 FIVE FIGURES, TOOLS

**MiniArt**

WW II MILITARY MINIATURES SERIES

SPECIAL EDITION SCALE 1:35

**GERMAN TANK CREW NORMANDY 1944**

WW II MILITARY MINIATURES SERIES

35275

**MiniArt**

SPECIAL EDITION SCALE 1:35 35285

**GERMAN TANK CREW AT WORK**

UNUSUAL PLASTIC MODEL KIT  
 THE KIT CONTAINS MODELS OF FIVE FIGURES, TOOLS

**MiniArt**

UNUSUAL PLASTIC MODEL KIT  
 THE KIT CONTAINS MODELS OF FIVE FIGURES, TOOLS

# Pz.Kpfw.IV Ausf. J Nibelungenwerk. Mid Prod. (Sep-Nov 1944)

PAINTING GUIDE **3** 1. Pz.Rgt. 1.Pz. Div., Hungary, November 1944.

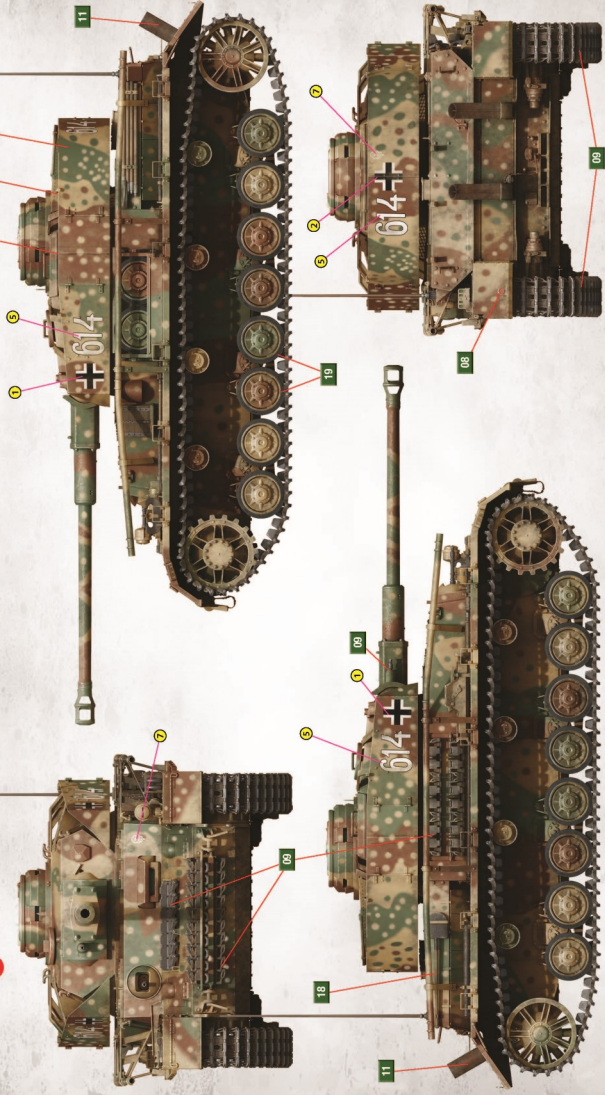

# Pz.Kpfw.IV Ausf. J Nibelungenwerk. Mid Prod. (Sep-Nov 1944)

SCALE  
**1:35**

PAINTING GUIDE **4** 1. Pz.Rgt. 1.Pz. Div., Hungary, November 1944 (with Toma schützen)



# Pz.Kpfw.IV Ausf. J Nibelungenwerk. Mid Prod. (Sep-Nov 1944)

SCALE  
**1:35**

PAINTING GUIDE **5** II./Pz.Rgt.16, 116. Pz. Div., «Windhund», Battle of the Bulge, December 1944



# Pz.Kpfw.IV Ausf. J Nibelungenwerk. Mid Prod. (Sep-Nov 1944)

PAINTING GUIDE **6** Unidentified unit. Winter 1944/1945

