

TAMIYA FS-18SR Engine

EN1

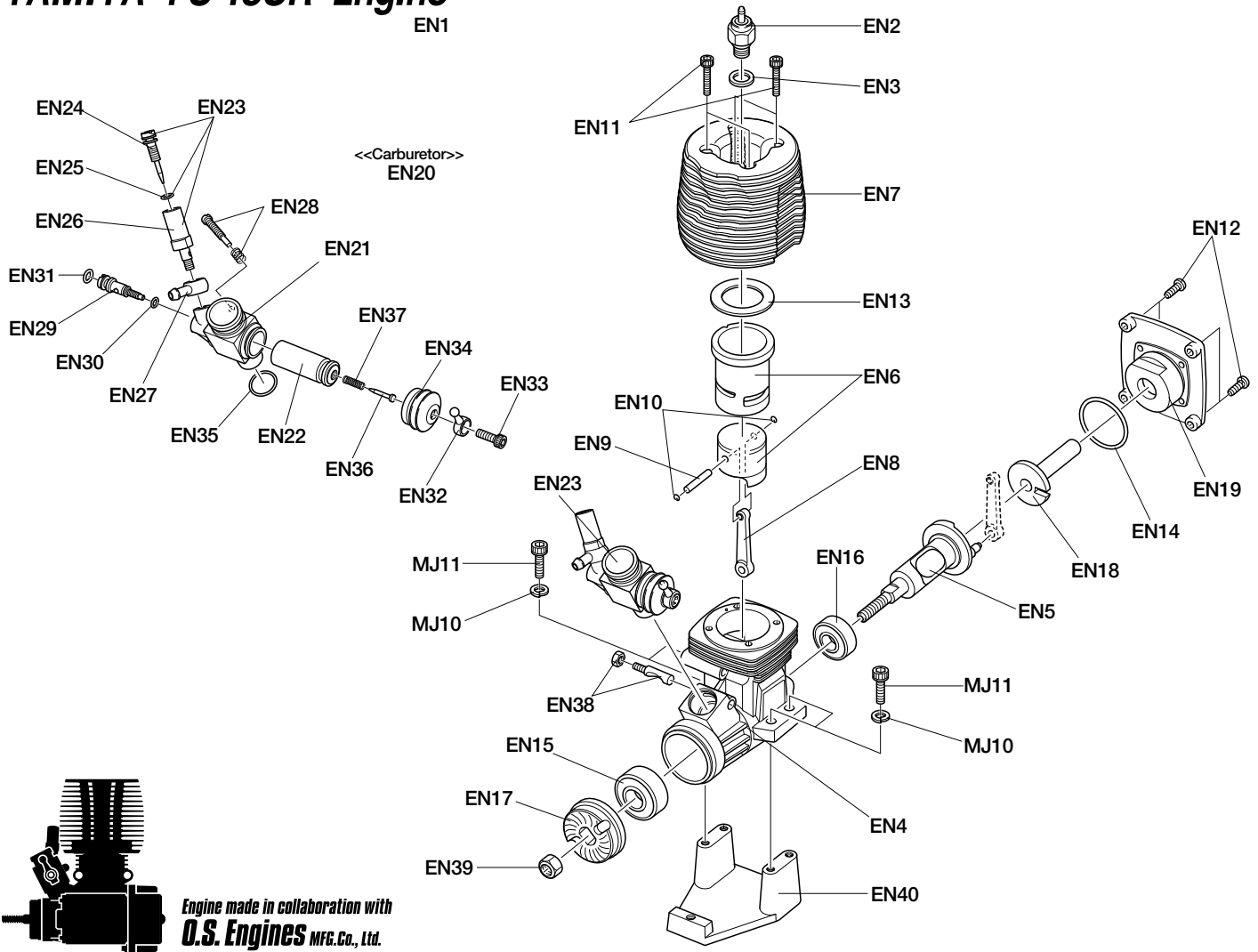

Engine made in collaboration with
O.S. Engines MFG. Co., Ltd.

● Engine

EN1. FS-18SR Engine	7604017	EN22. Slide valve	7684296
EN2. T3 Glow plug / standard ..	7684150	EN23. Needle valve / set	7684297
EN3. Plug washer	7684150	EN24. Needle	7684298
EN4. Crank case	7684282	EN25. O-ring for needle	7684299
EN5. Crank shaft	7684283	EN26. Needle holder	7684300
EN6. Cylinder piston	7684284	EN27. Fuel inlet	7684301
EN7. Heat sink head	7684285	EN28. Throttle stopper spring ..	7684302
EN8. Connecting rod	7684286	EN29. Idle adjustment valve	7684303
EN9. Piston pin	7684287	EN30. O-ring for idle adjustment valve / small	7684304
EN10. Piston pin retainer	7684288	EN31. O-ring for idle adjustment valve / large	7684305
EN11. Cap screw for heat sink ..	7684135	EN32. Ball link	7684306
EN12. Rear adapter screw	7684136	EN33. Screw for ball link	7684307
EN13. Head gasket	7684289	EN34. Dust cover	7684308
EN14. Rear adapter gasket	7684139	EN35. Carburetor gasket	7684309
EN15. Crank shaft bearing / front	7684290	EN36. Metering needle	7684310
EN16. Crank shaft bearing / rear	7684291	EN37. Metering spring	7684311
EN17. Drive washer	7684142	EN38. Carburetor retainer	7684312
EN18. Starting shaft	7684292	EN39. Propeller nut (not used) ..	7684143
EN19. Rear adapter	7684293	EN40. Engine mount	5404006
EN20. Carburetor / Assy.	7684294	MJ11. 3 X 10mm Cap screw	9805612
EN21. Carburetor / body	7684295	MJ10. 3mm Spring washer	50587

