

**Ersatzteilübersicht/Spare parts overview/
Vue d'ensemble des pièces détachées**

I: Tavola dei pezzi di ricambio
NL: Onderdelenlijst
E: Vista general de la pieza de repuesto
P: Vista geral das peças de substituição
DK: Reserveredovisigt
S: Reservdelsoversikt
FIN: Varaosien yleiskuva
N: Oversikt over reservedeler
H: Rõhikatses-ülevaade
CZ: Přehled náhradních dílů
PL: Lista części zamiennych
GR: Αντικαταστήσιμα μέρη
TR: Yedek parçalar listesi
SI: Pregled nadomestnih del
HRV: Pregled zamjenjkih dijelova
SK: Přehľad náhradných dielov
BG: Преглед на резервните части
RO: Privire de ansamblu asupra pieselor de schimb
UA: Перелік запасних частин
EST: Asendusosade ülevaade
LT: Atsarginių dalių apžvalga
LV: Rezerves daļu pārskats
AR: نظرة عامة على قطع الغيار

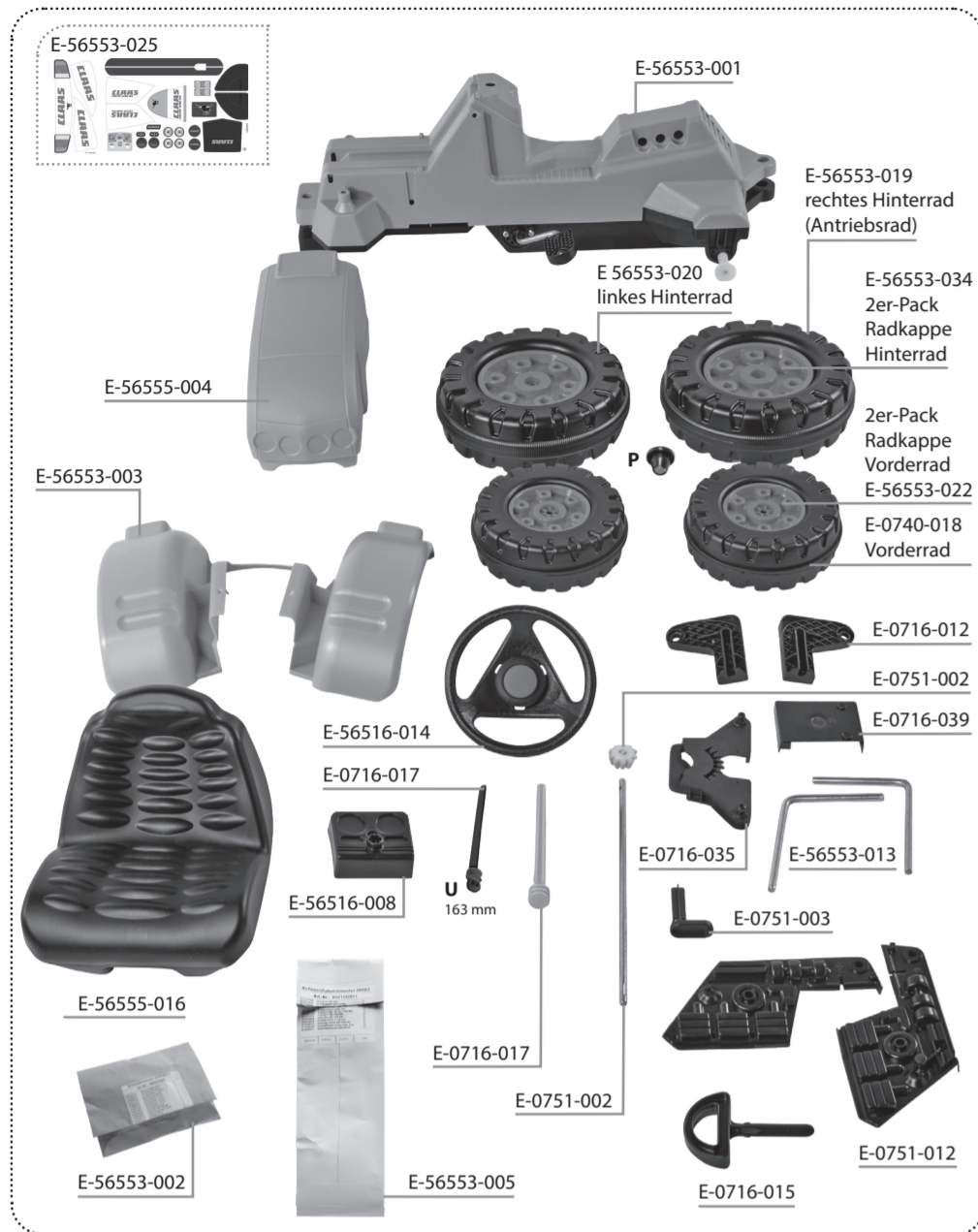

P2/16

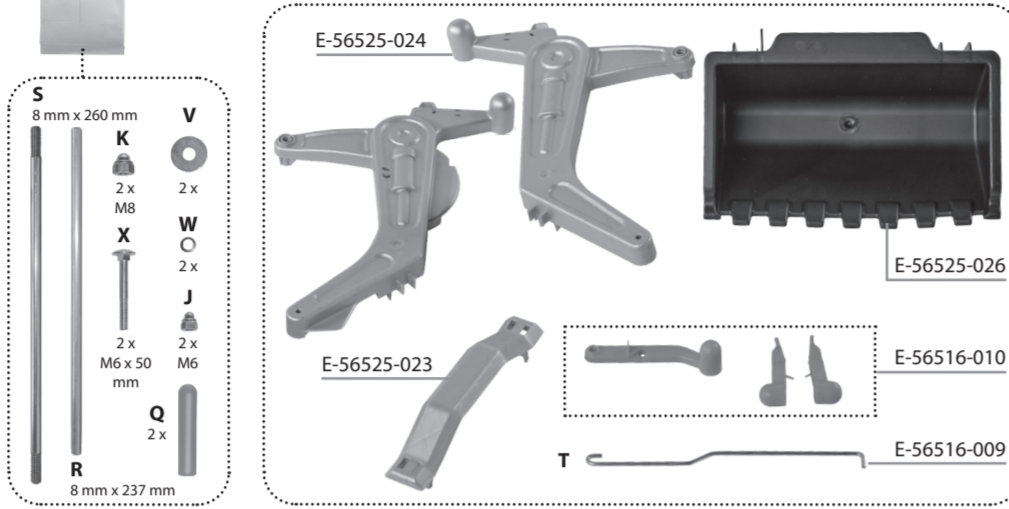
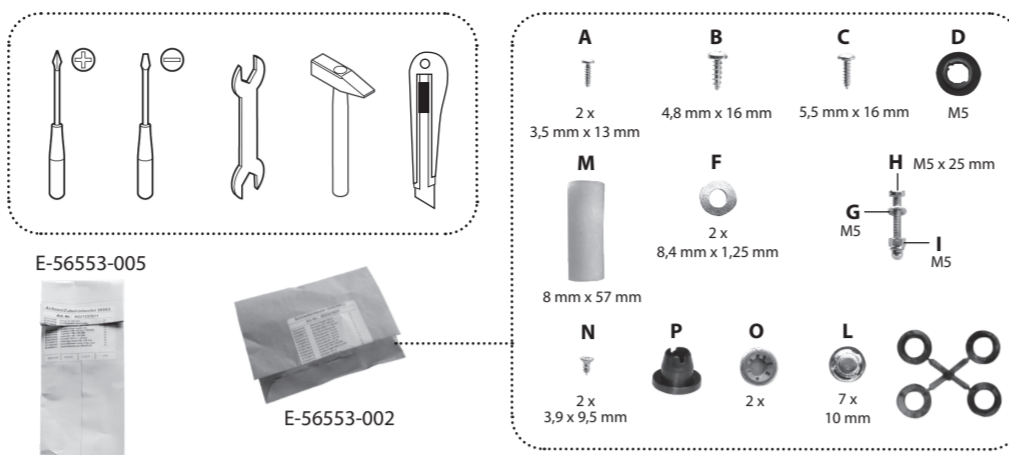

P3/16



P4/16

**Montageanleitung/Assembly instructions/
Instructions de montage**

I: Istruzioni per il montaggio
 NL: Montagehandleiding
 E: Instrucciones de montaje
 DK: Montagevejledning
 S: Monteringsbeskrivning
 FIN: Asennusohje
 N: Monteringsanvisning
 H: Szerelési útmutató
 CZ: Návod k montáži
 PL: Instrukcja montażu
 O: Önyapó utasítás
 TR: Montaj talimatı
 SI: Navodila za montažo
 HRV: Uputa za montažu
 SK: Návod na montáž
 BG: Правилник за монтаж
 RO: Instrucțiunile de montaj
 UA: Керівництво з монтажу
 EST: Kokkupanekujuhend
 LV: Uzstādīšanas instrukcija
 AR: تعليمات تجميع أجزاء التجميع

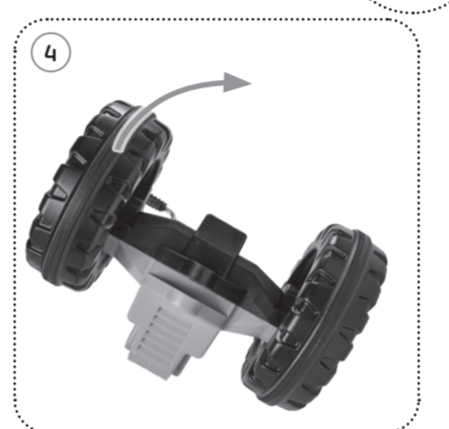
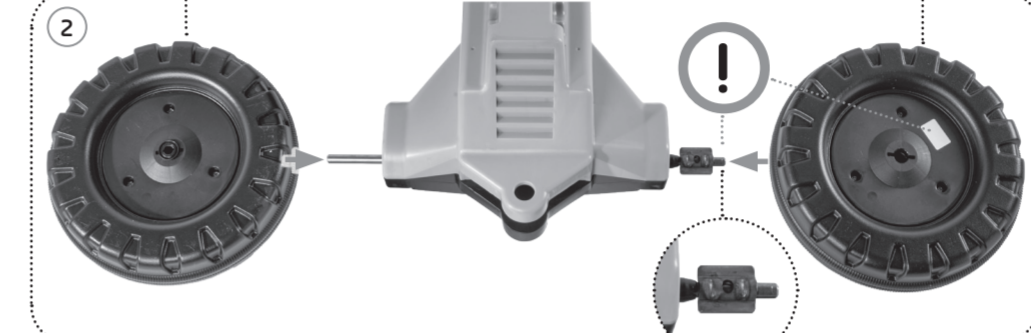

P4/16

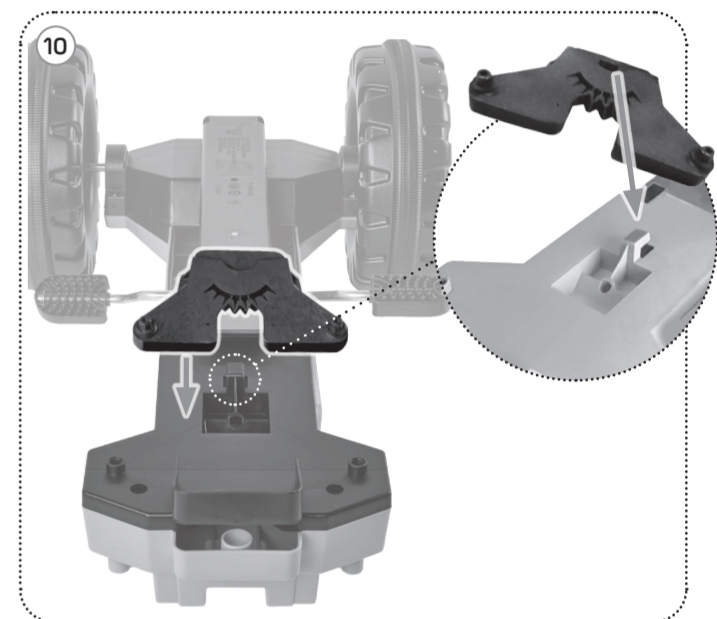
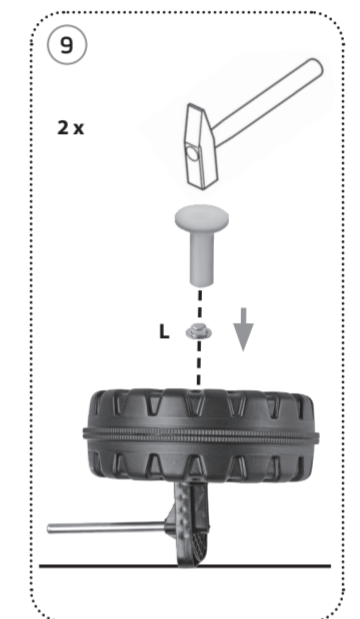
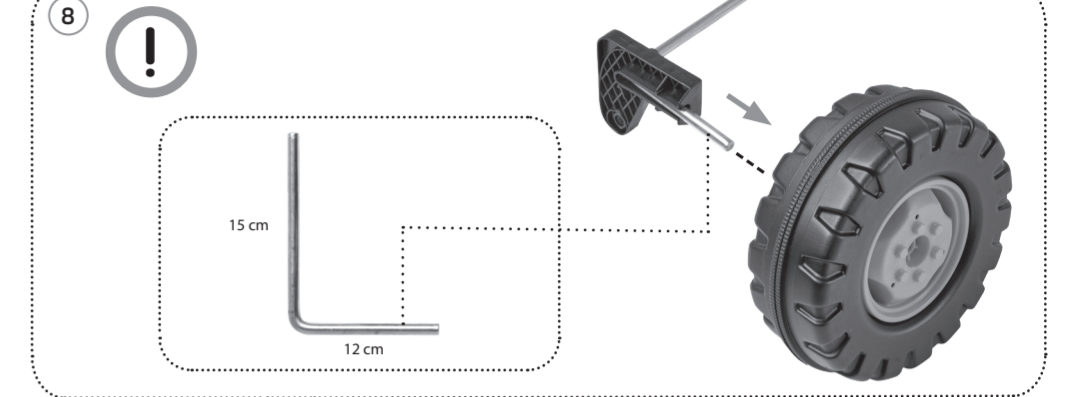
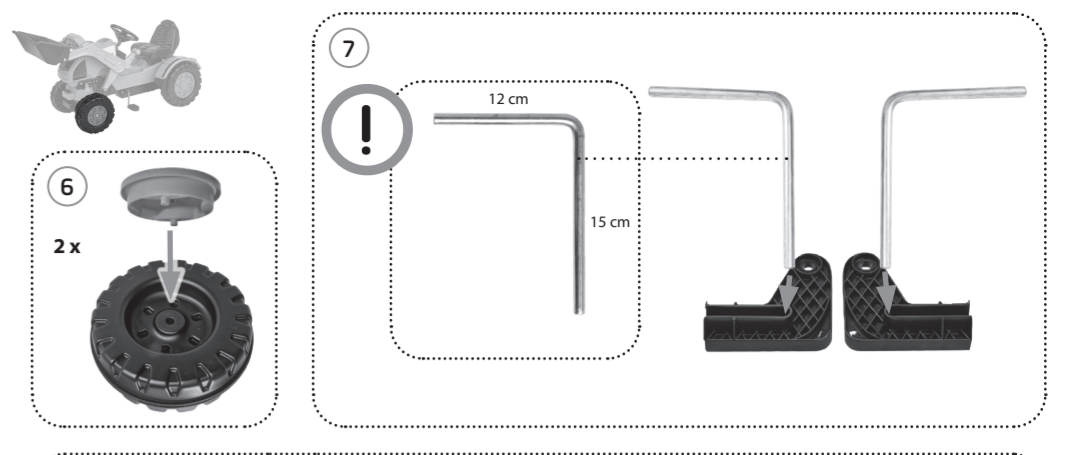

P5/16

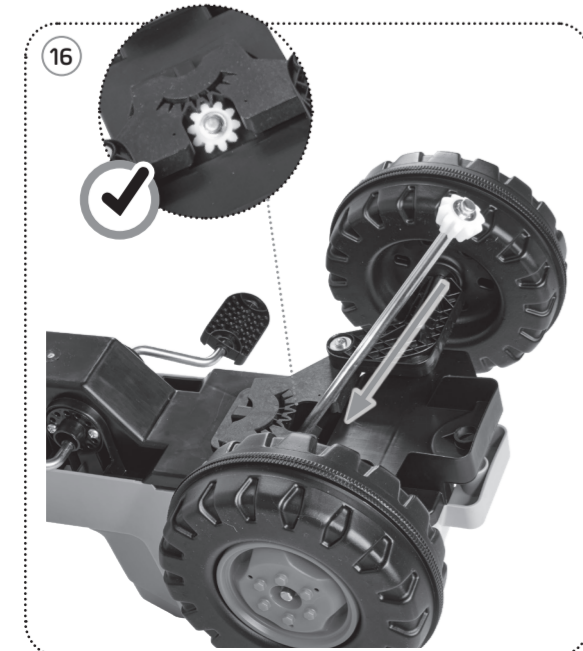
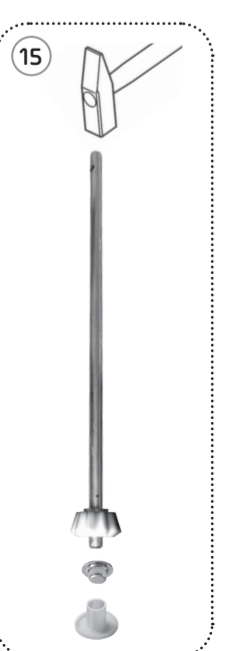
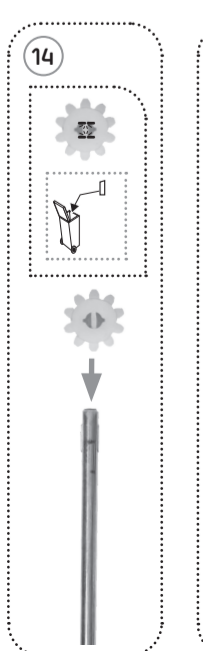
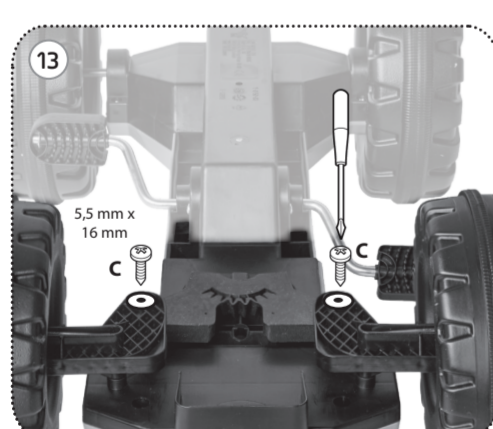
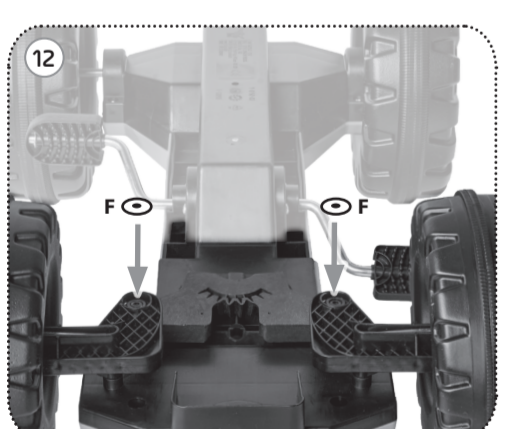
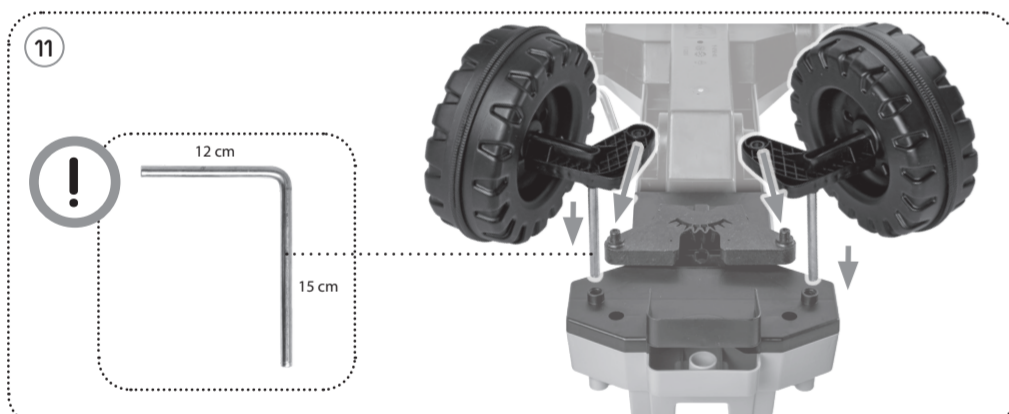

P6/16

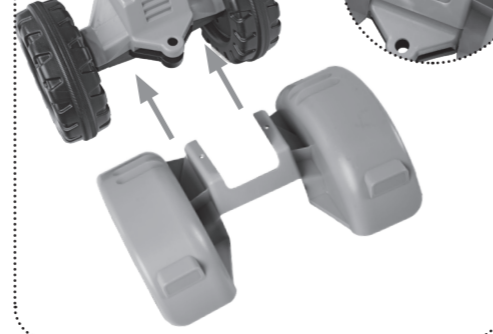
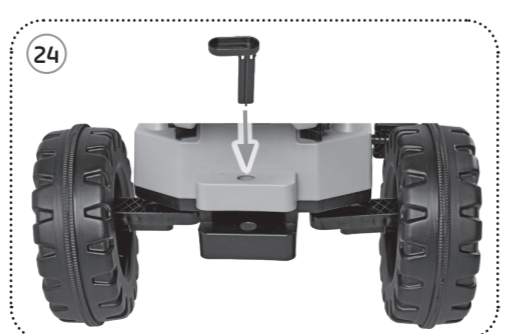
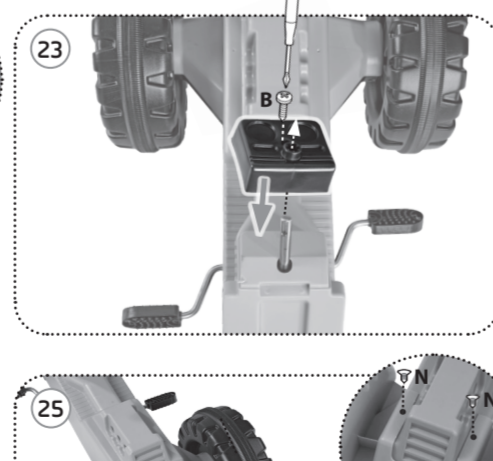
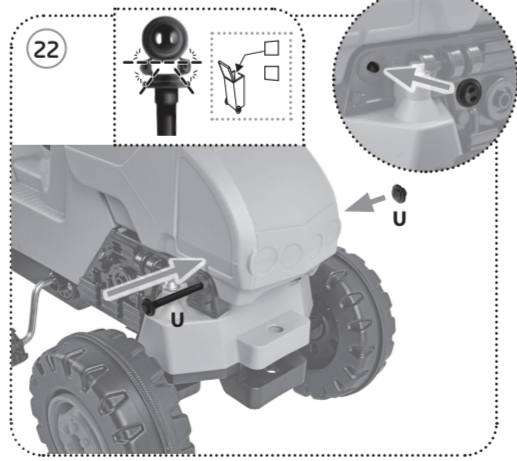
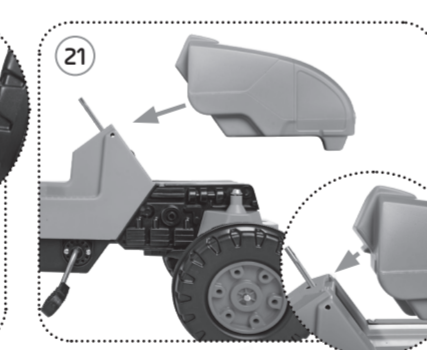
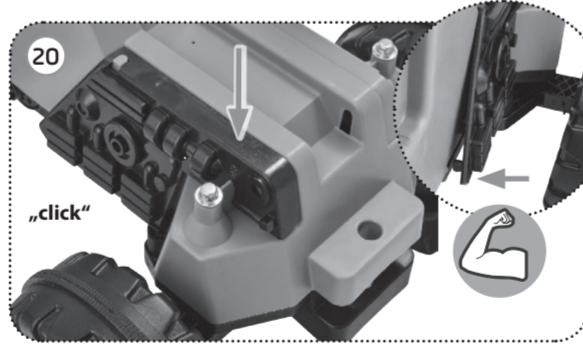
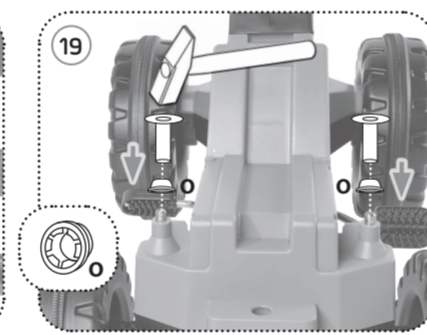
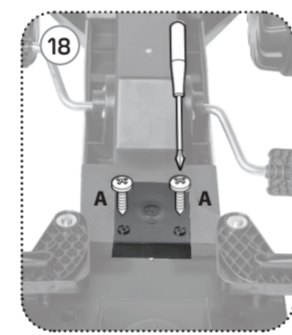
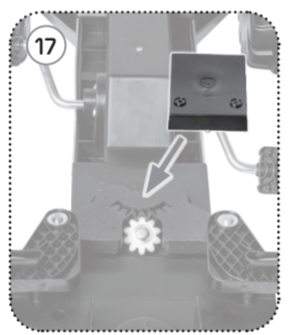

P7/16

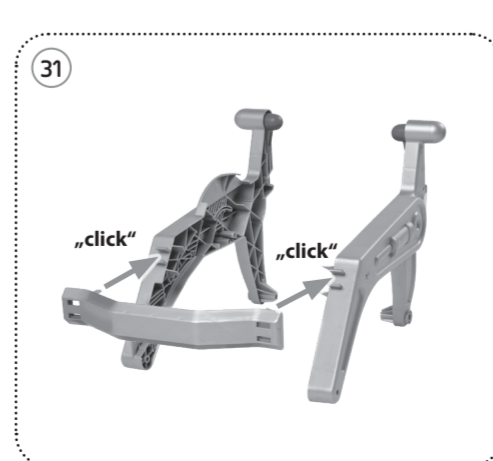
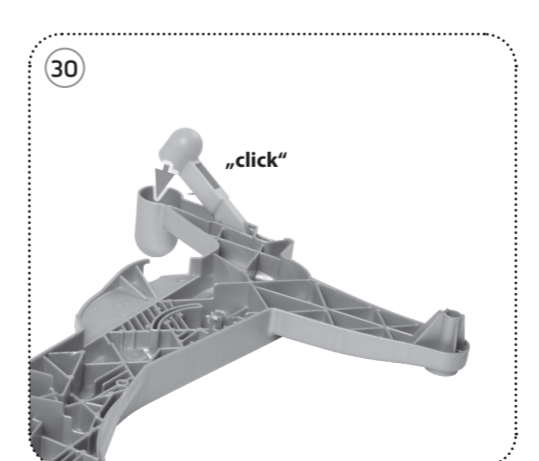
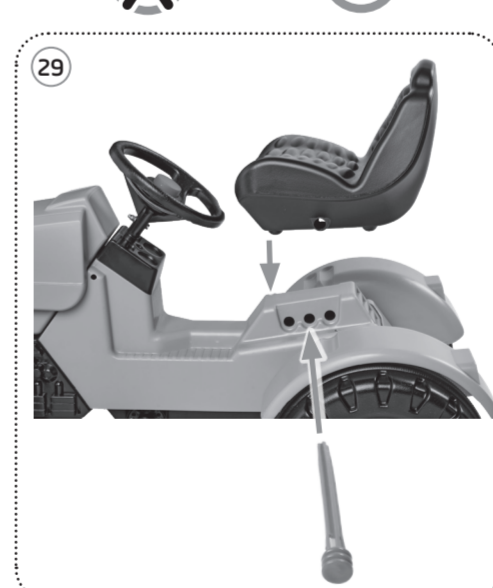
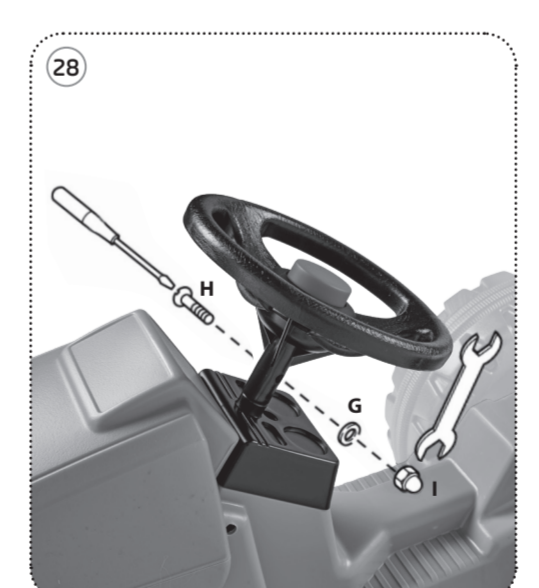
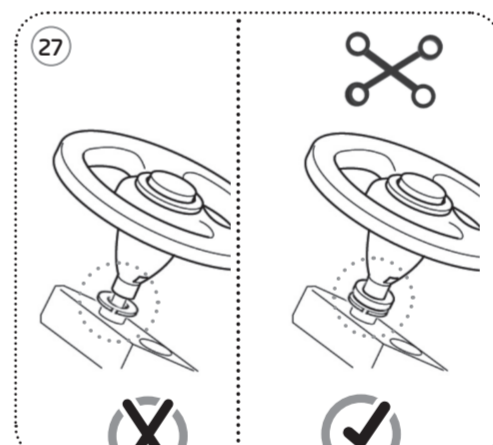
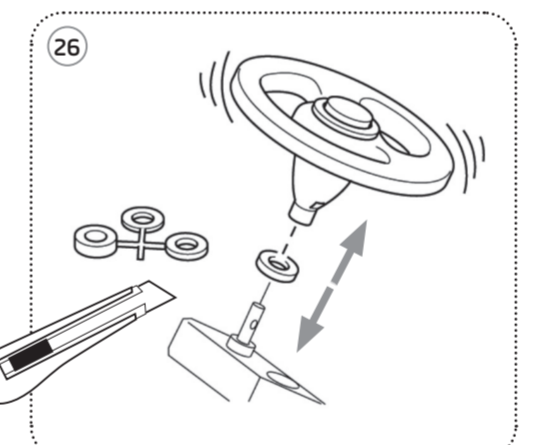

P8/16

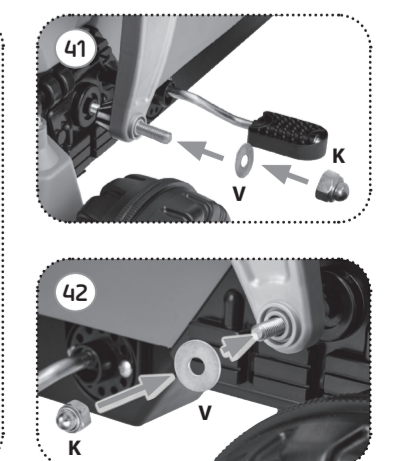
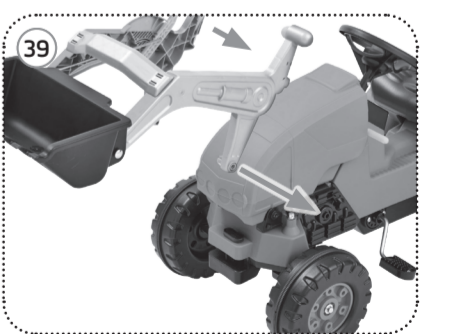
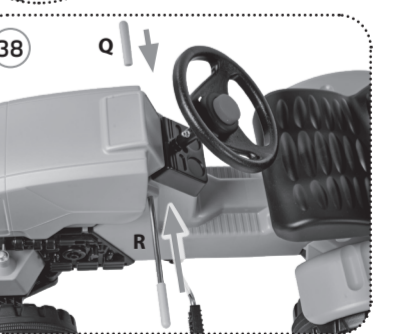
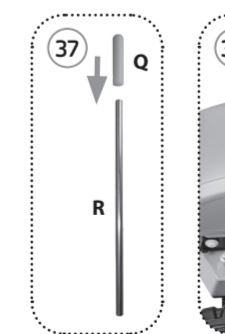
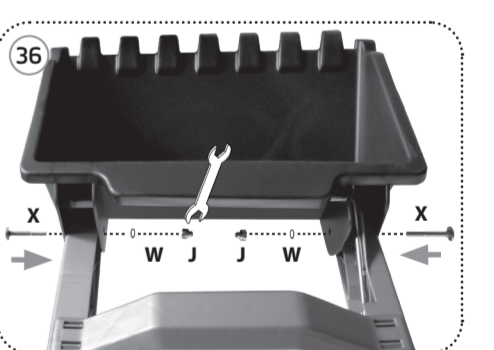
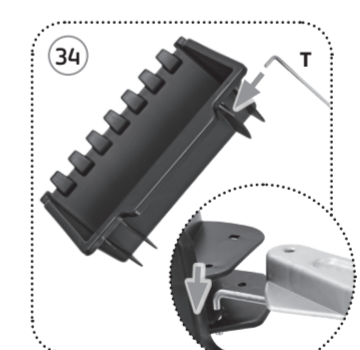
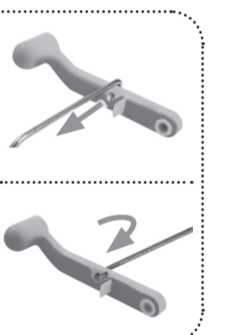
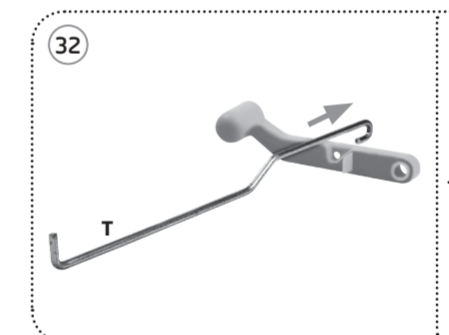

P9/16

